

Heller Boundary Surveys

William B. Heller, L.S. 1202, 863 S. 9th Street, Salina, KS 67401

Cellular: 620-245-8023, Email: willyboskilly@yahoo.com

Certificate of Survey

This is to certify and acknowledge that I, William B. Heller, a registered land surveyor in the County of McPherson, State of Kansas, surveyed the following:

Legal Description Parcel #1: Commencing at the Southwest Corner of Section Twenty-one (21), Township Twenty-one (21) South – Range Three (3) West of the Sixth Principal Meridian; thence North 00 degrees 00 minutes 00 seconds East, 811.26 feet along the West Section Line of said Section Twenty-one (21) to the point of beginning; thence North 00 degrees 00 minutes 00 seconds East, 508.70 feet; thence North 88 degrees 59 minutes 01 seconds East, 991.86 feet; thence South 01 degrees 59 minutes 36 seconds East, 672.64 feet; thence North 89 degrees 27 minutes 56 seconds West, 395.59 feet; thence North 01 degrees 11 minutes 45 seconds West, 134.92 feet; thence North 89 degrees 18 minutes 55 seconds West, 616.76 feet to the point of beginning. Said parcel contains 13.25 acres including existing road right of way. Said parcel is subject to any easements or restrictions of record.

Legal Description Parcel #2: Commencing at the Southeast Corner of Section Twenty-one (21), Township Twenty-one (21) South – Range Three (3) West of the Sixth Principal Meridian; thence North 00 degrees 07 minutes 11 seconds West, 661.70 feet along the East Section Line of said Section Twenty-one (21) to the point of beginning; thence North 00 degrees 07 minutes 11 seconds West, 661.70 feet; thence South 88 degrees 59 minutes 01 seconds West, 3,289.13 feet; thence South 00 degrees 11 minutes 36 seconds East, 658.13 feet; thence North 89 degrees 02 minutes 44 seconds East, 1,046.16 feet; thence North 01 degrees 23 minutes 54 seconds West, 18.95 feet; thence North 88 degrees 37 minutes 48 seconds East, 388.71 feet; thence South 04 degrees 38 minutes 06 seconds East, 21.82 feet; thence North 89 degrees 02 minutes 44 seconds East, 1,852.12 feet to the point of beginning. Said parcel contains 49.6 acres including existing road right of way. Said parcel is subject to any easements or restrictions of record.

Legal Description Parcel #3: Commencing at the Southeast Corner of Section Twenty-one (21), Township Twenty-one (21) South – Range Three (3) West of the Sixth Principal Meridian, the point of beginning; thence North 00 degrees 07 minutes 11 seconds West, 661.70 feet; thence South 89 degrees 02 minutes 44 seconds West, 1,852.12 feet; thence North 04 degrees 38 minutes 06 seconds West, 21.82 feet; thence South 88 degrees 37 minutes 48 seconds West, 388.71 feet; thence South 01 degrees 23 minutes 54 seconds East, 18.95 feet; thence South 89 degrees 02 minutes 44 seconds West, 1,046.16 feet; thence South 00 degrees 11 minutes 36 seconds East, 658.13 feet; thence North 88 degrees 52 minutes 57 seconds East, 616.89 feet; thence North 89 degrees 09 minutes 34 seconds East, 2,670.45 feet to the point of beginning. Said parcel contains 49.9 acres including existing road right of way. Said parcel is subject to any easements or restrictions of record.

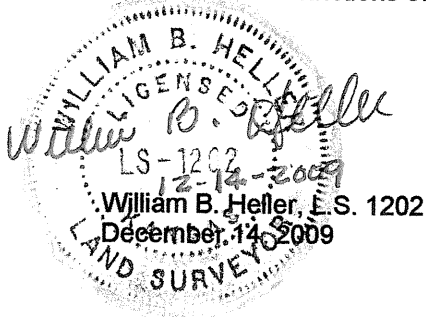

For: Beau D. Froese
214 14th Avenue
Inman, KS 67546