

NE Cor. NE 1/4
Sec. 9, T21S, R5W
Fd. 1/2" Rebar LS 1297 (PS2)
Origin: LS 1297

Fd. 1/2" Rebar
0.45 S and 0.63 E
of Calculated Location
Origin: LS 586

—Fd. 1/2" Rebar LS 1297 Cap
0.38 S and 0.73 East
of Calculated Location

N 89°32'27" E 525.00 (R)(PS1)(C)

90°05'00" (PS1)(C)

N 89°27'27" E 383.17 (C)

5.471 Acres

✓ Fd. 1/2" Rebar
0.50 N and 1.07 E
of Calculated Location
(Unknown Origin)

Fd. 1/2" Rebar
0.80 N and 24.44 W
of Calculated Location
(Unknown Origin)

Existing Parcel
(BK. 627, Pg. 706)
(3.00 Acres)

isting Parcel
27, Pg. 707)

Fd. 1/2" Rebar
0.43 N and 0.16 E
of Calculated Location
(Unknown Origin)

S 89°27'27" W 383.17 (C)

-P.O.B.

—Fd. 1/2" Rebar (PS1)
0.95 N and 1.20 E
of Calculated Location
Origin: LS 586

South Line NE 1/4 as Per (PS1)

S 89°33'45" W 525.00 (R)(PS1)(C)

SE Cor. NE 1/4
Sec. 9, T21S, R5W
Fd. 5/8" Rebar (PS2)
Origin: LS 586

-P.O.C.

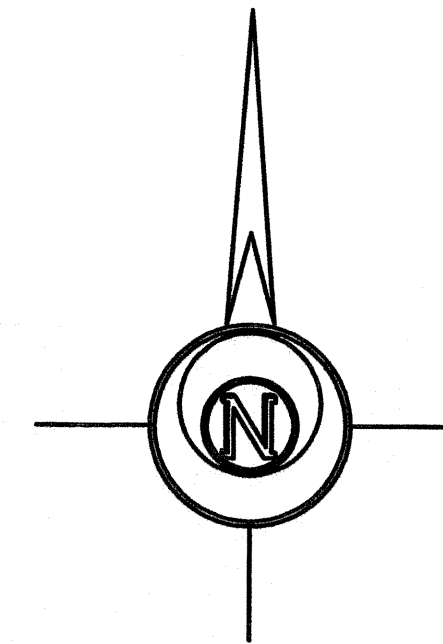

-100 0 100 200 300

BASIS OF BEARING = KANSAS STATE PLANE GRID

△ - Sectional Monument Found
 ○ - Survey Monument Found
 ● - 5/8" x 24" Iron Rebar Set w/G.S.S. Cap
 (C) - Calculated
 (M) - Measured
 (PS1) - Previous Survey by LS 586 Dated 8/12/1976
 (PS2) - Previous Survey by LS 1297 Dated 8/17/2011
 (R) - Record Measurement
 P.O.B. - Point of Beginning
 P.O.C. - Point of Commencement

A portion of the Northeast Quarter of Section 9, Township 21 South, Range 5 West of the 6th Principal Meridian, McPherson County, Kansas more particularly described as follows:

Commencing at the Southeast Corner of the Northeast Quarter of Section 9, Township 21 South, Range 5 West of the 6th Principal Meridian; thence with a Kansas State Plane Grid bearing North 00°32'33" West along the East line of said Northeast Quarter 326.00 feet for the point of beginning; thence South 89°27'27" West perpendicular to the East line of said Northeast Quarter 383.17 feet; thence North 00°32'33" West parallel with the East line of said Northeast Quarter 622.00 feet; thence North 89°27'27" East perpendicular to the East line of said Northeast Quarter 383.17 feet to said East line; thence South 00°32'33" East along said East line 622.00 feet to the point of beginning containing **5.471 Acres**, subject to a road right-of-way easement across the East 33.00 feet thereof and any other easements of record.

I hereby certify this plat to be a true, correct and complete representation of the property described hereon, as surveyed under my supervision, this 30th day of July, 2012.

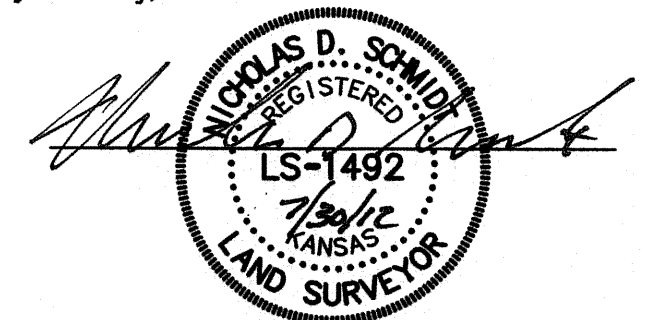

FIRST BANK KANSAS

Description:
A PORTION OF THE NE 1/4 OF
SEC. 9, T21S, R5W
MCPHERSON COUNTY, KANSAS

Garber Surveying Service, P.A.

**115 East Marlin Suite 102
McPherson, Kansas 67460**

Phone (620) 665-7032 • FAX (620) 663-7401 Phone (620) 241-4441 • FAX (620) 241-4458

KLL

KLL **Scale: 1"=100'**

Date of Field Work: July 24, 2012

Job No:

NDS

Date: 07/30/2012

Sheet 1 of 1 Sheet(s)

G2012-441