

Saved 3/24/2015 11:54:18 AM by NSCHMDT
Plot Date & Time Wednesday, March 25, 2015 12:12:22 PM Dwg Path C:\Users\inschmidt\Documents\GSS Projects\2015\145M\20150145 AUTO S GND_NDS Edit 2015-03-24

3RD AVENUE

N 00°05'44" W 2655.04 (M) 2655.38 (PS) 2655.05 (PS2)

NW Cor. NW 1/4
Sec. 34, T21S, R5W
Fd. 1/2" Rebar
Origin: County Ref. Ties
by GSS (12/21/2002)

SW Cor. NW 1/4
Sec. 34, T21S, R5W
Fd. 5/8" Rebar
Origin: County Ref. Ties
by GSS (12/21/2002)

2058.69 (M)

S 89°37'49" W 2646.48 (M) 2645.83 (PS)

S 89°37'49" W 587.80 (M)(R)

SE Cor. NW 1/4
Sec. 34, T21S, R5W
Fd. 5/8" Rebar
Origin: (PS)

ARAPAHO ROAD

S 89°36'16" W 2640.35 (PS) 2640.71 (M)
660.20 (M) 660.09 (PS)

24.75 (PS)
24.92 (M)

P.O.C.

NE Cor. NW 1/4
Sec. 34, T21S, R5W
Excavated for Original Stone
from Reference Tie Card - Not Found
Reset From (PS)
Fd. 1/2" Rbr w/ LS 1202
Cap 6.98 S B.41 E
(Not Accepted-See Notes)

1328.65 (PS)
1328.58 (C)

1664.25 (PS)
1664.05 (M)

335.60 (PS)
335.47 (C)

S 00°13'12" E 2656.21 (M) 2657.30 (PS)

S 00°13'12" E 992.16 (M) 993.05 (R)

Existing Parcel From (PS)

N 89°37'00" E 587.95 (M) 587.80 (PS)

P.O.B.

13.389 Acres

Bk. 238 Pg. 092

LEGEND

- △ - Sectional Monument Found
- - Survey Monument Found 5/8" Rebar From (PS)
- - 5/8" x 24" Iron Rebar Set w/G.S.S. Cap
- (C) - Calculated
- (M) - Measured
- (R) - Record measurement
- P.O.B. - Point of Beginning
- P.O.C. - Point of Commencement
- (PS) - Previous Survey Durr LS #697 (6/01/1984)
- (PS1) - Previous Survey Heller LS #1202 (9/16/2008)
- (PS2) - Previous Survey Garber LS #683 (12/24/2012)

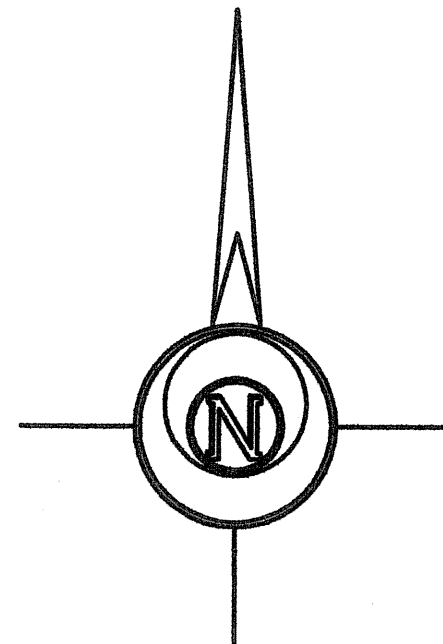

-100 0 100 200 300

BASIS OF BEARING = NAD 83 KANSAS ZONE 1502

DESCRIPTION OF RECORD:

A tract of land commencing at the Northwest corner of the Northwest Quarter of Section 34, Township 21 South, Range 5 West of the 6th Principal Meridian; thence South for 1664.24 feet to the point of beginning; thence continuing South for 993.05 feet thence West of 587.80 feet; thence North 993.24 feet; thence East for 587.80 feet to the point of beginning.

SURVEY DESCRIPTION:

A portion of the Northwest Quarter of Section 34, Township 21 South, Range 5 West of the 6th Principal Meridian, McPherson County, Kansas described as follows:

Commencing at the Northeast corner of said Northwest Quarter; thence on a NAD 83 Kansas Zone 1502 bearing South 00°13'12" East on the East line of said Northwest Quarter a distance of 1664.05 feet (1664.24 Record) to the point of beginning; thence continuing South 00°13'12" East on said East line a distance of 992.16 feet (993.05 Record) to the Southeast corner of said Northwest Quarter; thence South 89°37'49" West on the South line of said Northwest Quarter a distance of 587.80 feet (Record); thence North 00°13'46" West a distance of 992.01 feet (993.24 Record); thence North 89°37'00" East a distance of 587.95 feet (587.80 Record) to the point of beginning.

Containing 13.389 Acres and subject to any easements or restrictions of record.

SURVEYOR'S NOTES:

The only reference ties on file for the N 1/4 corner at McPherson County or KSHS are for the monument set by Heller (PS1). However, Durr (PS) had record in his file from (PS) of a copy of the reference tie card which referenced the location of a stone. Durr did not find that stone, but did reestablish the position of that corner from those references. With that information, I accepted the position of the N 1/4 corner as shown on survey drawing for (PS).

SURVEYOR'S CERTIFICATE:

I hereby certify this plat to be a true, correct and complete representation of the property described hereon, as surveyed under my supervision, this 25th day of March, 2015.

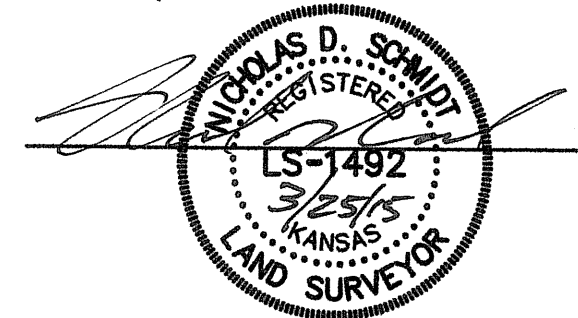

Prepared For:		Description:	
WILLIAM ROBINSON		A PORTION OF THE NW 1/4 SECTION 34, T21S, R5W McPHERSON COUNTY, KANSAS	
Prepared By:		Garber Surveying Service, P.A.	
GSS		HUTCHINSON (Main Office) 2908 North Plum St. 67502 Ph. 620-665-7032 Fax 620-663-7401 McPHERSON (Branch Office) 115 East Marlin 67460 Ph. 620-241-4441 Fax 620-241-4458 NEWTON (Branch Office) 511 North Poplar St. 67114 Ph. 316-283-5053 Fax 316-283-5073	
Drawn By: SLW	Scale: 1"=100'	Date of Field Work: March 11, 2015	Job No:
Checked By: NDS	Date: 3/25/2015	Sheet 1 of 1 Sheet(s)	G2015-145

Revised 3/25/2015