

 Scale: 1" = 200'

 1st Avenue

 2,640.0' (G.L.O.)

 2,651.26'

 (assumed bearing)

 50°20'08"E

Heller Boundary Surveys
William B. Heller, L.S. 1262
406 N. Kansas Ave.
Canton, KS 67428
Cell Ph: 620-245-8023

Legend

- ▲ = Section Corner Monument
- = $\frac{1}{2}$ " x 24" rebar in I.D. cap set
- P.O.B. = Point of Beginning
- § = Section Line
- PL = Property Line
- G.L.O. = General Land Office
- R/W = Public Road Right of Way

Date: September 22, 2014

For: The Donna M. Lackey
Living Trust, C/O
Karen Fast
4432 S.W. Deer Run St.
Topeka, KS 66610

W. 1/4 Cor., Sec. 17, T21S-R4W
Found: 5/8" rebar
Origin: unknown Note

Note: All distances are calculated/measured distances.

Pg. 2/2

Heller Boundary Surveys

William B. Heller, L.S. 1202 ~ 406 N. Kansas, Canton, KS 67428

Cellular: 1-620-245-8023 ~ E-mail: willyboskilly@yahoo.com

Certificate of Survey

This is to certify and acknowledge that I, William B. Heller, a registered land surveyor in the County of McPherson, State of Kansas, surveyed the legal description found below on this certificate of survey.

Legal Description 5.0 Acre Parcel:

A parcel in The Northwest One Quarter (1/4) of Section Seventeen (17), Township Twenty-one (21) South, Range Five (5) West of the Sixth Principal Meridian described as follows:

Commencing at the Northwest Corner of said Section Seventeen (17), T21S-R5W; thence South 00 degrees 20 minutes 08 seconds East along the West Section Line of said Section Seventeen (17), 892.04 feet to the point of beginning; thence South 89 degrees 44 minutes 46 seconds East, 499.70 feet; thence South 00 degrees 20 minutes 08 seconds East, 466.68 feet; thence North 89 degrees 44 minutes 46 seconds West, 499.70 feet; thence North 00 degrees 20 minutes 08 seconds West, 466.68 feet to the point of beginning. Said parcel contains 5.35 acres including right of way. Said parcel is subject to any easements or restrictions of record.

Legal Description 10.0 Acre Parcel:

A parcel in The Northwest One Quarter (1/4) of Section Seventeen (17), Township Twenty-one (21) South, Range Five (5) West of the Sixth Principal Meridian described as follows:

Commencing at the Northwest Corner of said Section Seventeen (17), T21S-R5W; thence South 00 degrees 20 minutes 08 seconds East along the West Section Line of said Section Seventeen (17), 892.04 feet to the point of beginning; thence South 89 degrees 44 minutes 46 seconds East, 693.00 feet; thence South 00 degrees 20 minutes 08 seconds East, 660.00 feet; thence North 89 degrees 44 minutes 46 seconds West, 693.00 feet; thence North 00 degrees 20 minutes 08 seconds West, 660.00 feet to the point of beginning. Said parcel contains 10.5 acres including right of way. Said parcel is subject to any easements or restrictions of record.

William B. Heller, L.S. 1202
September 22, 2014

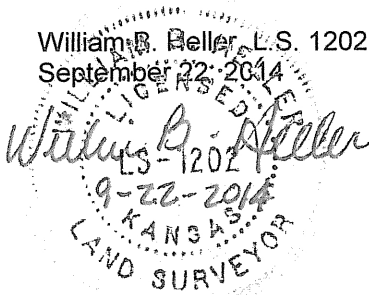

For: The Donna M. Lackey Living Trust
c/o Karen Fast
4432 S.W. Deer Run St
Topeka, KS 66610

Report of Survey

Research of the records of McPherson County Courthouse and Public Works Office revealed the following information:

Surveys: G.L.O. subdivisions by Abraham Ray, dated August 13th thru 23rd, 1861. Surveys and section corner references found at the McPherson County Public Works Department Records Vault.

Road origins: 2nd Avenue is 33 feet on each side of the section line. Pawnee Road is 30 feet on each side of section line. The 5.35 acre parcel contains 0.35 acre in the road right of way. The 10.5 acre parcel contains 0.5 acre in the road right of way.

Field procedure: Static G.P.S. observation performed with Ashtech Static Receivers. Distances and angles read with a DTM 521 Nikon Total Station