

▲ - Section Monument Found
 - Section Monument Set (5/8" x 24" Iron Rebar w/GSS CLS 52 Cap)
 ● - 5/8" x 24" Iron Rebar Set w/GSS CLS 52 Cap
 (C) - Calculated
 (M) - Measured
 (PS) - Previous Survey By LS 1202, 3/21/2015
 P.O.B. - Point of Beginning
 P.O.C. - Point of Commencement

A portion of the West Half of the Southwest Quarter of Section 1, Township 21 South, Range 5 West of the 6th Principal Meridian, McPherson County, Kansas, described as follows by Nicholas D. Schmidt, PS #1492, this 13th day of July, 2022:

Commencing at the Southwest corner of said Southwest Quarter; thence on a NAD 83 Kansas South Zone bearing of South 89°09'48" East on the South line of said Southwest Quarter a distance of 955.75 feet to the point of beginning; thence North 00°50'08" West a distance of 767.86 feet; thence South 88°03'49" West a distance of 211.75 feet; thence North 01°08'36" East a distance of 375.64 feet; thence South 89°51'58" East a distance of 9.27 feet; thence North 03°52'43" West a distance of 154.45 feet; thence South 89°09'50" East a distance of 562.50 feet to the East line of the West Half of said Southwest Quarter; thence South 00°07'04" East on said East line a distance of 437.00 feet; thence South 89°51'28" West a distance of 34.47 feet; thence South 02°57'49" West a distance of 77.66 feet; thence North 89°33'02" West a distance of 151.18 feet; thence North 00°20'46" East a distance of 69.25 feet; thence North 85°45'51" West a distance of 139.33 feet; thence South 00°50'05" East a distance of 848.67 feet to said South line; thence North 89°09'48" West on said South line a distance of 31.01 feet to the point of beginning.

Containing **6.96 Acres** and subject to road a right of way easement along the South line thereof, and any other easements or restrictions of record.

I hereby certify this plat to be a true, correct and complete representation of the property described hereon, as surveyed under my supervision, this 13th day of July, 2022.

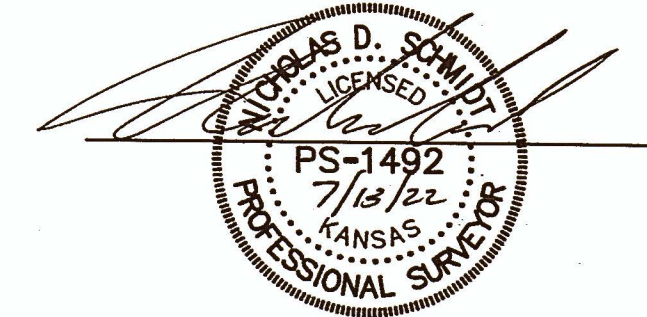

Prepared For:		Description:	
WAYNE REGEHR		A PORTION OF THE SW 1/4 SECTION 1, T21S, R5W McPHERSON COUNTY, KANSAS	
Prepared By:		Garber Surveying Service, P.A.	
 HUTCHINSON 2908 North Plum St. 67502 Ph. 620-665-7352 (Main Office)		BRANCH OFFICES: MANHATTAN Ph. 785-320-4810 MCPHERSON Ph. 620-241-4441 NEWTON Ph. 316-283-5053 SALINA Ph. 785-404-6302 WICHITA Ph. 316-260-9933	
Drawn By: KDZ	Scale: 1"=100'	Date of Field Work: July 8, 2022	Job No:
Checked By: NDS	Date: 07/13/2022	Sheet 1 of 1 Sheet(s)	G2022-468