

EXHIBIT 'A'

VACATE PORTION OF ARAPAHO ROAD:

A STRIP OF LAND DEDICATED FOR ARAPAHO ROAD RIGHT OF WAY BEING 80 FEET WIDE, SITUATED IN THE SOUTHWEST QUARTER OF SECTION 30 AND THE NORTHWEST QUARTER OF SECTION 31, TOWNSHIP 21 SOUTH, RANGE 4 WEST AND IN THE NORTHEAST QUARTER OF SECTION 36 AND THE SOUTHEAST QUARTER OF SECTION 25, TOWNSHIP 21 SOUTH, RANGE 5 WEST OF THE 6TH PRINCIPAL MERIDIAN, MCPHERSON COUNTY, KANSAS, SAID STRIP OF LAND BEING 40 FEET EACH SIDE OF SECTION LINES AND MORE PARTICULARLY DESCRIBED AS FOLLOWS:

BEGINNING AT THE INTERSECTION OF THE SOUTHERLY RIGHT OF WAY LINE OF SAID ARAPAHO ROAD (80 FEET WIDE) WITH THE COMMON SECTION LINE BEING THE EAST LINE OF THE SAID NORTHEAST QUARTER OF SECTION 36 AND THE WEST LINE OF THE SAID NORTHWEST QUARTER OF SECTION 31, SAID POINT BEING 33 FEET SOUTHERLY FROM A FOUND 5/8" REBAR MARKING THE COMMON SECTION CORNER OF AFOREMENTIONED SECTIONS 30, 31, 36, AND 25;

THENCE DEPARTING FROM THE SAID COMMON SECTION LINE ALONG THE SAID SOUTHERLY RIGHT OF WAY LINE NORTH 89°44'25" WEST A DISTANCE OF 707.55 FEET TO THE INTERSECTION OF SAID SOUTHERLY RIGHT OF WAY LINE WITH THE NORTHWESTERLY RIGHT OF WAY LINE OF K-61 HIGHWAY PER K.D.O.T. PROJECT NO. 61-59 K-8253-01 LAST REVISION DATE NOV. 10, 2011 VOL 3;

THENCE DEPARTING FROM SAID SOUTHERLY RIGHT OF WAY LINE ALONG SAID NORTHWESTERLY RIGHT OF WAY LINE NORTH 39°15'56" EAST A DISTANCE OF 102.95 FEET TO THE INTERSECTION OF SAID NORTHWESTERLY RIGHT OF WAY LINE WITH THE NORTHERLY RIGHT OF WAY LINE OF AFOREMENTIONED ARAPAHO ROAD (80 FEET WIDE);

THENCE DEPARTING FROM SAID NORTHWESTERLY RIGHT OF WAY LINE ALONG SAID NORTHERLY RIGHT OF WAY LINE SOUTH 89°44'25" EAST A DISTANCE OF 641.97 FEET TO THE COMMON SECTION LINE BEING THE EAST LINE OF THE AFOREMENTIONED SOUTHEAST QUARTER OF SECTION 25 AND THE WEST LINE OF THE AFOREMENTIONED SOUTHWEST QUARTER OF SECTION 30, SAID POINT BEING 40 FEET EASTERLY FROM AFOREMENTIONED FOUND 5/8" REBAR MARKING THE AFOREMENTIONED COMMON SECTION CORNERS;

THENCE DEPARTING FROM SAID COMMON SECTION LINE CONTINUING ALONG SAID NORTHERLY RIGHT OF WAY LINE NORTH 89°08'30" EAST A DISTANCE OF 1,354.56 FEET TO THE INTERSECTION OF SAID NORTHERLY RIGHT OF WAY LINE WITH THE WESTERLY LINE OF LAND CONVEYED TO THE SECRETARY OF TRANSPORTATION OF THE STATE OF KANSAS EXTENDED NORTHERLY, AS SAID LINE IS DESCRIBED IN THE "SEVENTEENTH COURSE" OF CORPORATION WARRANTY DEED TO SAID PARTY DATED SEPTEMBER 5, 2008;

THENCE DEPARTING FROM THE SAID NORTHERLY RIGHT OF WAY LINE ALONG THE SAID WESTERLY LINE AND ITS NORTHERLY EXTENTION OF LAND CONVEYED TO THE SECRETARY OF TRANSPORTATION OF THE STATE OF KANSAS SOUTH 00°51'31" WEST A DISTANCE OF 80.00 FEET TO THE INTERSECTION OF SAID WESTERLY LINE WITH THE AFOREMENTIONED SOUTHERLY RIGHT OF WAY LINE OF ARAPAHO ROAD (80 FEET WIDE);

THENCE DEPARTING SAID WESTERLY LINE ALONG THE SAID SOUTHERLY RIGHT OF WAY LINE SOUTH 89°08'30" WEST A DISTANCE OF 1,355.34 FEET TO THE POINT OF BEGINNING.

SAID TRACT OF LAND CONTAINING 3.73 ACRES OR 162,377 SQUARE FEET, MORE OR LESS.

NOTES:

1. THE BASIS OF BEARINGS FOR THIS SURVEY IS THE KANSAS STATE COORDINATE SYSTEM, SOUTH ZONE (1502), BASED UPON GPS MEASUREMENTS. ALL DISTANCES AND AREAS SHOWN HEREON ARE MEASURED ON THE GROUND USING U.S. SURVEY FEET AND CAN BE CONVERTED TO GRID VALUES BY MULTIPLYING BY A COMBINED SCALE FACTOR OF 0.99987815.

P220090-MEDORA

SURVWEST

720.259.9916
www.survwest.com

6501 E Bellview Ave, Suite 300
Englewood, CO 80111

SURVEY-MAPPING
UTILITY-ENGINEERING
REAL ESTATE

VACATE PORTION OF ARAPAHO RD
MCPHERSON COUNTY, STATE OF KANSAS

AN EXHIBIT OF EVEN DATE ACCOMPANIES
THIS METES AND BOUNDS DESCRIPTION.

PAGE 1 OF 1

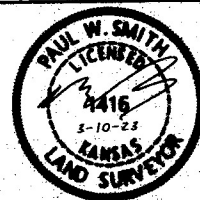

EXHIBIT 'B'

Map Labels:

- N 1/2 NE 1/4 SEC. 36 T21S, R5W
- SE 1/4 SEC. 25 T21S, R5W
- SW 1/4 SEC. 30 T21S, R4W
- ARAPAHO RD. (EXISTING)
- K-61 HIGHWAY (VARIABLE WIDTH ROW)
- UPRR ROW / K-61 ROW
- UPRR ROW
- 6TH AVENUE (FORMER)
- 6TH AVENUE (EXISTING) VARIABLE WIDTH ROW PER AC 645 PG. 8098
- JAES REEGER
- ARAPAHO ROAD (EXISTING) VARIABLE WIDTH ROW PER AC 645 PG. 8098
- WESTERN ROW LINE 6TH AVE
- NORTHERLY ROW LINE ARAPAHO RD.
- ARAPAHO ROAD (FORMER)

Subject Portion of Vacated Arapaho Rd.
3.73 ACRES± OR 162,377 SQ.FT.±

Key Features and Measurements:

- S. 1/4 COR. SEC. 25 N. 1/4 COR. SEC. 36 T. 21 S., R. 5 W. FD. 1" IRON PIPE
- N89°42'25"W 2,642.08'
- N39°15'56"E 102.95'
- S89°44'25"E 641.97'
- 707.55'
- N89°44'25"W
- P.O.B. INTERSECTION OF SOUTH LINE OF ARAPAHO ROAD ROW WITH THE SECTION LINE
- SW COR. SEC. 30, NW COR. SEC. 31 T. 21 S., R. 4 W.
- NE COR. SEC. 36, SE COR. SEC. 25 T. 21 S., R. 5 W. FD. 5/8" REBAR (NO CAP)
- 80'
- 40'
- 40'
- S89°08'30"W
- 1,355.34'
- 1,354.56'
- N89°08'30"E
- 500°51'31"E 80.00'
- S. 1/4 COR. SEC. 30 N. 1/4 COR. SEC. 31 T. 21 S., R. 4 W. FD. 5/8" REBAR (NO CAP)

LEGEND

- RIGHT-OF-WAY LINE
- - - DESIGN CENTERLINE
- - - ALIQUOT SECTION LINE
- FOUND MONUMENT, AS NOTED
- (UPRR) UNION PACIFIC RAILROAD
- (ROW) RIGHT OF WAY
- (C) CENTERLINE
- (P.O.B.) POINT OF BEGINNING
- ▨ SUBJECT AREA TO BE VACATED

Scale: 1 INCH = 300 FEET

North Arrow: N

Surveyor: PAUL W. SMITH, LICENSED LAND SURVEYOR, 4416, 5-10-23, KANSAS

Page 1 OF 1

SURVWEST | SURVEYING • MAPPING • UTILITY • REAL ESTATE
720.259.9316 6501 E Bellevue Ave., Suite 300
www.survwest.com Englewood, CO 80111

PAGE 1 OF 1

