

# McPherson County Public Works

William B. Heller, P.S. 1202 ~ 1115 W. Avenue "A", McPherson, KS 67460

Phone: 1-620-241-0466 ~ E-mail: [billh@mcpcopubwks.org](mailto:billh@mcpcopubwks.org)

## Certificate of Legal Description

This is to certify and acknowledge that I, William B. Heller, Professional Land Surveyor, 1202, in The County of McPherson, State of Kansas, composed this legal description for public road vacation:

### Legal Description parcel in Section 31, T21S-R4W:

A parcel in the Northwest (1/4) of Section Thirty-one (31), Township Twenty-one (21) South, Range Four (4) West of the Sixth Principal Meridian described by William B. Heller, P.S. 1202, June 7, 2022 as follows:

Commencing at the Northwest Corner of said Section Thirty-one (31); thence North 89 degrees 08 minutes 34 seconds East along the North Section Line of said Section Thirty-one (31) to a point on the east railroad right of way of The Union Pacific Railroad, 335.72 feet to The Point of Beginning; thence continuing North 89 degrees 08 minutes 34 seconds East along the North Section Line of said Section Thirty-one (31), 1,083.55 feet; thence South 57 degrees 16 minutes 06 seconds West, 75.75 feet; thence South 89 degree 08 minutes 34 seconds West, 1,043.67 feet; thence North 30 degrees 34 minutes 23 seconds East, 46.88 feet to the point of beginning. Said parcel contains 0.98 acre. Said parcel is subject to any easements or restrictions of record.

### Legal Description parcel in Section 30, T21S-R4W:

A parcel in the Southwest (1/4) of Section Thirty (30), Township Twenty-one (21) South, Range Four (4) West of the Sixth Principal Meridian described by William B. Heller, P.S. 1202, June 7, 2022 as follows:

Commencing at the Southwest Corner of said Section Thirty (30); thence North 89 degrees 08 minutes 34 seconds East along the South Section Line of said Section Thirty (30) to a point on the east railroad right of way of The Union Pacific Railroad, 335.72 feet to The Point of Beginning; thence continuing North 89 degrees 08 minutes 34 seconds East along the South Section Line of said Section Thirty (30), 1,083.55 feet; thence North 57 degrees 16 minutes 06 seconds East, 75.75 feet; thence South 89 degree 08 minutes 34 seconds West, 864.48 feet; thence North 00 degrees 51 minutes 26 seconds West, 10.00 feet; thence South 89 degree 08 minutes 34 seconds West, 252.85 feet; thence South 30 degrees 34 minutes 23 seconds West, 58.60 feet to the point of beginning. Said parcel contains 1.07 acre. Said parcel is subject to any easements or restrictions of record.

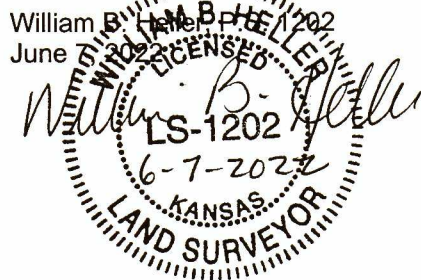

McPherson County Public Works  
1115 West Avenue "A"  
McPherson, KS 6760

## Report of Survey

### Research of the records of McPherson County revealed the following information:

Surveys: Garber Surveying Project G2021-849, date 10-13-2021.

Roads: Previous Arapaho Road, McPherson County to be vacated from plans, "Kansas, 5, 1063 Ext., 1966". Current Arapaho Road, K.D.O.T. right of way from plans, "Kansas, 61-59 K-8253-01, 2008". Rock Island Lines, Medora to Hutchinson, KAS, plan index 19-4-6, dated 1915.



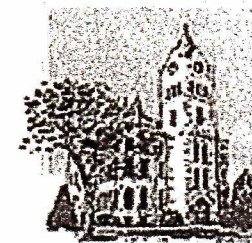
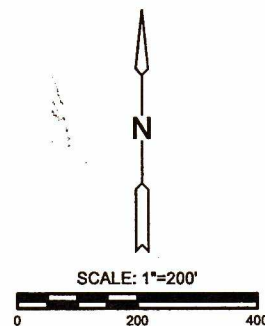

MCPHERSON COUNTY PUBLIC WORKS  
1115 WEST AVENUE A  
MCPHERSON, KANSAS 67460

# PROPOSED R/W VACATION

