

8th AVENUE

N 00°24'21" W 1551.88 (C)
S 00°24'21" E 1520.76 (C)(PS)

P.O.C. 3,4,5
P.O.B. 1
NW Cor. NW 1/4
Sec. 28, T21S, R4W
Fid. Magnol
Origin: (PS)

ARROWHEAD ROAD

N 89°36'26" E 763.99 (C)(PS)

NE Cor. NW 1/4
Sec. 28, T21S, R4W
Fid. 5/8" Rebar w/GSS CLS 52 Cap
Origin: (PS)

LEGEND

- △ - Sectional Monument Found
- - Fid. 5/8" Rebar w/GSS CLS 52 Cap unless otherwise noted
- - 5/8" x 24" Iron Rebar Set w/GSS CLS 52 Cap
- (C) - Calculated
- (M) - Measured
- (PS) - Previous Survey GSS Project #G2015-727
- (R) - Record measurement
- P.O.B. - Point of Beginning
- P.O.C. - Point of Commencement
- - Sanitary Sewer Cleanout
- - Light Pole
- - Power Pole
- (OE) - Overhead Electric Line

-100 0 100 200 300
BASIS OF BEARING = NAD 83 KANSAS SOUTH ZONE

DESCRIPTION:

PARCEL 1 (Previous Survey G2015-727)

A portion of the Northwest Quarter of Section 28, Township 21 South, Range 4 West of the 6th Principal Meridian, McPherson County, Kansas described as follows:

Beginning at the Northwest corner of said Northwest Quarter; thence on a NAD 83 Kansas South Zone bearing of North 89°36'26" East on the North line of said Northwest Quarter a distance of 763.99 feet; thence South 03°44'32" East a distance of 1319.37 feet; thence North 89°46'53" East a distance of 1129.31 feet; thence South 84°25'26" East a distance of 95.57 feet to the Northwest corner of a parcel as described in Deed Book 231, Page 136 recorded at the McPherson County Register of Deeds Office; thence South 03°33'37" East on the West line of said parcel a distance of 188.54 feet to the South line of the North 12 Acres of the South Half of said Northwest Quarter; thence South 89°33'05" West on said South line a distance of 2075.50 feet to the West line of said Northwest Quarter; thence North 00°24'21" West on said West line a distance of 1520.76 feet to the point of beginning.

Containing 33.828 Acres and subject to a road right of way easement across the West 50.00 feet and the North 33.00 feet thereof, and any other easements or restrictions of record.

PARCEL 3

A portion of the Northwest Quarter of Section 28, Township 21 South, Range 4 West of the 6th Principal Meridian, McPherson County, Kansas described as follows:

Commencing at the Northwest corner of said Northwest Quarter; thence on a NAD 83 Kansas South Zone bearing of South 00°24'21" West on the West line of said Northwest Quarter a distance of 1520.76 feet to the South line of the North 12 Acres of the South Half of said Northwest Quarter, being the point of beginning; thence North 89°33'05" East on said South line a distance of 336.16 feet; thence South 02°29'25" East a distance of 14.84 feet; thence South 89°47'36" East a distance of 273.61 feet; thence North 89°36'04" West a distance of 215.09 feet to said West line; thence North 00°24'21" West on said West line a distance of 31.12 feet to the point of beginning.

Containing 0.230 Acre and subject to a road right of way easement across the West 50.00 feet thereof, and any other easements or restrictions of record.

PARCEL 4

A portion of the Northwest Quarter of Section 28, Township 21 South, Range 4 West of the 6th Principal Meridian, McPherson County, Kansas described as follows:

Commencing at the Northwest corner of said Northwest Quarter; thence on a NAD 83 Kansas South Zone bearing of South 00°24'21" West on the West line of said Northwest Quarter a distance of 1520.76 feet to the South line of the North 12 Acres of the South Half of said Northwest Quarter; thence North 89°33'05" East on said South line a distance of 336.16 feet to the point of beginning; thence North 02°29'25" West a distance of 106.86 feet; thence South 89°47'36" East a distance of 273.61 feet; thence South 02°14'09" East a distance of 103.72 feet to said South line; thence South 89°33'05" West on said South line a distance of 273.02 feet to the point of beginning.

Containing 0.660 Acre and subject to any easements or restrictions of record.

PARCEL 5

A portion of the Northwest Quarter of Section 28, Township 21 South, Range 4 West of the 6th Principal Meridian, McPherson County, Kansas described as follows:

Commencing at the Northwest corner of said Northwest Quarter; thence on a NAD 83 Kansas South Zone bearing of South 00°24'21" West on the West line of said Northwest Quarter a distance of 1520.76 feet to the South line of the North 12 Acres of the South Half of said Northwest Quarter; thence North 89°33'05" East on said South line a distance of 809.18 feet to the point of beginning; thence continuing North 89°33'05" East on said South line a distance of 1466.32 feet to the West line of a parcel as described in Deed Book 231, Page 136 recorded at the McPherson County Register of Deeds Office; thence South 03°33'37" East on said West line a distance of 64.88 feet; thence North 81°58'45" West a distance of 139.19 feet; thence North 37°35'20" West a distance of 33.06 feet; thence South 89°36'54" West a distance of 1311.70 feet; thence North 02°14'09" West a distance of 16.47 feet to the point of beginning.

Containing 0.702 Acre and subject to any easements or restrictions of record.

OVERALL PARCEL (Parcels 1, 3 and 5 combined, except Parcel 4)

A portion of the Northwest Quarter of Section 28, Township 21 South, Range 4 West of the 6th Principal Meridian, McPherson County, Kansas described as follows:

Beginning at the Northwest corner of said Northwest Quarter; thence on a NAD 83 Kansas South Zone bearing of North 89°36'26" East on the North line of said Northwest Quarter a distance of 763.99 feet; thence South 03°44'32" East a distance of 1319.37 feet; thence North 89°46'53" East a distance of 1129.31 feet; thence South 84°25'26" East a distance of 95.57 feet to the Northwest corner of a parcel as described in Deed Book 231, Page 136 recorded at the McPherson County Register of Deeds Office; thence South 03°33'37" East on the West line of said parcel a distance of 253.41 feet; thence North 81°58'45" West a distance of 139.19 feet; thence North 37°35'20" West a distance of 33.06 feet; thence South 89°36'54" West a distance of 1311.70 feet; thence North 02°14'09" West a distance of 121.70 feet; thence South 80°27'19" West a distance of 123.19 feet; thence North 89°36'04" West a distance of 215.09 feet to the West line of said Northwest Quarter; thence North 00°24'21" West on said West line a distance of 1551.88 feet to the point of beginning.

Containing 34.100 Acres and subject to a road right of way easement across the West 50.00 feet and the North 33.00 feet thereof, and any other easements or restrictions of record.

PARCEL 1
33.828 Acres
(Per Previous Survey G2015-727)

PARCEL 3
0.230 Acre
(To Be Joined With Parcel 1)

PARCEL 4
0.660 Acre
(To Be Joined With Adjacent Parcel To The South)

PARCEL 5
0.702 Acre
(To Be Joined With Parcel 1)

SURVEYOR'S CERTIFICATE:

I hereby certify this plat to be a true, correct and complete representation of the property described herein, as surveyed under my supervision, this 10th day of September, 2020.

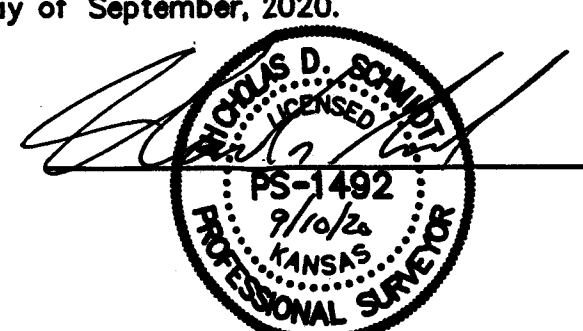

NOTES:

Survey was made as per client request and no title work has been provided to the surveyor; therefore, the number and extent of easements and/or rights-of-way of record affecting the surveyed property has not been addressed by this survey.

Prepared For:	MAX WIENS		
Prepared By:	Garber Surveying Service, P.A.		
Drawn By:	KDZ	Date of Field Work:	September 8, 2020
Checked By:	NDZ	Date:	09/10/2020
Scale:	1"=100'	Sheet	1 of 1 Sheet(s)
Job No:	G2020-628		

DESCRIPTION: A PORTION OF THE NW 1/4 SECTION 28 T21S, R4W McPHERSON COUNTY, KANSAS

HUTCHINSON (Main Office) 2908 North Main St. 67502 Ph. 620-665-7833 Fax 620-665-7401
McPHERSON (Branch Office) 206 South Main 67460 Ph. 620-241-4441 Fax 620-241-4450
NEWTON (Branch Office) 511 North Poplar St. 67114 Ph. 316-283-5053 Fax 316-283-5075
MAINEATTAN (Branch Office) 3226 Klamath Ave. Ste. B2 66583 Ph. 785-528-4810