

Heller Boundary Surveys

William B. Heller, P.S. 1202 ~ Cellular: 1-620-245-8023

863 S. 9th Street, Salina, KS 67401 ~ E-mail: willyboskilly@yahoo.com

Certificate of Survey

This is to certify and acknowledge that I, William B. Heller, a registered land surveyor in the County of McPherson, State of Kansas, surveyed the following:

12.2 acre parcel : A 12.2 acre parcel located in The West One-half (1/2) of The Northwest One Quarter (1/4) of Section Twenty-four (24), Township Twenty-one (21) South – Range Three (3) West of the Sixth Principal Meridian.

More particularly described as follows: Commencing at the Northwest Corner of said Section Twenty-four (24), Township Twenty-one (21) South – Range Three (3) West of the Sixth Principal Meridian, The Point of Beginning; thence North 89 degrees 24 minutes 57 seconds East along the north section line of said Section Twenty-four (24), 504.34 feet; thence South 01 degrees 24 minutes 17 seconds East, 224.28 feet; thence North 87 degrees 49 minutes 37 seconds East, 199.74 feet; thence South 42 degrees 34 minutes 38 seconds East, 35.64 feet; thence South 06 degrees 54 minutes 33 seconds East, 63.11 feet; thence North 84 degrees 45 minutes 43 seconds East, 185.83 feet; thence South 09 degrees 28 minutes 54 seconds East, 266.11 feet; thence South 88 degrees 09 minutes 22 seconds West, 557.20 feet; thence North 32 degrees 39 minutes 47 seconds West, 71.07 feet; thence South 87 degrees 06 minutes 53 seconds West, 79.67 feet; thence South 26 degrees 53 minutes 33 seconds West, 201.92 feet; thence South 05 degrees 16 minutes 44 seconds East, 460.47 feet; thence South 84 degrees 49 minutes 07 seconds West, 234.86 feet; thence North 00 degrees 35 minutes 59 seconds West along the west section line of said Section Twenty-four (24), 1,165.58 feet to The Point of Beginning. Said parcel contains 12.2 acres, including road right of way. Said parcel is subject to any easements or restrictions of record.

William B. Heller, P.S. 1202

June 23, 2021

For: Jason and Yvonne Wheatley
1711 Buckskin Road
Moundridge, KS 67107

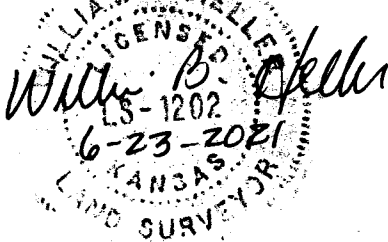

Report of Survey

Research of the records at the McPherson County Public Works Department and McPherson County Court House revealed the following information:

Roads: Buckskin Road is 66.0 feet wide, 33.0 feet on each side of the section line. 17th Avenue is 66.0 feet wide, 33.0 feet on each side of section line. 1.3 acre is contained in the road right of way on the north and west side of this 12.2 acre parcel.

Surveys: Original General Land Office subdivision by Stuck and Hill, completed November 1 thru November 3, 1860. Section corner references found at the McPherson County Public Works vault. Survey by Garber Surveying Service, dated May 30, 2007.

Field Procedure: G.P.S. positions were observed with Ashtech Static G.P.S. receivers. Distances and angles read with a Nikon DTM 522 Total Station. All distances are calculated/measured distances. I set 1/2" x 24 " rebars with I.D. caps at the property pins monumented.

Plat of Survey

Heller Boundary Surveys, W.B. Heller, P.S. 1202, cell: 620-245-8023
 863 S. 9th Street, Salina, KS 67401, email: willyboskilly@yahoo.com
 A 12.2 Acre Parcel in The N.W. 1/4 of Section 24, T21S-R3W

