

BASIS OF BEARING = NAD 83 KANSAS SOUTH ZONE

LEGEND

- △ - Sectional Monument Found
- - 5/8" x 24" Iron Rebar Set w/G.S.S. Cap
- (C) - Calculated
- (M) - Measured
- P.O.B. - Point of Beginning
- P.O.C. - Point of Commencement

DESCRIPTION:

A portion of the Southeast Quarter of Section 34, Township 21 South, Range 3 West of the 6th Principal Meridian, McPherson County, Kansas described as follows:

Commencing at the Southwest corner of said Southeast Quarter; thence on a NAD 83 Kansas South Zone bearing of North 89°02'22" East on the South line of said Southeast Quarter a distance of 514.86 feet to the point of beginning; thence North 00°10'43" East a distance of 885.93 feet; thence South 89°02'22" West a distance of 68.13 feet; thence North 00°10'43" East a distance of 197.98 feet; thence North 89°02'22" East parallel with said South line a distance of 191.61 feet; thence South 75°20'05" East a distance of 98.47 feet; thence North 89°01'52" East a distance of 96.70 feet; thence South 00°10'42" West a distance of 167.00 feet; thence South 48°12'12" West a distance of 163.23 feet; thence South 71°22'10" West a distance of 118.35 feet; thence South 02°11'22" West a distance of 210.58 feet; thence South 30°46'10" East a distance of 619.23 feet to said South line; thence South 89°02'22" West on said South line a distance of 393.23 feet to the point of beginning.

Containing 5.626 Acres and subject to a road right of way easement across the South 33.00 feet thereof, and any other easements or restrictions of record.

SURVEYOR'S CERTIFICATE:

I hereby certify this plat to be a true, correct and complete representation of the property described hereon, as surveyed under my supervision, this 28th day of September, 2015

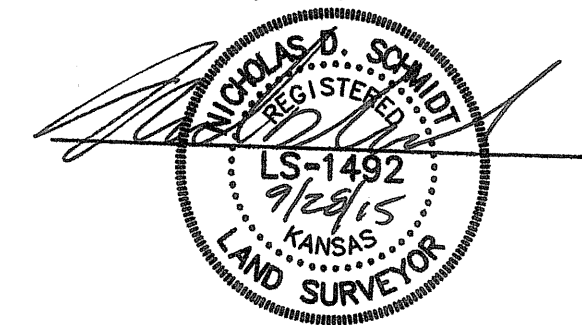

5.626 Acres

APACHE ROAD

SW Cor. SE 1/4
Sec. 34, T21S, R3W
Fd. 1/2" Rebar w/LS 1202 Cap
Origin: McPherson Co. Reference Ties By LS 1202

P.O.C.

P.O.B.

SE Cor. SE 1/4
Sec. 34, T21S, R3W
Fd. 1/2" Rebar w/Illegible Cap
Origin: McPherson Co. Reference Ties By LS 1202

N 89°02'22" E 1738.04 (C)

S 89°02'22" W 2646.13 (M)

Prepared For:

KALI GRABER

Description:

A PORTION OF THE SE 1/4
SECTION 34, T21S, R3W
McPHERSON COUNTY, KANSAS

Prepared By:



Garber Surveying Service, P.A.

HUTCHINSON (Main Office) 2908 North Plum St. 67502 Ph. 620-665-7032 Fax 620-663-7401
McPHERSON (Branch Office) 115 East Marlin 67460 Ph. 620-241-4441 Fax 620-241-4458
NEWTON (Branch Office) 511 North Poplar St. 67114 Ph. 316-283-5053 Fax 316-283-5073

Drawn By: KLL

Scale: 1"=100'

Date of Field Work: September 22, 2015

Job No:

Checked By: NDS

Date: 09/28/2015

Sheet 1 of 1 Sheet(s)

G2015-673