

Plat of Survey

Heller Boundary Surveys, W. B. Heller, L.S. 1202, 863 S. 9th, Salina, KS 67401 Ph: 1-620-245-8023

Survey located in the S. 1/2,
S. 1/2, Section 21, T21S-R3W

scale: 1" = 440'

Date: December 14, 2009

For: Beau D. Froese
214 14th Avenue
Inman, KS 67546

W. 1/4 Cor., Sec 21, T21S-R3W
Found: "PK" nail
Origin: unknown

Center Cor., Sec. 21, T21S-R3W
Not set, position derived
from Garber Survey

N.E. Cor., Sec 21, T21S-R3W
Found: 5/8" rebar
Origin: unknown

E. 1/4 Cor., Sec. 21, T21S-R3W
Set 1/2" x 24" rebar & I.D. cap
Origin: W. B. Heller

14th Avenue
N 0°00'00" E (assumed)
1,319.89' (cm)
30' R/W

S 1/16 Cor., S.W. 1/4 Sec 21, T21S-R3W
Set: "MAG" nail in asphalt
Origin: W. B. Heller

14th Avenue
N 0°00'00" E (assumed)
1,319.89' (cm)
30' R/W

Parcel #1
13.25 Ac incl. R/W
991.86'
508.70'
616.76'

P.O.B. Parcel #1
N 89°18'55"W
N 1°11'45"W
134.92'

N 89°27'56"W
395.59'

2,052.05' (m)

S.W. Cor., Sec. 21, T21S-R3W
Found: "PK" nail
Origin: unknown

N 88°52'57" E

Arrowhead Road

Note: All distances are calculated / measured unless noted.

Legend
▲ = Section Corner Found
△ = Section Corner Set
● = 1/2" x 24" rebar & I.D. cap set
P.O.B. = Point of Beginning
\$ = section line
R = property line
(cm) = calculated / measured distance
(m) = measured distance
■ = "60D" spike set

S 1/16 Cor., S.E. 1/4 Sec 21, T21S-R3W, Set: 1/2" x 24" rebar & I.D. cap
Origin: W. B. Heller

N 1°23'54"W
18.95'

Parcel #2
49.6 Ac, incl. R/W

N 89°02'44"E
1,046.16'

N 88°37'48"E
388.71'

S 4°38'06"E
21.82'

N 89°02'44"E 1,852.12'

House Area

Parcel #3
49.9 Ac, incl. R/W

2,670.45' (m)

N 89°09'34" E

S.E. Cor., Sec. 21, T21S-R3W
Found: "MAG" nail
Origin: unknown

N 0°07'11" W
2,646.77' (m)

25' R/W
1,323.40'

15th Avenue
N 0°07'11" W 2,646.80' (m)

P.O.B. Parcel #2

P.O.B. Parcel #3

Heller Boundary Surveys

William B. Heller, L.S. 1202, 863 S. 9th Street, Salina, KS 67401

Cellular: 620-245-8023, Email: willyboskilly@yahoo.com

Certificate of Survey

This is to certify and acknowledge that I, William B. Heller, a registered land surveyor in the County of McPherson, State of Kansas, surveyed the following:

Legal Description Parcel #1: Commencing at the Southwest Corner of Section Twenty-one (21), Township Twenty-one (21) South – Range Three (3) West of the Sixth Principal Meridian; thence North 00 degrees 00 minutes 00 seconds East, 811.26 feet along the West Section Line of said Section Twenty-one (21) to the point of beginning; thence North 00 degrees 00 minutes 00 seconds East, 508.70 feet; thence North 88 degrees 59 minutes 01 seconds East, 991.86 feet; thence South 01 degrees 59 minutes 36 seconds East, 672.64 feet; thence North 89 degrees 27 minutes 56 seconds West, 395.59 feet; thence North 01 degrees 11 minutes 45 seconds West, 134.92 feet; thence North 89 degrees 18 minutes 55 seconds West, 616.76 feet to the point of beginning. Said parcel contains 13.25 acres including existing road right of way. Said parcel is subject to any easements or restrictions of record.

Legal Description Parcel #2: Commencing at the Southeast Corner of Section Twenty-one (21), Township Twenty-one (21) South – Range Three (3) West of the Sixth Principal Meridian; thence North 00 degrees 07 minutes 11 seconds West, 661.70 feet along the East Section Line of said Section Twenty-one (21) to the point of beginning; thence North 00 degrees 07 minutes 11 seconds West, 661.70 feet; thence South 88 degrees 59 minutes 01 seconds West, 3,289.13 feet; thence South 00 degrees 11 minutes 36 seconds East, 658.13 feet; thence North 89 degrees 02 minutes 44 seconds East, 1,046.16 feet; thence North 01 degrees 23 minutes 54 seconds West, 18.95 feet; thence North 88 degrees 37 minutes 48 seconds East, 388.71 feet; thence South 04 degrees 38 minutes 06 seconds East, 21.82 feet; thence North 89 degrees 02 minutes 44 seconds East, 1,852.12 feet to the point of beginning. Said parcel contains 49.6 acres including existing road right of way. Said parcel is subject to any easements or restrictions of record.

Legal Description Parcel #3: Commencing at the Southeast Corner of Section Twenty-one (21), Township Twenty-one (21) South – Range Three (3) West of the Sixth Principal Meridian, the point of beginning; thence North 00 degrees 07 minutes 11 seconds West, 661.70 feet; thence South 89 degrees 02 minutes 44 seconds West, 1,852.12 feet; thence North 04 degrees 38 minutes 06 seconds West, 21.82 feet; thence South 88 degrees 37 minutes 48 seconds West, 388.71 feet; thence South 01 degrees 23 minutes 54 seconds East, 18.95 feet; thence South 89 degrees 02 minutes 44 seconds West, 1,046.16 feet; thence South 00 degrees 11 minutes 36 seconds East, 658.13 feet; thence North 88 degrees 52 minutes 57 seconds East, 616.89 feet; thence North 89 degrees 09 minutes 34 seconds East, 2,670.45 feet to the point of beginning. Said parcel contains 49.9 acres including existing road right of way. Said parcel is subject to any easements or restrictions of record.

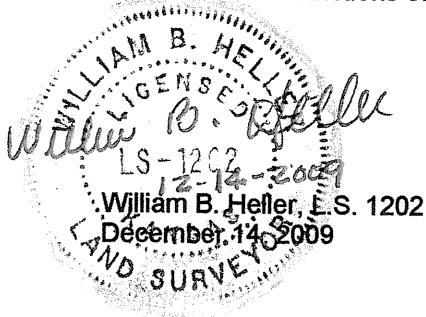

For: Beau D. Froese
214 14th Avenue
Inman, KS 67546

Report of survey

Research of the records at the McPherson County Public Works office revealed the following information:

Roads: 14th Avenue is 60' wide, 30' on each side of section line. Area contained in the right of way on the west side of parcel #1 is 0.35 acre. 15th Avenue is 50' wide, 25' on each side of section line. Area contained in the right of way on the east side of parcel #2 is 0.40 acre. 15th Avenue is 50' wide, 25' on each side of section line. Arrowhead Road is 100' wide, 50' on each side of section line. Area contained in the right of way on the south and east side of parcel #3 is 4.1 acre.

Surveys: G.L.O. survey for township subdivisions performed by Stuck and Hill, November 1860. References for section corners found at the McPherson County Public Works Office. Surveys by Garber Surveying Service dated July 6, 1984 and May 7, 1990.

Field procedure: Distances and angles read with a Nikon DTM 522 Total Station. All distances are calculated/measured distances. I set 1/2" x 24" rebars at the lot pins monumented. I set "60D" spikes at the bump out for the house location for Ray Froese and for extra points on the north line of the S.1/2, S.1/2 of Section 21, T21S-R3W.