

## LEGEND

△	Sectional Monument Found
▲	Section Monument Set 5/8" x 24" Iron Rebar w/G.S.S. Cap
●	5/8" x 24" Iron Rebar Set w/G.S.S. Cap
○	Calculated
(M)	Measured
(PS)	Previous Survey Durr Engineering 4-20-2011
(R)	Record measurement
P.O.B.	Point of Beginning
P.O.C.	Point of Commencement

**DESCRIPTION:**

**PARCEL 1**

Portions of the Northeast and Northwest Quarters of Section 5, Township 21 South, Range 2 West of the 6th Principal Meridian, McPherson County, Kansas described as follows:

Beginning at the Northwest corner of the Northwest Quarter of Section 5, Township 21 North, Range 2 West of the 6th Principal Meridian; thence on a Kansas State Plane Zone 1502 bearing North 89°24'13" East along the North line of said Northwest Quarter 2654.15 feet to the Northeast corner of said Northwest Quarter; thence North 89°24'13" East along the North line of the Northeast Quarter of said Section 5 a distance of 445.50 feet (Record); thence South 14°27'43" West 919.26 feet (900.9 feet Record); thence South 89°24'13" West parallel with the North line of said Northwest Quarter 209.55 feet (Record) to the West line of said Northeast Quarter; thence North 00°24'38" West along said West line 280.57 feet; thence South 89°24'13" West parallel with the North line of said Northwest Quarter 2655.22 feet to the West line of said Northwest Quarter; thence North 00°18'36" West along said West line 607.13 feet to the point of beginning, containing **43.675 Acres**, subject to road right of way easements across the West and North 33.00 feet thereof, and any other easements or restrictions of record.

**PARCEL 2**

A portion of Northwest Quarter of Section 5, Township 21 South, Range 2 West of the 6th Principal Meridian, McPherson County, Kansas described as follows:

Commencing at the Northwest corner of the Northwest Quarter of Section 5, Township 21 North, Range 2 West of the 6th Principal Meridian; thence on a Kansas State Plane Zone 1502 bearing South 001°18'36" East along the West line of said Northwest Quarter 60713 feet to the point of beginning; thence North 89°24'13" East parallel with the North line of said Northwest Quarter 100 feet to the East line of said Northwest Quarter; thence South 002°43'38" East along said East line 705.28 feet to the point of beginning; thence North 89°24'13" East along said East line 705.28 feet to the point of beginning; thence North 001°18'36" West along said West line 705.28 feet to the point of beginning, containing **43,000 Acres**, subject to a road right of way easement across the West 33.00 feet thereof, and any other easements or restrictions of record.

PARCEL 3

Portions of the Northwest and Southwest Quarters of Section 5, Township 21 South, Range 2 West of the 6th Principal Meridian, McPherson County, Kansas described as follows:

Commencing at the Northwest corner of the Northwest Quarter of Section 5, Township 21 North, Range 2 West of the 6th Principal Meridian; thence on a Kansas State Plane Zone 1502 bearing South 00°18'36" East along the West line of said Northwest Quarter 1312.41 feet to the point of beginning; thence Northeast 89°24'14" East parallel with the North line of said Northwest Quarter 2656.45 feet to the East line of said Northwest Quarter; thence South 00°24'38" East along said East line 1118.80 feet to the Southeast corner of said Northwest Quarter; thence South 89°58'12" West along the South line of said Northwest Quarter 66.00 feet (Record); thence South 43°05'04" West 791.09 feet (792.0 feet Record); thence North 89°58'12" East parallel with the North line of the Southwest Quarter of said Section 5 a distance of 610.50 feet (Record) to the East line of said Southwest Quarter; thence South 00°24'35" East along said East line 12.29 feet; thence South 89°58'12" West parallel with the North line of said Southwest Quarter 1329.71 feet to the West line of the East Half of said Southwest Quarter; thence South 00°21'37" East along said West line of the East Half of the Southwest Quarter 35.51 feet; thence South 89°58'12" West parallel with the North line of said Southwest Quarter 329.77 feet to the West line of said Southwest Quarter; thence North 00°18'41" West along the West line of said Southwest Quarter 655.30 feet to the Northwest Corner of said Southwest Quarter; thence North 00°18'36" West along the West line of said Northwest Quarter 1092.53 feet to the point of beginning, containing **100.967 Acres**, subject to a road right of way easement across the West 33.00 feet thereof, and any other easements or restrictions of record.

**SURVEYOR'S CERTIFICATE:**  
I hereby certify this plat to be a true, correct and complete representation of the property described hereon, as surveyed under my supervision, this 12th day of November, 2013.

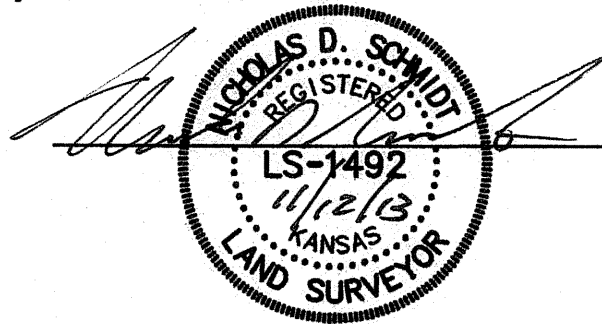

Prepared For: <b>BRADLEY KAUFMAN</b>		Description: <b>PORTIONS OF SECTION 5, T21S, R2W MCPHERSON COUNTY, KANSAS</b>	
Prepared By: <b>Garber Surveying Service, P.A.</b>			
		<b>HUTCHINSON (Main Office) 2908 North Plum St. 67502 Ph. 620-665-7032 Fax 620-663-7401</b> <b>McPHERSON (Branch Office) 115 East Main St. 67401 Ph. 620-241-4441 Fax 620-241-4441</b> <b>NEWTON (Branch Office) 511 North Poplar St. 67114 Ph. 316-283-5053 Fax 316-283-5073</b>	
Drawn By: <b>CSS</b>	Scale: <b>1"=200'</b>	Date of Field Work: <b>October 29, 2013</b>	Job No: <b>G2013-685</b>
Checked By: <b>NDS</b>	Date: <b>11/12/2013</b>	Sheet 1 of 1 Sheet(s)	

Saved 11/12/2013 9:39:46 AM by CSWANEY  
 Plot Date & Time Tuesday, November 12, 2013 9:39:54 AM Dwa Path \\Fs2\company\LOD\_GSSFILES\2013\20130685 C3d.dwg\20130685 Auto S Ground