

P.O.C. 2
P.O.B. 1
NE Cor. SE 1/4
Sec. 34, T21S, R2W
Fd. 5/8" Rebar
Origin: Previous Survey GSS Project #G2014-457

NW Cor. SE 1/4
Sec. 34, T21S, R2W
Fd. 5/8" Rebar w/GSS Cap
Origin: (PS)

N 89°27'42" E 1335.86 (M)

N 89°27'42" E 2646.42 (M)(PS) 2624.38 (PS1)

N 89°27'42" E 1310.56 (M)

Fd. 1/2" Rebar w/Broken Cap 0.48' N. of Line
Origin: (PS1)

Fd. 1/2" Rebar (Bent)
Reset 5/8" Rebar w/GSS CLS 52 Cap
50.00 (M)

Parcel 1
21.93 Acres

Parcel 2
58.60 Acres

N 00°43'22" E 724.67 (M)

S 89°28'09" W 1325.61 (C)

N 1/2, SE 1/4

1275.61 (M)

50.00 (C)

P.O.B. 2

50' R/W Line

50.00 (M)

SE Cor. N 1/2, SE 1/4
Sec. 34, T21S, R2W

S 89°21'05" W 2647.52 (M)

S 1/2, SE 1/4

2597.52 (M)

S 00°28'02" E 597.95 (C)
S 00°28'02" E 2645.25 (M) 2645.72 (PS1)

1327.72 (M)

SE Cor. SE 1/4
Sec. 34, T21S, R2W
Fd. 1" Rebar
Origin: Previous Survey GSS Project #G2014-457

S 89°14'29" W 2648.63 (M) 2663.58 (PS1)
APACHE ROAD

LEGEND

- △ - Sectional Monument Found
- ▲ - Section Monument Set (5/8" x 24" Iron Rebar w/GSS CLS 52 Cap)
- - Survey Monument Found
- - 5/8" x 24" Iron Rebar Set w/GSS CLS Cap
- (C) - Calculated
- (M) - Measured
- (PS) - Previous Survey GSS Project #G2013-191
- (PS1) - Previous Survey by Thrower LS 1297, 7/28/2001
- P.O.B. - Point of Beginning
- P.O.C. - Point of Commencement

SURVEYOR'S NOTE:

- Survey was made as per client request and no title work has been provided to the surveyor; therefore, the number and extent of easements and/or rights-of-way of record affecting said property has not been verified by this Survey.

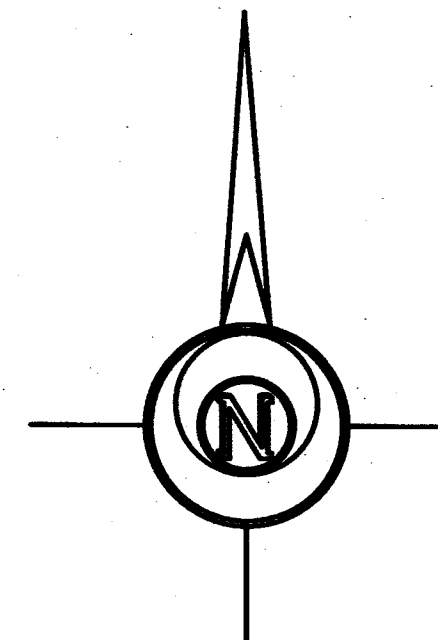

-200 0 200 400 600

BASIS OF BEARING = NAD 83 KANSAS SOUTH ZONE

DESCRIPTION:

PARCEL 1

A portion of the North Half of the Southeast Quarter of Section 34, Township 21 South, Range 2 West of the 6th Principal Meridian, McPherson County, Kansas, described as follows by Nicholas D. Schmidt, PS #1492, this 22nd day of March, 2022:

Beginning at the Northeast corner of said Southeast Quarter; thence on a NAD 83 Kansas South Zone bearing of South 00°28'02" East on the East line of said Southeast Quarter a distance of 724.67 feet; thence South 89°28'09" West a distance of 1325.61 feet; thence North 00°43'22" East a distance of 724.67 feet to the North line of said Southeast Quarter; thence North 89°27'42" East on said North line a distance of 1310.56 feet to the point of beginning.

Containing 21.93 Acres and subject to a road right of way easement along the East line thereof and any other easements or restrictions of record.

PARCEL 2

A portion of the North Half of the Southeast Quarter of Section 34, Township 21 South, Range 2 West of the 6th Principal Meridian, McPherson County, Kansas, described as follows by Nicholas D. Schmidt, PS #1492, this 22nd day of March, 2022:

Commencing at the Northeast corner of said Southeast Quarter; thence on a NAD 83 Kansas South Zone bearing of South 00°28'02" East on the East line of said Southeast Quarter a distance of 724.67 feet to the point of beginning; thence continuing South 00°28'02" East on said East line a distance of 597.95 feet to the Southeast corner of the North Half of said Southeast Quarter; thence South 89°21'05" West on the South line of said North Half a distance of 2647.52 feet to the Southwest corner of said North Half; thence North 00°25'13" West on the West line of said Southeast Quarter a distance of 1327.72 feet to the Northwest corner of said Southeast Quarter; thence North 89°27'42" East on the North line of said Southeast Quarter a distance of 1335.86 feet; thence South 00°43'22" West a distance of 724.67 feet; thence North 89°28'09" East a distance of 1325.61 feet to the point of beginning.

Containing 58.60 Acres and subject to a road right of way easement along the East line thereof and any other easements or restrictions of record.

SURVEYOR'S CERTIFICATE:

I hereby certify this plat to be a true, correct and complete representation of the property described hereon, as surveyed under my supervision, this 22nd day of March, 2022.

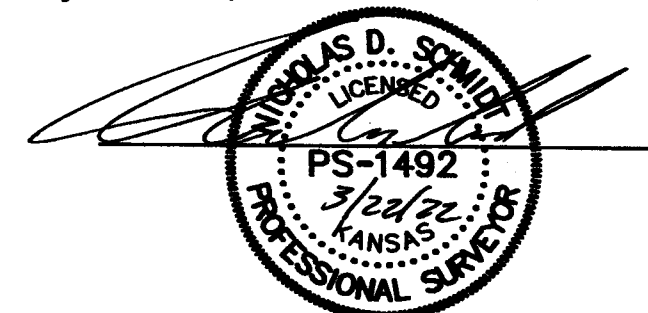

Prepared For:

FRANK BARNETT

Description:

THE N 1/2, SE 1/4
SECTION 34, T21S, R2W
McPHERSON COUNTY, KANSAS

Prepared By:



HUTCHINSON
2908 North Plum St. 67502
Ph. 620-665-7032
(Main Office)

BRANCH OFFICES:
MANHATTAN Ph. 785-320-4810
MCPHERSON Ph. 620-241-4441
SALINA Ph. 785-404-6302
NEWTON Ph. 316-283-5053
WICHITA Ph. 316-260-9933

Drawn By:

KDZ

Scale:

1"=200'

Date of Field Work:

March 10, 2022

Job No:

G2022-183

Checked By:

NDS

Date:

03/22/2022

Sheet 1 of 1 Sheet(s)