

- LEGEND**
- △ - Sectional Monument Found
  - - 5/8" x 24" Iron Rebar Set w/GSS CLS 52 Cap
  - (C) - Calculated
  - (M) - Measured
  - (R) - Record measurement
  - (PS) - Previous Survey GSS Project #G2021-534
  - (PS1) - Previous Survey by Alpha Land Surveys (10/6/2020)
  - P.O.B. - Point of Beginning
  - P.O.C. - Point of Commencement

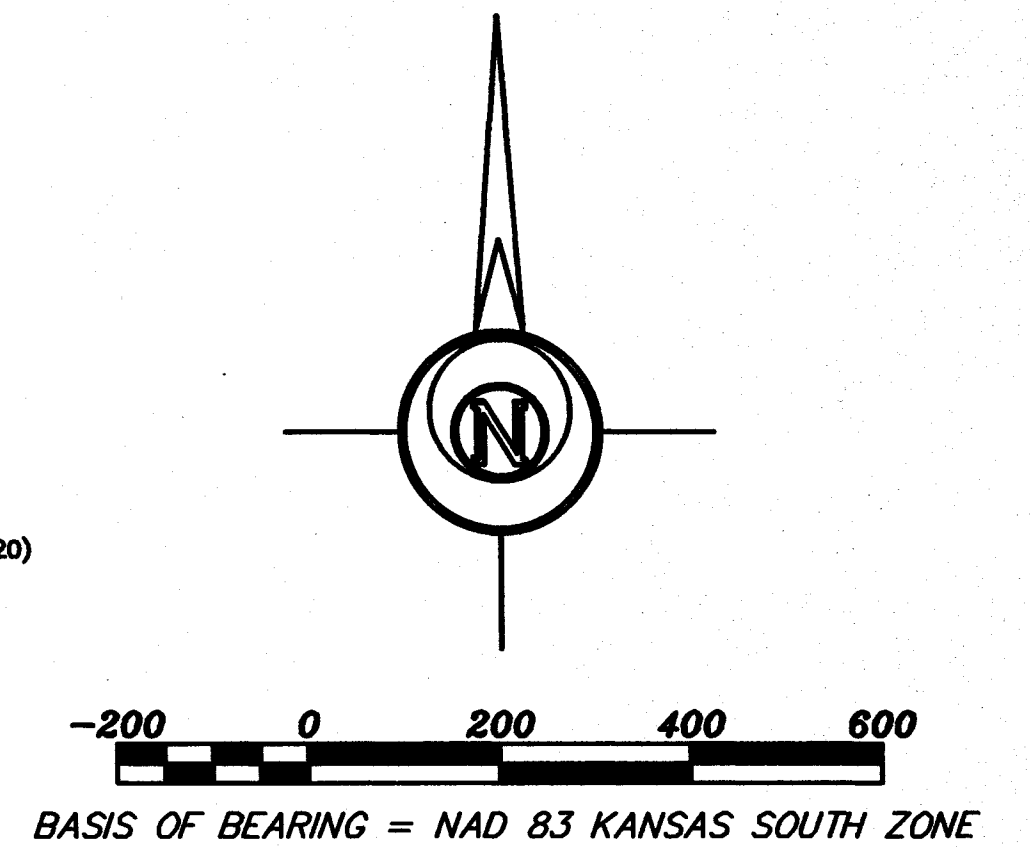

**DESCRIPTION:**

A portion of the Northeast Quarter of Section 23, Township 21 South, Range 2 West of the 6th Principal Meridian, McPherson, Kansas, described as follows by Nicholas D. Schmidt, PS #1492, this 23rd day of December, 2021:

Commencing at the Southeast corner of said Northeast Quarter; thence on a NAD 83 Kansas South Zone bearing of North 00°06'19" West on the East line of said Northeast Quarter a distance of 107.18 feet (Record) to the point of beginning; thence South 89°46'43" West parallel with the South line of said Northeast Quarter a distance of 454.63 feet (Record); thence North 00°06'19" West parallel with said East line a distance of 1651.58 feet; thence North 09°07'27" East a distance of 366.21 feet to the Southerly Right of Way line of Interstate Highway 135; thence South 50°01'53" East on said Right of Way a distance of 294.68 feet; thence South 20°15'53" East continuing on said Right of Way a distance of 379.00 feet; thence South 89°52'46" East continuing on said Right of way distance of 39.79 feet to the East line of said Northeast Quarter; thence South 00°06'19" East on said East line a distance of 1466.48 feet to the point of beginning.

Containing 18.67 Acres and subject to a road right of way easement along the East line thereof, and any other easements or restrictions of record.

**SURVEYOR'S CERTIFICATE:**

I hereby certify this plat to be a true, correct and complete representation of the property described hereon, as surveyed under my supervision, this 23rd day of December, 2021.

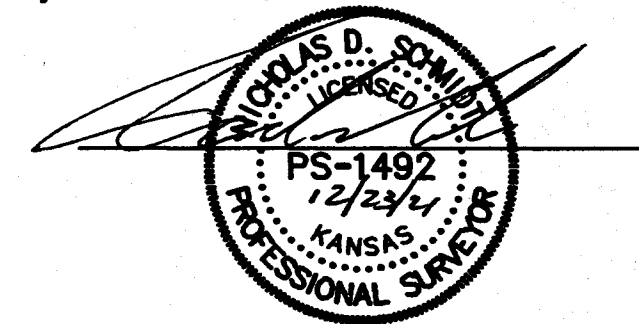

Prepared For:		Description:	
<b>TORTILLA KING</b>		<b>A PORTION OF THE NE 1/4 SECTION 23, T21S, R2W McPHERSON COUNTY, KANSAS</b>	
Prepared By:		<b>Garber Surveying Service, P.A.</b>	
		BRANCH OFFICES: MANHATTAN Ph. 785-328-4810 NEWTON Ph. 316-283-5053 WICHITA Ph. 316-260-9933	
Drawn By: <b>KDZ</b>		Scale: <b>1"=200'</b>	Date of Field Work: <b>December 14, 2021</b>
Checked By: <b>NDS</b>		Date: <b>12/23/2021</b>	Sheet <b>1 of 1</b> Sheet(s)
			Job No: <b>G2021-1235</b>