

-100 0 100 200 300

BASIS OF BEARING = NAD 83 KANSAS SOUTH ZONE

**LEGEND**

- △ - Sectional Monument Found
- ▲ - Section Monument Set (5/8" x 24" Iron Rebar w/G.S.S. Cap)
- - Survey Monument Found
- (C) - Calculated
- (M) - Measured
- P.O.B. - Point of Beginning
- P.O.C. - Point of Commencement

**DESCRIPTION:**

A portion of the North Half of the Northwest Quarter of Section 24, Township 21 South, Range 1 West of the 6th Principal Meridian, McPherson County, Kansas described as follows:

Commencing at the Northeast Corner of the Northwest Quarter of Section 24, Township 21 South, Range 1 West of the 6th Principal Meridian; thence with a NAD 83 Kansas South Zone bearing of South 89°33'07" West along the North line of said Northwest Quarter 18.00 feet for the point of beginning; thence South 00°35'19" East parallel with the East line of said Northwest Quarter 1324.99 feet to the South line of the North Half of said Northwest Quarter; thence South 89°29'48" West along the South line of the North Half of said Northwest Quarter 1084.38 feet; thence North 00°35'03" West parallel with the West line of said Northwest Quarter 709.17 feet; thence North 58°00'11" West 224.16 feet; thence North 00°35'03" West parallel with the West line of said Northwest Quarter 496.61 feet to the North line of said Northwest Quarter; thence North 89°33'07" East along the North line of said Northwest Quarter 1273.17 feet to the point of beginning, containing **35.410 Acres**, subject to a road Right-of-Way Easement across the North 33.00 feet thereof and any other easements of record.

**SURVEYOR'S CERTIFICATE:**

I hereby certify this plot to be a true, correct and complete representation of the property described herein, as surveyed under my supervision, this 3rd day of April, 2015.

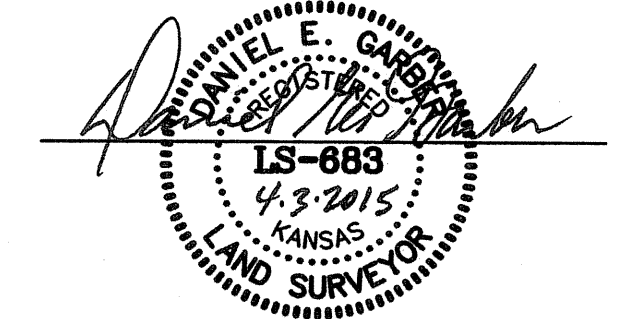

Prepared For:

**DONALD SCHROEDER**

Description:

**A PORTION OF THE NW 1/4  
SECTION 24, T21S, R1W  
MC PHERSON COUNTY, KANSAS**

Prepared By:



**Garber Surveying Service, P.A.**

HUTCHINSON (Main Office) 2908 North Plum St. 67502 Ph. 620-665-7032 Fax 620-663-7401  
McPHERSON (Branch Office) 115 East Marlin 67460 Ph. 620-241-4441 Fax 620-241-4458  
NEWTON (Branch Office) 511 North Poplar St. 67114 Ph. 316-283-5053 Fax 316-283-5073

Drawn By: WJA

Scale: 1"=100

Date of Field Work: February 20, 2015

Job No:

Checked By: DEG

Date: 04/03/2015

Sheet 1 of 1 Sheet(s)

G2015-90