

- LEGEND**
- △ - Sectional Monument Found
 - (M) - Measured
 - (PS) - Previous Survey GSS Project #G2017-518
 - *- Proposed Fence

DESCRIPTION:

The Northeast Quarter of Section 8, Township 20 South, Range 5 West of the 6th Principal Meridian, McPherson County, Kansas.

Containing 159.153 Acres and subject to road right of way easements across the North and East 33.00 feet thereof and any other easements and restrictions of record.

NOTE:

Survey was made as per client request and no title work has been provided to the surveyor; therefore, the number and extent of easements and/or rights of way of record affecting said property has not been verified by this Survey.

SURVEYOR'S CERTIFICATE:

I hereby certify this plot to be a true, correct and complete representation of the property described hereon, as surveyed under my supervision, this 10th day of November, 2020.

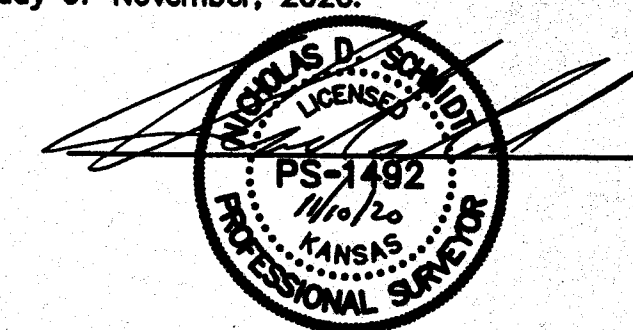

Prepared For: MYRON TIPPETT		Description: A PORTION OF THE NE 1/4 SECTION 8, T20S, R5W McPHERSON COUNTY, KA	
Prepared By: GSS		Garber Surveying Service, P.A.	
HUTCHINSON (Main Office) 2988 North Plum St. 67502 Ph. 424-665-7832 Fax 624-665-7832		McPHERSON (Branch Office) 296 South Main 67460 Ph. 424-241-4441 Fax 624-241-4441	
NEWTON (Branch Office) 511 North Poplar St. 67114 Ph. 316-283-5013 Fax 316-283-5013		MANHATTAN (Branch Office) 3226 Kimball Ave Ste. 22 66503 Ph. 785-330-4811	
Drawn By: KZ	Scale: 1"=200'	Date of Field Work: October 30, 2020	Job No:
Checked By: NDS	Date: 11/10/2020	Sheet 1 of 1 Sheet(s)	G2020