

LEGEND

- △ - Sectional Monument Found
- ▲ - Section Monument Set (5/8" x 24" Iron Rebar w/G.S.S. Cap)
- - 5/8" x 24" Iron Rebar Set w/G.S.S. Cap
- (C) - Calculated
- (M) - Measured
- (PS) - Previous Survey - Record of surveys Book A, Page 82, by County Surveyor Bass Dated 3/3/1884
- (R) - Record measurement
- P.O.B. - Point of Beginning

SURVEY DESCRIPTION:

A portion of the Northwest Quarter of Section 13, Township 20 South, Range 3 West of the 6th Principal Meridian, McPherson County, Kansas described as follows:

Beginning at the Northwest corner of the Northwest Quarter of Section 13, Township 20 South, Range 3 West of the 6th Principal Meridian; thence on a Kansas State Plane Zone 1502 Bearing North 88°39'31" East along the North line of said Northwest Quarter 2622.64 feet to a point 114.18 feet (Record) West on the Northeast corner of said Northwest Quarter; thence South 01°24'59" East 1316.78 feet (1313.40 Record) to the South line of the North Half of said Northwest Quarter; thence North 88°41'22" East along said South line 85.14 feet (Record) to the Southeast corner of said North Half; thence South 00°09'11" East along the East line of said Northwest Quarter 1317.11 feet (1313.40 Record) to the Southeast corner of said Northwest Quarter; thence South 88°43'15" West along the South line of said Northwest Quarter 2524.76 feet to a point 180.00 feet (Record) East of the Southwest corner of said Northwest Quarter; thence North 17°59'45" West 472.66 feet (472.60 Record); thence South 89°09'01" West perpendicular to the West line of said Northwest Quarter 40.65 feet to said West line; thence North 00°50'59" West along said West line 2177.81 feet to the point of beginning, containing **160.250 Acres**, subject to road right of way easements across the West and North 33.00 feet thereof and any other easements or restrictions of record.

SURVEYOR'S NOTES:

- 1) No evidence of the 5/8" rebar referenced by Doug Rathbun on 8/16/1993 or evidence of reference ties which are on file at McPherson County Public Works, other than the crop line North. Corner considered lost. Reset at the midpoint and online between the NW and NE corners as per (PS). Reset position agrees with the 1.73 chains distance West to the hedge row South referenced on (PS).
- 2) Corner falls 60' East of the North South hedge row, similar to the position shown on (PS).

SURVEYOR'S CERTIFICATE:

I hereby certify this plat to be a true, correct and complete representation of the property described hereon, as surveyed under my supervision, this 15th day of November, 2013.

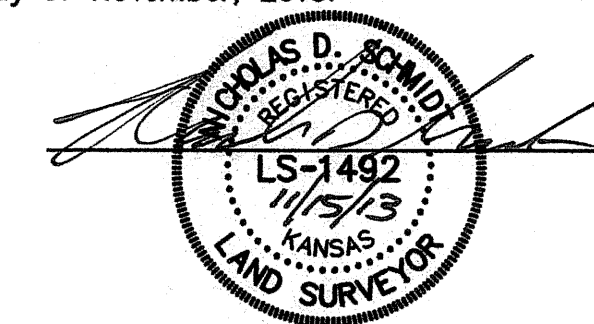

Prepared For:

AGGIE REICHERT

Description:

A PORTION OF THE NW 1/4
SECTION 13, T20S, R3W
MCPHERSON COUNTY, KANSAS

Prepared By:

CSS

HUTCHINSON (Main Office) 2908 North Plum St. 67502 Ph. 620-665-7032 Fax: 620-663-7401

MCPHERSON (Branch Office) 115 East Main St. 67460 Ph. 620-241-4441 Fax: 620-241-4558

NEWTON (Branch Office) 511 North Poplar St. 67114 Ph. 316-283-5053 Fax: 316-283-4073

Garber Surveying Service, P.A.

Drawn By: CSS

Checked By: NDS

Scale: 1"=200'

Date: 11/15/2013

Date of Field Work: October 22, 2013

Sheet 1 of 1 Sheet(s)

Job No:

G2013-645

Saved 11/15/2013 1:58:53 PM by CSWANEY
Plot Date & Time Friday, November 15, 2013 1:59:07 PM Dwa Path \\Fs2\company\DD\GSSEIES\2013\20130645 CSA\wva\20130645 Auto S Ground