

BASIS OF BEARING = KANSAS STATE PLANE ZONE 1502

LEGEND

- △ - Sectional Monument Found
- ▲ - Section Monument Set (5/8" x 24" Iron Rebar w/G.S.S. Cap)
- - 5/8" x 24" Iron Rebar Set w/G.S.S. Cap
- (C) - Calculated
- (M) - Measured
- (GLO) - General Land Office

DESCRIPTION:

The Northwest Quarter of the Northeast Quarter AND the North Half of the Northeast Quarter of the Northeast Quarter of Section 5, Township 20 South, Range 2 West of the 6th Principal Meridian, McPherson County, Kansas, containing **67.365 Acres**, subject to road right-of-way easements across the North and East 33.00 feet thereof and any other easements or restrictions of record.

SURVEYOR'S NOTES:

1) There was no previous record of the spike being set at the SE corner of the NE 1/4, however, the monument fell in line with the Elm tree row to the West and the Hedge row to the East. The single proportion calculation fell 32.62 feet North of the spike; therefore, I accepted the found spike since its relative position to the existing physical evidence was similar to the found monuments at the remaining 1/4 corners in this section.

SURVEYOR'S CERTIFICATE:

I hereby certify this plat to be a true, correct and complete representation of the property described hereon, as surveyed under my supervision, this 16th day of September, 2013.

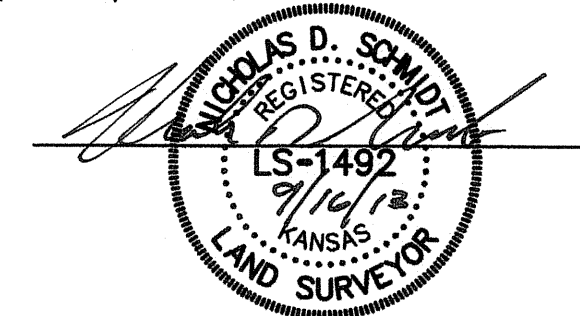

Prepared For:	KENT VORAN			Description:	A PORTION OF THE NE 1/4 SECTION 5, T20S, R2W McPHERSON COUNTY, KANSAS		
Prepared By:	Garber Surveying Service, P.A.						
GSS		HUTCHINSON (Main Office) 2908 North Plum St. 67502 Ph. 620-665-7032 Fax 620-663-7401		McPHERSON (Branch Office) 115 East Marlin 67460 Ph. 620-241-4441 Fax 620-241-4458		NEWTON (Branch Office) 511 North Poplar St. 67114 Ph. 316-283-5053 Fax 316-283-5073	
Drawn By:	JAK	Scale:	1"= 300'	Date of Field Work:	September 12, 2013	Job No:	
Checked By:	NDS	Date:	09/16/2013	Sheet	1 of 1 Sheet(s)		G2013-526