

LEGEND

- △ - Sectional Monument Found
- ▲ - Section Monument Set (5/8" x 24" Iron Rebar w/GSS CLS 52 Cap)
- - Fd. 5/8" Rebar
- - 5/8" x 24" Iron Rebar Set w/GSS CLS 52 Cap
- (C) - Calculated
- (M) - Measured
- (PS) - Previous Survey GSS Project #685-136
- (R) - Record measurement
- P.O.B. - Point of Beginning
- P.O.C. - Point of Commencement

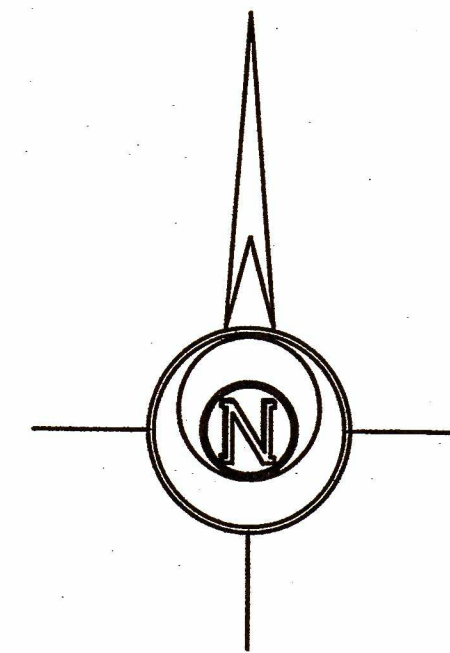

-200 0 200 400 600

BASIS OF BEARING = NAD 83 KANSAS SOUTH ZONE

DESCRIPTION:

TRACT 1

A portion of the Northwest Quarter of Section 20, Township 20 South, Range 2 West of the 6th Principal Meridian, McPherson County, Kansas, described as follows by Nicholas D. Schmidt, PS #1492, this 7th day of November, 2022:

Beginning at the Northwest corner of said Northwest Quarter; thence on a NAD 83 Kansas South Zone bearing of North 88°24'42" East on the North line of said Northwest Quarter a distance of 2642.63 feet to the Northeast corner of said Northwest Quarter; thence South 00°50'24" East on the East line of said Northwest Quarter a distance of 2596.33 feet to the Southeast corner of said Northwest Quarter; thence South 89°09'25" West on the South line of said Northwest Quarter a distance of 2102.58 feet to the Southeast corner of a parcel described in Book 668, Page 6724 at the McPherson County Register of Deeds Office; thence North 42°09'33" East on the East line of said parcel a distance of 103.23 feet (102.63 Record); thence North 89°09'25" East departing said East line a distance of 408.44 feet; thence North 00°50'43" West parallel with the West line of said Northwest Quarter a distance of 856.60 feet to the centerline of Running Turkey Creek; thence along said centerline for the following 10 courses:

North 73°38'10" West a distance of 153.72 feet;
South 78°10'32" West a distance of 110.63 feet;
North 79°05'37" West a distance of 98.00 feet;
North 60°35'41" West a distance of 287.95 feet;
North 21°13'27" West a distance of 261.04 feet;
North 49°54'26" West a distance of 78.19 feet;
South 85°18'55" West a distance of 160.02 feet;
South 25°01'35" West a distance of 52.28 feet;
South 03°39'43" East a distance of 54.32 feet;
South 19°10'18" West a distance of 258.70 feet to said West line; thence North 00°50'43" West on said West line a distance of 1499.62 feet to the point of beginning.

Containing 130.76 Acres and subject to road right of way easements along the West and North lines thereof, and any other easements or restrictions of record.

TRACT 2

A portion of the Northwest Quarter of Section 20, Township 20 South, Range 2 West of the 6th Principal Meridian, McPherson County, Kansas, described as follows by Nicholas D. Schmidt, PS #1492, this 7th day of November, 2022:

Commencing at the Southwest corner of said Northwest Quarter; thence on a NAD 83 Kansas South Zone bearing of North 00°50'43" West on the West line of said Northwest Quarter a distance of 770.00 feet (Record) to the Northwest corner of a parcel described in Book 668, Page 6724 at the McPherson County Register of Deeds Office, being the point of beginning; thence continuing North 00°50'43" West on said West line a distance of 292.34 feet to the centerline of Running Turkey Creek; thence along said centerline for the following 10 courses:

North 19°10'18" East a distance of 258.70 feet;
North 03°39'43" West a distance of 54.32 feet;
North 25°01'35" East a distance of 52.28 feet;
North 85°18'55" East a distance of 160.02 feet;
South 49°54'26" East a distance of 78.19 feet;
South 21°13'27" East a distance of 261.04 feet;
South 60°35'41" East a distance of 287.95 feet;
South 79°05'37" East a distance of 98.00 feet;
North 78°10'32" East a distance of 110.63 feet;
South 73°38'10" East a distance of 153.72 feet; thence South 00°50'43" East parallel with said West line a distance of 856.60 feet; thence South 89°09'25" West a distance of 408.44 feet to the East line of said parcel; thence North 00°50'43" West on said East line a distance of 695.00 feet (Record) to the Northeast corner of said parcel; thence South 89°06'38" West on the North line of said parcel a distance of 610.00 feet (Record) to the point of beginning.

Containing 14.96 Acres and subject to a road right of way easement along the West line thereof, and any other easements or restrictions of record.

SURVEYOR'S CERTIFICATE:

I hereby certify this plat to be a true, correct and complete representation of the property described hereon, as surveyed under my supervision, this 11th day of November, 2022.

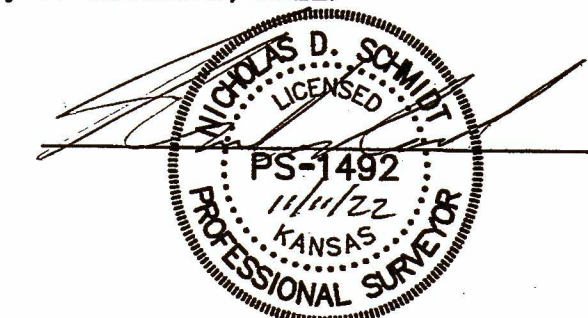

LINE TABLE		
LINE NUMBER	BEARING	DISTANCE
L1	N 00°50'43" W	292.34 (M)
L2	N 19°10'18" E	258.70 (M)
L3	N 03°39'43" W	54.32 (M)
L4	N 25°01'35" E	52.28 (M)
L5	N 85°18'55" E	160.02 (M)
L6	S 49°54'26" E	78.19 (M)
L7	S 21°13'27" E	261.04 (M)
L8	S 60°35'41" E	287.95 (M)
L9	S 79°05'37" E	98.00 (M)
L10	N 78°10'32" E	110.63 (M)
L11	S 73°38'10" E	153.72 (M)

SURVEYOR'S NOTE:

- Survey was made as per client request and no title work has been provided to the surveyor; therefore, the number and extent of easements and/or rights-of-way of record affecting said property has not been verified by this Survey.

Prepared For:	MICHAEL ISAACS			Description:	A PORTION OF THE NW 1/4 SECTION 20, T20S, R2W McPHERSON COUNTY, KANSAS		
Prepared By:	GSS HUTCHINSON 2908 North Plum St. 67502 Ph. 620-665-7032 (Main Office)			BRANCH OFFICES:	MANHATTAN Ph. 785-320-4810 MCPHERSON Ph. 620-241-4441 NEWTON Ph. 316-283-5053 SALINA Ph. 785-404-6302 WICHITA Ph. 316-260-9933		
Drawn By:	KDZ	Scale:	1"=200'	Date of Field Work:	October 25, 2022	Job No:	G2022-897
Checked By:	NDS	Date:	11/11/2022	Sheet	1 of 1 Sheet(s)		