

SURVEYOR'S CERTIFICATE:

I hereby certify this plat to be a true, correct and complete representation of the property described hereon, as surveyed under my supervision, this 23rd day of September, 2016.

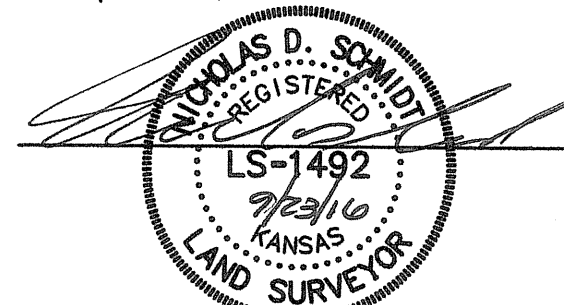

LEGEND

- △ - Sectional Monument Found
- ▲ - Section Monument Set (5/8" x 24" Rebar w/G.S.S. Cap)
- - 5/8" x 24" Iron Rebar Set w/G.S.S. Cap
- ⊙ - 5/8" x 24" Rebar Set w/GSS Blue Cap
- (C) - Calculated
- (M) - Measured
- (PS) - Previous Survey GSS Proj. G2016-190
- (GLO) - General Land Office
- P.O.B. - Point of Beginning
- P.O.C. - Point of Commencement

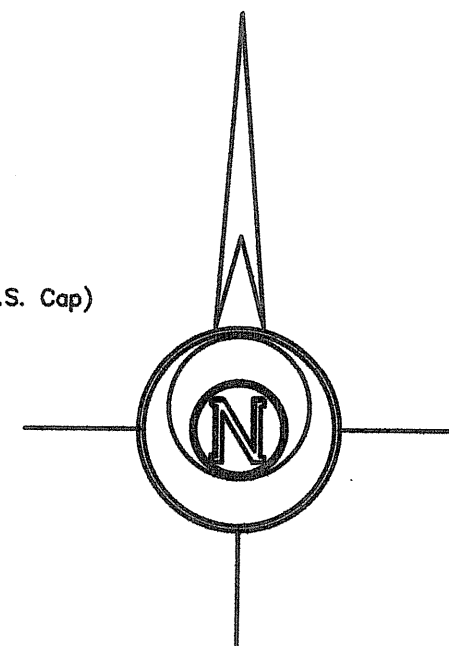

BASIS OF BEARING = NAD 83 KANSAS SOUTH ZONE

DESCRIPTIONS:
PARCEL 1

A portion of the Southwest Quarter of Section 34, Township 20 South, Range 1 West of the 6th Principal Meridian, McPherson County, Kansas described as follows:

Beginning at the Northwest corner of said Southwest Quarter; thence on a NAD 83 Kansas South Zone bearing of North 89°17'53" East on the North line of said Southwest Quarter a distance of 539.96 feet; thence South 00°05'44" East parallel with the West line of said Southwest Quarter a distance of 484.07 feet; thence South 89°17'53" West parallel with said North line a distance of 539.96 feet to said West line; thence North 00°05'44" West on said West line a distance of 484.07 feet to the point of beginning.

Containing 6.000 Acres and subject to a road right of way easement across the West 50.00 feet thereof and any other easements or restrictions of record.

PARCEL 2

A portion of the Southwest Quarter of Section 34, Township 20 South, Range 1 West of the 6th Principal Meridian, McPherson County, Kansas described as follows:

Commencing at the Northwest corner of said Southwest Quarter; thence on a NAD 83 Kansas South Zone bearing of North 89°17'53" East on the North line of said Southwest Quarter a distance of 539.96 feet to the point of beginning; thence continuing North 89°17'53" East on said North line a distance of 1255.75 feet; thence South 00°34'17" East a distance of 2354.75 feet; thence South 20°05'44" West a distance of 333.76 feet to the South line of said Southwest Quarter; thence South 89°19'28" West on said South line a distance of 1700.06 feet to the Southwest corner of said Southwest Quarter; thence North 00°05'44" West on the West line of said Southwest Quarter a distance of 2182.04 feet; thence North 89°17'53" East parallel with said North line a distance of 539.96 feet; thence North 00°05'44" West parallel with said West line a distance of 484.07 feet to the point of beginning.

Containing 104.174 Acres and subject to any easements or restrictions of record.

PARCEL 3

A portion of the Southwest Quarter of Section 34, Township 20 South, Range 1 West of the 6th Principal Meridian, McPherson County, Kansas described as follows:

Commencing at the Northwest corner of said Southwest Quarter; thence on a NAD 83 Kansas South Zone bearing of North 89°17'53" East on the North line of said Southwest Quarter a distance of 2105.74 feet to the point of beginning; thence continuing North 89°17'53" East on said North line a distance of 849.99 feet to the Northeast corner of said Southwest Quarter; thence South 00°08'33" East on the East line of said Southwest Quarter a distance of 2667.32 feet to the Southeast corner of said Southwest Quarter; thence South 89°19'28" West on the South line of said Southwest Quarter a distance of 947.82 feet; thence North 20°05'44" East a distance of 333.76 feet; thence North 00°34'17" West a distance of 2354.74 feet to the point of beginning.

Containing 51.852 Acres and subject to a road right of way easement across the South 33.00 feet thereof and any other easements or restrictions of record.

SURVEYOR'S NOTES:

1. No references of record for corner monument. Searched and dug for GLO monument at apparent corner but did not find. Reset by single proportionate measurement in accordance with the GLO survey. Position matches existing physical evidence of centerline of hedge row North and in centerline of East/West road.

Prepared For:		Description:	
GARETH N. SCHMIDT		A PORTION OF THE SW 1/4 SECTION 34, T20S, R1W McPHERSON COUNTY, KS.	
Prepared By:		Garber Surveying Service, P.A.	
GSS		HUTCHINSON (Main Office) 2908 North Plum St. 67502 Ph. 620-665-7032 Fax 620-663-7401 McPHERSON (Branch Office) 115 East Marlin 67460 Ph. 620-241-4441 Fax 620-241-4458 NEWTON (Branch Office) 511 North Poplar St. 67114 Ph. 316-283-5053 Fax 316-283-5073	
Drawn By: AL	Scale: 1"=300'	Date of Field Work: 9/20/2016	Job No:
Checked By: NDS	Date: 9/23/2016	Sheet 1 of 1 Sheet(s)	G2016-606