

Laurie B. Wolden, Register of Deeds
McPherson County, Kansas
Book: 668 Page: 59892
Receipt #: 236290 Total Fees: \$21.00
Pages Recorded: 1
Clerk Initials: Sheila
Data Recorded: 5/30/2025 3:45:23 PM

DESCRIPTION:
PARCEL 1:

A portion of the Southwest Quarter of Section 32, Township 20 South, Range 1 West of the 6th Principal Meridian, McPherson County, Kansas, more particularly described by Daniel E. Garber, Professional Surveyor #683, on April 18, 2025 as follows:
Beginning at the Southwest corner of the Southwest Quarter of Section 32, Township 20 South, Range 1 West of the 6th Principal Meridian; Thence with a bearing of North 00°15'09" East (basis of bearings is NAD 83 Kansas South Zone) along the West line of said Southwest Quarter a distance of 1,319.73 feet to the Northwest corner of the South Half of said Southwest Quarter; Thence North 89°22'24" East along the North line of the South Half of said Southwest Quarter a distance of 1,391.45 feet (said point being 1,256.61 feet West of the Northeast corner of the South Half of said Southwest Quarter); Thence South 00°33'23" East a distance of 827.39 feet; Thence South 89°17'54" West a distance of 550.00 feet; Thence South 89°19'00" West a distance of 200.53 feet; Thence North 45°00'59" West a distance of 141.47 feet; Thence South 89°19'31" West a distance of 186.58 feet; Thence South 00°47'19" East a distance of 178.49 feet; Thence South 44°59'55" East a distance of 29.98 feet; Thence South 00°50'37" East a distance of 391.79 feet to the South line of said Southwest Quarter; Thence South 89°18'10" West along the South line of said Southwest Quarter a distance of 397.57 feet to the point of beginning, containing **30.402 Acres**, and subject to road right-of-way easements across the South and West 33.00 feet thereof and any other easements and restrictions of record.

PARCEL 2:

A portion of the Southwest Quarter of Section 32, Township 20 South, Range 1 West of the 6th Principal Meridian, McPherson County, Kansas, more particularly described by Daniel E. Garber, Professional Surveyor #683, on April 18, 2025 as follows:
Beginning at the Southeast corner of the Southwest Quarter of Section 32, Township 20 South, Range 1 West of the 6th Principal Meridian; Thence with a bearing of South 89°18'10" West (basis of bearings is NAD 83 Kansas South Zone) along the South line of said Southwest Quarter a distance of 1,789.31 feet (said point being 862.53 feet East of the Southwest corner of said Southwest Quarter); Thence North 00°50'29" West a distance of 490.40 feet; Thence North 89°17'54" East a distance of 550.00 feet; Thence North 00°33'23" West a distance of 827.39 feet to the North line of the South Half of said Southwest Quarter; Thence North 89°22'24" East along the North line of the South Half of said Southwest Quarter a distance of 1,256.61 feet to the Northeast corner of the South Half of said Southwest Quarter; Thence South 00°50'27" West along the East line of said Southwest Quarter a distance of 1,316.40 feet to the point of beginning, containing **43.948 Acres**, and subject to a road right-of-way easement across the South 33.00 feet thereof and any other easements and restrictions of record.

COUNTY PLANNING AND ZONING CERTIFICATE:

I, Jon Kinsey, Zoning Administrator of McPherson County, Kansas, do hereby certify under the authority granted me by the McPherson County, Kansas Board of Commissioners that the lot split or boundary shift to which my signature below is given has been approved as being in conformance with the provisions of the McPherson County Zoning and Subdivision Regulations. Given under my hand this 30th day of May, 2025.

Jon Kinsey, Zoning Administrator

SURVEYOR'S CERTIFICATE:

I hereby certify this plat to be a true, correct and complete representation of the property described herein, as surveyed under my supervision, this 14th day of May, 2025.

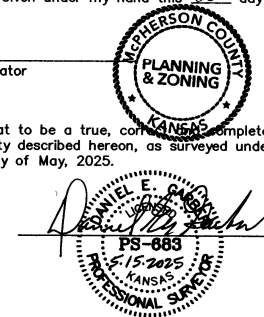

| | |
|--|--|
| Prepared For: | Description: |
| CHRISTINE REINERT | A PORTION OF THE SW 1/4 SECTION 32, T20S, R1W MCPHERSON COUNTY, KANSAS |
| Prepared By: | Garber Surveying Service, P.A. |
| GSS HUTCHINSON 2908 North Plum St. 67502 Ph. 620-665-7032 (Main Office) | BRANCH OFFICES: MANHATTAN Ph. 785-320-4810 MCPHERSON Ph. 620-241-4441 NEWTON Ph. 316-283-5853 SALINA Ph. 785-404-6302 WICHITA Ph. 316-260-9933 |
| Drawn By: KLL | Scale: 1"=200' |
| Checked By: DEG | Date: 04/22/2025 |
| Date of Field Work: April 3, 2025 | Job No: G2025-187 |
| Sheet 1 of 1 Sheet(s) | |