

Saved 5/27/2014 7:57:25 AM by KLOUTZEN
Plot Date & Time Tuesday, May 27, 2014 7:57:34 AM Dwg Path \\Fs2\company\LOD\GSSFILES\2014\20140349 03.dwg\20140349 Auto S Ground

25th AVENUE

N 00°15'15" E 2639.54 (PS)(M)

33' R/W Line

NW Cor. NW 1/4
Sec. 32, T20S, R1W
Fd. 5/8" Rebar w/Sickmon Cap (PS)

P.O.B. 1

N 89°22'18" E 1416.00 (C)

CIMARRON ROAD

N 89°22'18" E 2636.77 (PS)(M)

NE Cor. NW 1/4
Sec. 32, T20S, R1W
Fd. 5/8" Rebar (PS)

P.O.B. 2

N 89°22'18" E 1220.77 (C)

PARCEL 2
24.159 Acres

S 00°37'42" E 342.38 (C)

33.00 (M)

121.4

128.2

136.2

144.2

152.2

160.2

168.2

176.2

184.2

192.2

200.2

208.2

216.2

224.2

232.2

240.2

248.2

256.2

264.2

272.2

280.2

288.2

296.2

304.2

312.2

320.2

328.2

336.2

344.2

352.2

360.2

368.2

376.2

384.2

392.2

400.2

408.2

416.2

424.2

432.2

440.2

448.2

456.2

464.2

472.2

480.2

488.2

SW Cor. NW 1/4
Sec. 32, T20S, R1W
Fd. 5/8" Rebar w/GSS Cap

S 89°26'37" W 1914.02 (M)

N 89°26'37" E 2644.25 (PS)(M)

SE Cor. NW 1/4
Sec. 32, T20S, R1W
Fd. 5/8" Rebar w/GSS Cap (PS)

S 89°26'37" W 730.23 (M)

S 00°05'27" W 2642.75 (PS)(M)

2609.75 (M)

S 00°41'18" W 522.54 (M)

S 53°25'42" W 151.77 (M)

S 01°04'49" W 520.90 (M)

S 52°17'08" W 119.82 (M)

S 00°38'03" W 385.72 (M)

S 75°15'20" W 85.80 (M)

S 00°42'33" W 279.84 (M)

S 39°33'29" W 534.74 (M)

- LEGEND
- △ - Sectional Monument Found
 - - Survey Monument Found
 - - 5/8" x 24" Iron Rebar Set w/G.S.S. Cap
 - (C) - Calculated
 - (M) - Measured
 - (PS) - Previous Survey G2014-294

-200 0 200 400 600

DESCRIPTION:

BASIS OF BEARING = NAD 83 KANSAS ZONE 1502

PARCEL 1

A portion of the Northwest Quarter of Section 32, Township 20 South, Range 1 West of the 6th Principal Meridian, McPherson County, Kansas described as follows:

Beginning at the Northwest corner of the Northwest Quarter of Section 32, Township 20 South, Range 1 West of the 6th Principal Meridian; thence on a NAD 83 Kansas Zone 1502 bearing of North 89°22'18" East along the North line of said Northwest Quarter 1416.00 feet; thence South 00°37'42" East perpendicular to said North line 342.38 feet; thence North 89°22'18" East parallel with said North line 1146.66 feet; thence South 00°41'18" West 522.54 feet; thence South 53°25'42" West 151.77 feet; thence South 01°04'49" West 520.90 feet; thence South 52°17'08" West 119.82 feet; thence South 00°38'03" West 385.72 feet; thence South 75°15'20" West 85.80 feet; thence South 00°42'33" West 279.84 feet; thence South 39°33'29" West 534.74 feet to the South line of said Northwest Quarter; thence South 89°26'37" West along said South line 1914.02 feet to the Southwest corner of said Northwest Quarter; thence North 00°15'15" East along the West line of said Northwest Quarter 2639.54 feet to the point of beginning, containing 135.925 Acres, subject to road right of way easements across the West and North 33.00 feet thereof and any other easements or restrictions of record.

PARCEL 2

A portion of the Northwest Quarter of Section 32, Township 20 South, Range 1 West of the 6th Principal Meridian, McPherson County, Kansas described as follows:

Beginning at the Northeast corner of the Northwest Quarter of Section 32, Township 20 South, Range 1 West of the 6th Principal Meridian; thence on a NAD 83 Kansas Zone 1502 bearing of South 00°05'27" West along the East line of said Northwest Quarter 2642.75 feet to the Southeast corner of said Northwest Quarter; thence South 89°26'37" West along the South line of said Northwest Quarter 730.23 feet to a point 1914.02 East of the Southwest corner of said Northwest Quarter; thence North 39°33'29" East 534.74 feet; thence North 00°42'33" East 279.84 feet; thence North 75°15'20" East 85.80 feet; thence North 00°38'03" East 385.72 feet; thence North 52°17'08" East 119.82 feet; thence North 01°04'49" East 520.90 feet; thence North 53°25'42" East 151.77 feet; thence North 00°41'18" East 522.54 feet; thence South 89°22'18" West parallel with the North line of said Northwest Quarter 1146.66 feet; thence North 00°37'42" West perpendicular to said North line 342.38 feet to a point on said North line, said point being 1416.00 feet East of the Northwest corner of said Northwest Quarter; thence North 89°22'18" East along said North line 1220.77 feet to the point of beginning, containing 24.159 Acres, subject to a road right of way easement across the North 33.00 feet thereof and any other easements or restrictions of record.

SURVEYOR'S CERTIFICATE:

I hereby certify this plat to be a true, correct and complete representation of the property described hereon, as surveyed under my supervision, this 27th day of May, 2014.

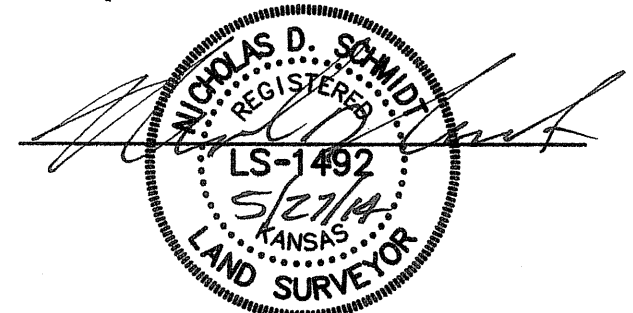

| | | | |
|--|------------------|--|-------------------|
| Prepared For: TY KAUFMAN | | Description: PORTIONS OF THE NW 1/4 SECTION 32, T20S, R1W McPHERSON COUNTY, KANSAS | |
| Prepared By: GSS | | Garber Surveying Service, P.A. | |
| HUTCHINSON (Main Office) 2908 North Plum St. 67502 Ph. 620-665-7032 Fax 620-663-7401 | | McPHERSON (Branch Office) 115 East Marlin 67460 Ph. 620-241-4441 Fax 620-241-4458 | |
| NEWTON (Branch Office) 511 North Poplar St. 67114 Ph. 316-283-5053 Fax 316-283-5073 | | | |
| Drawn By: KLL | Scale: 1"=200' | Date of Field Work: May 20, 2014 | Job No: G2014-349 |
| Checked By: NDS | Date: 05/27/2014 | Sheet 1 of 1 Sheet(s) | |