





▲ - Sectional Monument Found
 △ - Section Monument Set (5/8" x 24" Iron Rebar w/G.S.S. Cap)
 ○ - Survey Monument Found
 ● - 5/8" x 24" Iron Rebar Set w/G.S.S. Cap
 (C) - Calculated
 (M) - Measured
 (PS) - Previous Survey By LS 1373 (8/13/08)
 (GLO) - General Land Office
 P.O.B. - Point of Beginning
 P.O.C. - Point of Commencement

A portion of the North Half of the Southwest Quarter of Section 18,
Township 20 South, Range 1 West of the 6th Principal Meridian,
McPherson County, Kansas described as follows:

Containing **26.820 Acres** and subject to any easements or restrictions of record.

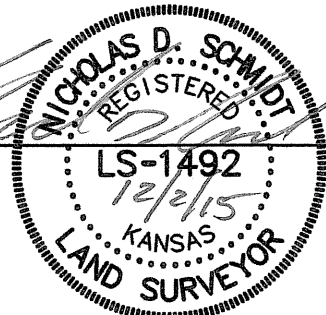
I hereby certify this plat to be a true, correct and complete representation of the property described hereon, as surveyed under my supervision, this 2nd day of December, 2015.



Prepared For: ARLYN NIGHTINGALE		Description: A PORTION OF THE N 1/2 OF THE SW 1/4 OF SECTION 18, T20S, R1W MCPHERSON COUNTY, KANSAS	
Prepared By:  HUTCHINSON (Main Office) 2908 North Plum St. 67502 Ph. 620-665-7032 Fax: 620-663-7401 MCPHERSON (Branch Office) 1115 East Marlin 67602 Ph. 620-241-4441 Fax: 620-241-4458 NEWTON (Branch Office) 511 North Poplar St. 67114 Ph. 316-283-5053 Fax: 316-283-5073		Garber Surveying Service, P.A.	
Drawn by: KLL		Scale: 1"=100	
Checked by: NDS		Date of Field Work: April 23, 2015	
Date: 12/02/2015		Sheet 1 of 1 Sheet(s)	
		Job No: G2015-285	