

- ## LEGEND
- | | | |
|--------|---|--|
| △ | - | Sectional Monument Found |
| ○ | - | Survey Monument Found |
| ● | - | 5/8" x 24" Iron Rebar Set w/GSS CLS 52 Cap |
| (C) | - | Calculated |
| (M) | - | Measured |
| (M1) | - | Record measurement Bk. 639, Pg. 7280 and Bk. 121, Pg. 175 |
| (M2) | - | Record measurement Probate Case No. 424 (8/23/1971) and Bk. 128, Pg. 255 |
| (PS) | - | Previous Survey GSS Project #G2023-673 |
| (PS1) | - | Previous Survey by H.A. Rowland 9/27/1947 |
| (PS2) | - | Previous Survey GSS Project #G01-885 |
| P.O.B. | - | Point of Beginning |

DESCRIPTIONS:

TRACT 1

A portion of the Southeast Quarter and a portion of the Northeast Quarter of Section 7, Township 19 South, Range 5 West of the 6th Principal Meridian, McPherson County, Kansas, described as follows by Nicholas D. Schmidt, PS #1492, this 5th day of October, 2023:

Beginning at the Southeast corner of said Southeast Quarter; thence on a NAD 83 Kansas South Zone bearing of North 89°36'37" West on the South line of said Southeast Quarter a distance of 2625.15 feet to the Southwest corner of said Southeast Quarter; thence North 00°23'38" West on the West line of said Southwest Quarter a distance of 2744.29 feet to the Northwest corner of said Southeast Quarter; thence North 00°23'34" West on the West line of said Northeast Quarter a distance of 1264.23 feet to the South line of the North 83.6° Acres (Record) of the Northeast Quarter; thence South 88°30'17" East on said South line a distance of 2638.00 feet to the East line of said Northeast Quarter; thence South 00°28'40" East on said East line a distance of 758.23 feet to a point 521.46 feet North of the Southeast corner of said Northeast Quarter; thence North 88°10'10" West parallel with the South line of said Northeast Quarter a distance of 552.51 feet; thence South 00°28'40" East parallel with the East line of said a distance of 552.34 feet to a point 30.87 feet South of said South line; thence South 88°10'13" East parallel with said South line a distance of 552.34 feet to the East line of said Southeast Quarter; thence South 00°09'58" East on said East line a distance of 2847.01 feet to the point of beginning.

Containing **233.64 Acres** and subject to road right of way easements along the South and East lines thereof, and any other easements or restrictions of record.

TRACT 2

A portion of the Southeast Quarter and a portion of the Northeast Quarter of Section 7, Township 19 South, Range 5 West of the 6th Principal Meridian, McPherson County, Kansas, described as follows by Nicholas D. Schmidt, PS #1492, this 5th day of October, 2023:

Beginning at the Northeast corner of said Southeast Quarter; thence on a NAD 83 Kansas South Zone bearing of South 00°09'58" East on the East line of said Southeast Quarter a distance of 30.87 feet; thence North 88°10'13" West parallel with the South line of said Northeast Quarter a distance of 552.34 feet; thence North 00°28'40" West parallel with East line of said Northeast Quarter a distance of 552.34 feet; thence South 88°10'13" East parallel with said South line a distance of 552.51 feet to the East line of said Northeast Quarter; thence South 00°28'40" East on said East line a distance of 521.46 feet to the point of beginning.

Containing **7.00 Acres** and subject to a road right of way easement along the East line thereof, and any other ~~assessments~~ easements or restrictions of record.

SURVEYOR'S CERTIFICATE:

I hereby certify this plat to be a true, correct and complete representation of the property described hereon, as surveyed under my supervision, this 5th day of October, 2023.

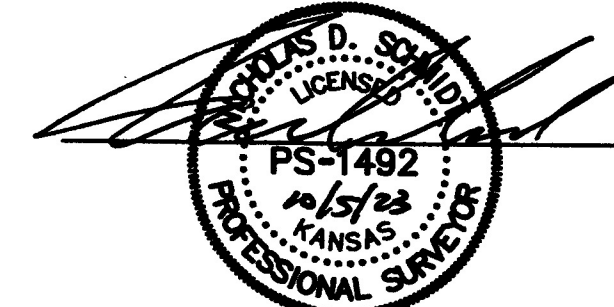

Prepared For: FOUR SEASONS REALTY		Description: A PORTION OF THE E 1/2 SECTION 7, T19S, R4W, McPHERSON COUNTY, KANSAS	
Prepared By: Garber Surveying Service, P.A.			
 HUTCHINSON 2908 North Plum St. #7502 Ft. 620-665-7832 (Main Office)		BRANCH OFFICES: MANHATTAN, PA. 785-328-4810 McPHERSON, PA. 620-241-4441 SALINA, PA. 785-404-6302 WICHITA, PA. 316-268-9933	
Drawn By: KDZ	Scale: 1"=300'	Date of Field Work: September 20, 2023	Job No: G2023-746
Checked By: NDS	Date: 10/05/2023	Sheet 1 of 1 Sheet(s)	