

NW Corner
33-19S-4W
2" Metal Cap Found

1433.72 (M), 1433.63 (P)
S 00°-00'-00" E (ASSUMED)
S 00°-00'-00" E (P)

Scale: 1" = 400'



Fence is located
outside property

892.32' (P) *

670.81' (M), 671.11 (P)
S 89°-58'-57" W (M)
N 89°-59'-34" W (P)

412.71' (M), 412.43 (P)
N 87°-11'-35" W (M)
N 87°-11'-50" W (P)

168.09' (M), 167.95 (P)
N 00°-08'-52" W (M)
N 00°-10'-40" W (P)

111.87' (M), 112.50 (P)
N 18°-08'-12" W (M)
N 18°-08'-55" W (P)

316.58' (M), 316.77 (P)
N 82°-37'-24" W (M)
N 82°-37'-15" W (P)

1,147.25 (M), 1,146.72 (P)
N 88°-09'-42" E (ASSUMED)
N 88°-07'-57" E (P)

82.18' (M)
S 01°-22'-42" W (ASSUMED)
S 01°-23'-00" W (P)

1,481.82 (M)
S 89°-46'-02" E (M)

S. Line of N 1/2, NW 1/4

S. Line of N 1/2, NE 1/4

21.07 (M & P)
N 89°-51'-19" W (M)
N 89°-50'-35" W (P)

N 1/4 Corner
33-19S-4W
2" Metal Cap Found

40' X 64' Metal Building

2,623.54

N 89°-50'-10" W

NE Corner
33-19S-4W
5/8" Rebar Found

30' County Road
Right-of-way

Area 30' Back from Ditch
Subject to Agreement (Volume Misc. 239, Page 335)

1,312.88
N 00°-28'-01" W

W 1/4 Corner
33-19S-4W
1/2" Rebar Found

Center
33-19S-4W
Not Found

E 1/4 Corner
33-19S-4W
Not Found

SE Corner
33-19S-4W
Not Found

EXCEPTIONS LISTED IN TITLE POLICY NOT SHOWN ON SURVEY:

- Item # 13: Document not legible
Item # 14 thru 18: These are blanket grants and cover entire property.
* Item # 20 - 22: These are blanket grants and cover entire property.
Item # 19: Ditch mentioned in document is outside property.

SW Corner
33-19S-4W
1/2" Rebar Found

S 1/4 Corner
33-19S-4W
Not Found

GENERAL NOTES:

- METAL BUILDING AREA = 2,560 S.F. (Outside), more or less
- LAND AREA = 102.9 Acres, More or Less
- Property is located in Zone 'C' according to FIRM PANEL NO.: 200214 0200 B for McPherson County, Kansas.

Theoretical location of this corner was established by measurements taken from previous county survey.

LEGAL DESCRIPTION:

North Half of the Northeast Quarter (N1/2, NE 1/4)

AND

North Half of the Northwest Quarter (N1/2, NW 1/4), Except the following described property: That part of the following described property lying within the N1/2 of the NW 1/4:

Beginning at the Northwest corner of Section 33; Thence South 1433.63 feet; Thence North 88°-07'-57" East, 1146.72 feet; Thence North 01°-23'-00" East, 892.32 feet; Thence South 89°-59'-34" East, 671.11 feet; Thence South 00°-10'-40" East, 167.95 feet; Thence South 87°-11'-50" East, 412.43 feet; Thence South 18°-08'-55" East, 112.50 feet; Thence South 82°-37'-15" East, 316.77 feet; Thence North 00°-12'-16" East, 832.62 feet; Thence North 89°-50'-35" West, 2,603.38 feet to the point of beginning.

All in Section 33, Township 19 South, Range 4 West of the 6th P.M., in McPherson County, Kansas.

LEGEND:

- △ Government Corner Found
- Iron/Rebar Found
- 5/8" Rebar Set
- (M) Measured Distance or Bearing
- (P) Record Distance or Bearing
- Existing Fence

TO

Koch Industries, Inc.
McPherson County Abstract & Title Company
Chicago Title Insurance Company

The undersigned hereby certifies that to the best of his professional knowledge, information and belief, this map or plat and the survey on which it is based was made on the date shown below of the premises specifically described in CHICAGO TITLE INSURANCE COMPANY'S Commitment No. 56836, dated October 24, 1997, at 8:00 A.M., and was made (i) in accordance with the "Minimum Standard Detail Requirements and Classifications for ALTA/ACSM Land Title Surveys", jointly established and adopted by ALTA and ACSM in 1992; (ii) pursuant to accuracy standards as adopted by ALTA and ACSM and in effect on the date of this certification of a RURAL survey.

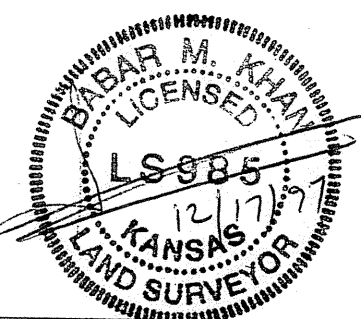

Babar M. Khan, L.S.
Register Land Surveyor No.: 985
In the State of Kansas
Date of Survey: December 17, 1997

* Revised 12-19-97 BCU

SCALE:	APPROVED:	DRAWN BY:
DATE:	CHECKED:	
PROJECT NO:	SHEET NO.:	
97-158 (Municipal)		

ME MUNICIPAL ENGINEERS, P.A.
254-LAURA, SUITE 201
WICHITA, KANSAS 67211
318-282-8842

**ALTA/ACSM SURVEY
FOR
N 1/2, NE 1/4 & PART OF N 1/2, NW 1/4
SECTION 33, TOWNSHIP 19 SOUTH, RANGE 4 WEST
MCPHERSON COUNTY, KANSAS**