

# LEGEND

- Property Line
- Section Line
- Monument Found (Type Specified in Drawing)
- Monument Set (1/2"x24" Rebar w/Yellow Plastic Cap EEI-1332)
- Section Corner
- Measured (M)

## LEGAL DESCRIPTION

South half of the Northwest Quarter (S/2 NW/4) of Section Thirty-two (32), Township Nineteen (19) South, Range Four (4) West of the Sixth Principal Meridian.

## CERTIFICATE OF SURVEY

This is to certify that a boundary survey was conducted by me or under my direct supervision of the premises herein described. The field work on this survey was conducted the day of July 01, 2011. The results of said survey as shown on this survey, to the best of my knowledge, information, belief, and in my professional opinion are true and correct.

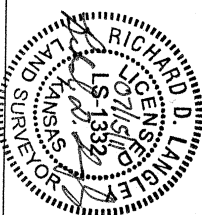

Richard D. Langley  
Kansas L.S. No. 1332  
Earles Engineering & Inspection, Inc.

If the seal on this document is not embossed and the signature of the surveyor is not blue ink, it is a copy of the original document and could contain alterations.