

A tract of land lying in the Southwest Quarter of the Northeast Quarter and the Northwest Quarter of the Southeast Quarter of Section 29, Township 19 South, Range 4 West of the Sixth Principal Meridian, McPherson County, Kansas, said tract of land being a portion of the Kansas and Oklahoma Railroad right of way and being more particularly described as follows:

Beginning at the centerline of Main Street as platted in the Town of Conway, McPherson County, Kansas and the existing north right of way of the Kansas and Oklahoma Railroad right of way, said right of way being 200 feet from the center of the main tracks of said Railroad; thence southeasterly with an included angle of 90° with said centerline of Main Street, 730 feet along said north Railroad right of way; thence southwesterly with an included angle of 90°, 150 feet along the extended west line of East Street, as platted in said Town of Conway, to a point lying 50 feet northeasterly of the center of said main tracks; thence northwesterly with an included angle of 90°, 730 feet parallel with the center of said main tracks; thence northeasterly with an included angle of 90°, 150 feet along the centerline of said Main Street to the Point of Beginning.

I, James C. McClure, a Registered Land Surveyor in the State of Kansas, do hereby certify that a Boundary Survey was completed for the above described property under my direct supervision on March 27, 2015 and that the accompanying plat is a true and correct representation of the survey to the best of my knowledge. This survey shows platted easements only.

Dated this 31ST day of March, 2015

James C. McClure
James C. McClure L.S. 1251
411 N. Webb Road
Wichita, KS 67206
316-684-9600

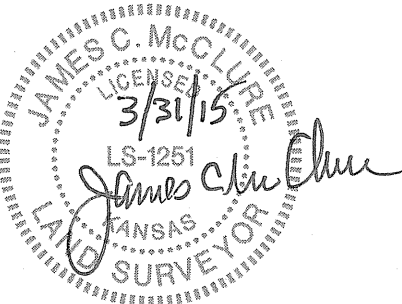

<p>©2015 MKEC Engineering All Rights Reserved www.mkec.com</p> <p>These drawings and their contents, including, but not limited to, all concepts, designs, & ideas are the exclusive property of MKEC Engineering (MKEC), and may not be used or reproduced in any way without the express consent of MKEC.</p>			<p>NCRA - COOP/RAILROAD A tract in the SE/4 Sec 29, T19S, R4W BOUNDARY SURVEY</p>		
INDEX NO. 1401060331		DATE: MARCH 2015		SHEET NO. 1 OF 1	
DRAWN BY: DSN		DESIGNED BY: JCM		APPROVED BY: JCM	