

SURVEYOR'S NOTES:

- Survey was made as per client request and no title work has been provided to the surveyor; therefore, the number and extent of easements and/or rights-of-way of record affecting said property has not been verified by this Survey.
- Origin of found monuments uncertain unless noted.

LEGEND

- △ - Sectional Monument Found
- - Survey Monument Found
- - 5/8" x 24" Iron Rebar Set w/GSS CLS 52 Cap
- (C) - Calculated
- (M) - Measured
- (PL) - Platted
- (R) - Record measurement
- P.O.B. - Point of Beginning
- P.O.C. - Point of Commencement

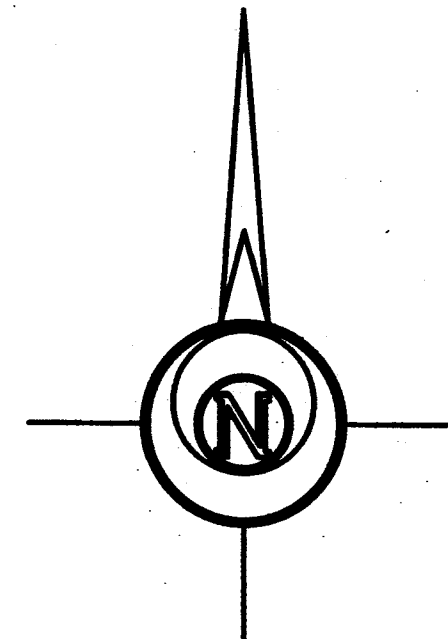

BASIS OF BEARING = NAD 83 KANSAS SOUTH ZONE

DESCRIPTION:

TRACT 1

A portion of the Southwest Quarter of Section 29, Township 19 South, Range 3 West of the 6th Principal Meridian, City of McPherson, McPherson County, Kansas, described as follows by Nicholas D. Schmidt, PS #1492, this 5th day of May, 2022:

Beginning at the Southeast corner of Lot 3, Double T Subdivision in the City of McPherson, McPherson County Kansas; thence on a NAD 83 Kansas South Zone bearing of South 00°25'16" East on the West line of Hickory Street a distance of 287.62 feet; thence South 89°56'03" West a distance of 116.70 feet; thence South 00°42'13" East a distance of 59.79 feet to a point 100.87 feet (100.00 Record) North of the North line of Lincoln Street; thence South 88°08'45" West a distance of 58.26 feet; thence South 89°23'18" West a distance of 274.26 feet; thence North 02°37'28" West a distance of 354.24 feet to the Southwest corner of Lot 1 of said Double T Subdivision; thence South 89°47'09" East on the South line of said Lot 1 a distance of 283.45 feet to the Southwest corner of said Lot 3; thence South 89°50'52" East on the South line of said Lot 3 a distance of 179.10 feet to the point of beginning.

Containing 152,723 Square Feet and subject to any easements or restrictions of record.

TRACT 2

A portion of the Southwest Quarter of Section 29, Township 19 South, Range 3 West of the 6th Principal Meridian, City of McPherson, McPherson County, Kansas, described as follows by Nicholas D. Schmidt, PS #1492, this 5th day of May, 2022:

Commencing at the Southeast corner of Lot 3, Double T Subdivision in the City of McPherson, McPherson County Kansas; thence on a NAD 83 Kansas South Zone bearing of South 00°25'16" East on the West line of Hickory Street a distance of 287.62 feet to the point of beginning; thence South 00°53'40" East continuing on said West line a distance of 59.94 feet to a point 99.98 feet (100.00 Record) North of the North line of Lincoln Street; thence North 89°59'33" West a distance of 116.90 feet; thence North 00°42'13" West a distance of 59.79 feet; thence North 89°56'03" East a distance of 116.70 feet to the point of beginning.

Containing 6,991 Square Feet and subject to any easements or restrictions of record.

SURVEYOR'S CERTIFICATE:

I hereby certify this plat to be a true, correct and complete representation of the property described hereon, as surveyed under my supervision, this 5th day of May, 2022.

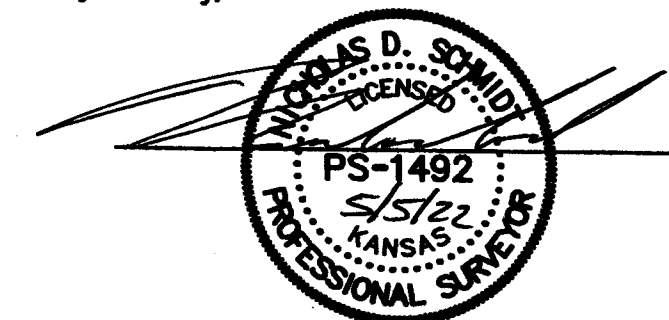

Prepared For: DOUG STRAWN		Description: A PORTION OF THE SW 1/4 SECTION 29, T19S, R3W McPHERSON COUNTY, KANSAS	
Prepared By: GSS HUTCHINSON 2908 North Plum St. 67502 Ph. 620-665-7032 (Main Office)		BRANCH OFFICES: MANHATTAN Ph. 785-320-4810 MCPHERSON Ph. 620-241-4441 NEWTON Ph. 316-283-5053 SALINA Ph. 785-404-6302 WICHITA Ph. 316-260-9933	
Drawn By: KDZ	Scale: 1"=60'	Date of Field Work: April 14, 2022	Job No: G2022-314
Checked By: NDS	Date: 05/05/2022	Sheet 1 of 1 Sheet(s)	