

EASEMENT DESCRIPTION:

A tract of land for sanitary sewer line easement located in Lot 2 Block 1 McPherson Law Enforcement Center Subdivision described as follows: Commencing at the NW corner of said Lot 2, thence along the north line of Lot 2 S89°51'28"E, 148.26'; thence S0°00'00"E, 56.74' to the point of beginning; thence N77°46'04"W, 59.95'; thence N89°51'31"W, 15.00'; thence S00°08'29"E, 7.34'; thence N89°51'31"E, 15.00'; thence S00°08'29"E, 7.98'; thence S77°46'04"E, 59.91'; thence N00°00'00"W, 15.24' to the point of beginning containing 0.02 acres more or less in McPherson County, Kansas. Precision 1:63,115.

Said easement and the accompanying plat are true and correct to the best of my knowledge and belief.

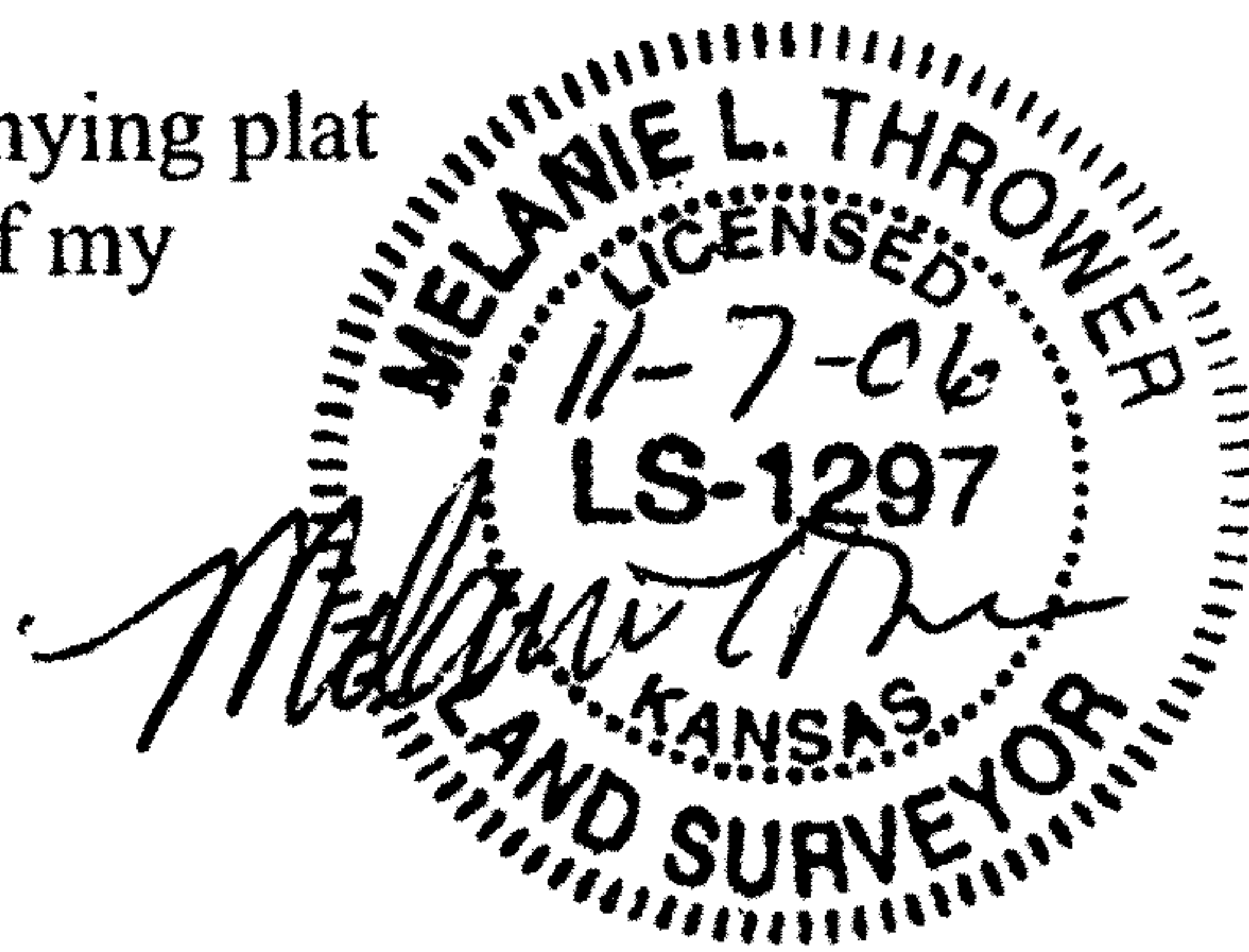

Sewer Easement
Lot 2 Block 1
McPherson Law
Enforcement Center
Subdivision

McPherson Engineering
& Land Surveying Services
PO Box 662
McPherson, KS 67460