

BASIS OF BEARING = NAD 83 KANSAS SOUTH ZONE

LEGEND

- △ - Sectional Monument Found
- - Survey Monument Found
- (C) - Calculated
- (M) - Measured
- (PS) - Previous Survey GSS Project #G2006-679
- (PS1) - Previous Survey GSS Project #G83-84
- P.O.B. - Point of Beginning
- P.O.C. - Point of Commencement

NOTES:

1. Monuments not set on Parcel 2 per client request
2. Parcel 2 will be joined with the adjacent parcel to the West.
3. Survey was made as per client request and no title work has been provided to the surveyor; therefore, the number and extent of easements and/or rights-of-way of record affecting the surveyed property has not been addressed by this survey.

SURVEYOR'S CERTIFICATE:

I hereby certify this plat to be a true, correct and complete representation of the property described hereon, as surveyed under my supervision, this 12th day of June, 2020.

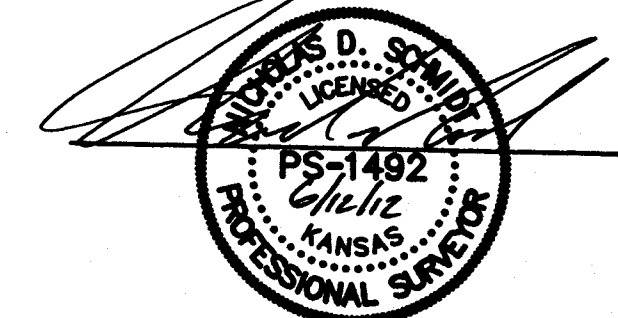

DESCRIPTION:

PARCEL 1

A portion of the Southeast Quarter of Section 24, Township 19 South, Range 3 West of the 6th Principal Meridian, McPherson County, Kansas described as follows:

Commencing at the Southeast corner of said Southeast Quarter; thence on a NAD 83 Kansas South Zone bearing of North 00°39'47" West on the East line of said Southeast Quarter a distance of 957.40 (958.82 Record) to the Southeast corner of a parcel recorded in Book 641, Page 6244 at the McPherson County Register of Deeds Office, being the point of beginning; thence South 89°21'36" West on the South line of said parcel a distance of 1274.23 feet (1274.62 Record) to the Southwest corner of said parcel; thence North 00°04'16" East on the West line of said parcel a distance of 215.80 feet (214.80 Record); thence North 13°15'14" West a distance of 259.67 feet to the Northwest corner of said parcel; thence North 89°08'46" East on the North line of said parcel a distance of 1328.08 feet (1328.35 Record) to the Northeast corner of said parcel and the East line of said Southeast Quarter; thence South 00°39'47" East on said East line a distance of 474.14 feet (Record) to the point of beginning.

Containing 13.942 Acres and subject to a road right of way easement across the East 33.00 feet thereof, and any other easements or restrictions of record.

PARCEL 2

A portion of the Southeast Quarter of Section 24, Township 19 South, Range 3 West of the 6th Principal Meridian, McPherson County, Kansas described as follows:

Commencing at the Southeast corner of said Southeast Quarter; thence on a NAD 83 Kansas South Zone bearing of North 00°39'47" West on the East line of said Southeast Quarter a distance of 957.40 (958.82 Record) to the Southeast corner of a parcel recorded in Book 641, Page 6244 at the McPherson County Register of Deeds Office; thence South 89°21'36" West on the South line of said parcel a distance of 1274.23 feet (1274.62 Record) to the Southwest corner of said parcel; thence North 00°04'16" East on the West line of said parcel a distance of 215.80 feet (214.80 Record) to the point of beginning; thence South 89°49'59" West on the South line of said parcel a distance of 128.97 feet (128.00 Record) to a point 72.50 feet West of the West line of the Southeast Quarter of said Southeast Quarter; thence North 00°41'40" West parallel with said West line and on the West line of said parcel a distance of 157.75 feet (158.50 Record) to the North line of the Southwest Quarter of said Southeast Quarter; thence North 89°49'59" East on said North line and the North line of said parcel a distance of 72.50 feet (Record) to the Northeast corner of the Southwest Quarter of said Southeast Quarter; thence North 00°41'40" West on the West line of the Northeast Quarter of said Southeast Quarter and the West line of said parcel a distance of 95.18 feet (95.15 Record); thence South 13°15'14" East a distance of 259.67 feet to the point of beginning.

Containing 0.426 Acre and subject to any easements or restrictions of record.

Prepared For:		Description:	
TERRY LACY		A PORTION OF THE SE 1/4 SECTION 24, T19S, R03W McPHERSON COUNTY, KANSAS	
Prepared By:		Garber Surveying Service, P.A.	
GSS		HUTCHINSON (Main Office) 2908 North Plum St. 67502 Ph. 620-665-7032 Fax 620-663-7401 McPHERSON (Branch Office) 115 East Martin 67460 Ph. 620-241-4441 Fax 620-241-4458 NEWTON (Branch Office) 511 North Poplar St. 67114 Ph. 316-283-5053 Fax 316-283-5073 MANHATTAN (Branch Office) 3226 Kimball Ave Ste. B3 66503 Ph. 785-320-4810	
Drawn By: KDZ	Scale: 1"=100'	Date of Field Work: May 18, 2020	Job No:
Checked By: NDS	Date: 06/12/2020	Sheet 1 of 1 Sheet(s)	G2020-338