

12TH AVENUE

N 00°38'20" W 1981.25 (C)
N 00°38'20" W 2639.19 (M)

NW Cor. SW 1/4
Sec. 18, T19S, R3W
Fd. 5/8" Rebar w/GSS Cap
Origin: KSHS References by LS 1407, 7/23/2009

NE Cor. SW 1/4
Sec. 18, T19S, R3W
Fd. 1/2" Rebar
Origin: (PS)

N 89°53'33" E 2644.84 (M)
2611.84 (M)

PARCEL 2
79.607 Acres
(78.630 Acres without R/W)

S 89°47'37" E 1322.02 (C)
1289.02 (M)

S 00°49'08" E 645.06 (M)

S 89°50'36" E 644.42 (M)

PARCEL 1
80.242 Acres
(77.261 Acres without R/W)

P.O.B. 1
SW Cor. SW 1/4
Sec. 18, T19S, R3W
Fd. 5/8" Rebar w/Destroyed Cap
Origin: KSHS References by LS 1407 7/23/2009

N 89°48'24" W 1986.83 (C)
N 89°48'24" W 2618.39 (M)

MOCCASIN ROAD

P.O.B. 2
SE Cor. SW 1/4
Sec. 18, T19S, R3W
Fd. Railroad Spike
Origin: KSHS References by LS 1407 7/23/2009

S 01°25'34" E 1336.72 (C)
1303.71 (M)

S 00°03'51" E 2652.82 (M)
2619.82 (M)

- LEGEND
- △ - Sectional Monument Found
 - - 5/8" x 24" Iron Rebar Set w/G.S.S. Cap
 - (C) - Calculated
 - (M) - Measured
 - (PS) - Previous Survey GSS Project #G2014-317
 - P.O.B. - Point of Beginning
 - P.O.C. - Point of Commencement

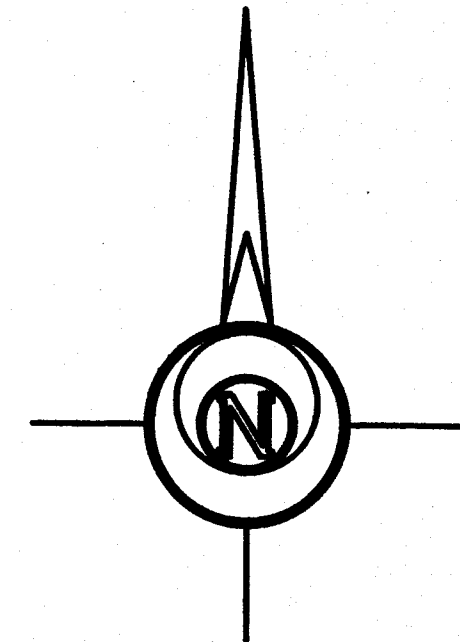

-200 0 200 400 600
BASIS OF BEARING = NAD 83 KANSAS SOUTH ZONE

DESCRIPTION:

PARCEL 1

A portion of Southwest Quarter of Section 18, Township 19 South, Range 3 West of the 6th Principal Meridian, McPherson County, Kansas described as follows:

Beginning at the Southwest corner of said Southwest Quarter; thence on a NAD 83 Kansas South Zone bearing of North 00°38'20" West on the West line of said Southwest Quarter a distance of 1981.25 feet; thence South 89°47'37" East a distance of 1322.02 feet; thence South 00°49'08" East a distance of 645.06 feet; thence South 89°50'36" East a distance of 644.42 feet; thence South 01°25'34" East a distance of 1336.72 feet to the South line of said Southwest Quarter; thence North 89°48'24" West on said South line a distance of 1986.83 feet to the point of beginning.

Containing 80.242 Acres and subject to road right of way easements across the South and West 33.00 feet thereof, and any other easements or restrictions of record.

PARCEL 2

A portion of Southwest Quarter of Section 18, Township 19 South, Range 3 West of the 6th Principal Meridian, McPherson County, Kansas described as follows:

Beginning at the Southeast corner of said Southwest Quarter; thence on a NAD 83 Kansas South Zone bearing of thence North 89°48'24" West on the South line of said Southeast Quarter a distance of 631.56 feet to a point 1986.83 feet East of the Southwest corner of said Southwest Quarter; thence North 01°25'34" West a distance of 1336.72 feet; thence North 89°50'36" West a distance of 644.42 feet; thence North 00°49'08" West a distance of 645.06 feet; thence North 89°47'37" West a distance of 1322.02 feet to the West line of said Southwest Quarter; thence North 00°38'20" West a distance of 657.94 feet to the Northwest corner of said Southwest Quarter; thence North 89°53'33" East on the North line of said Southwest Quarter a distance of 2644.84 feet to the Northeast corner of said Southwest Quarter; thence South 00°03'51" East on the East line of said Southwest Quarter a distance of 2652.82 feet to the point of beginning.

Containing 79.607 Acres and subject to road right of way easements across the South and West 33.00 feet thereof, and any other easements or restrictions of record.

SURVEYOR'S CERTIFICATE:

I hereby certify this plat to be a true, correct and complete representation of the property described hereon, as surveyed under my supervision, this 12th day of November, 2020.

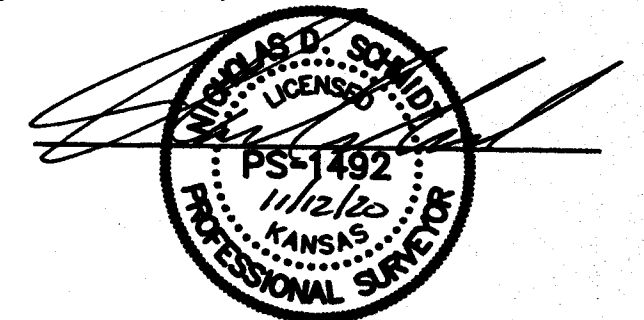

Prepared For:

TERESA BERGKAMP

Description:

A PORTION OF THE SW 1/4
SECTION 18, T19S, R03W
McPHERSON COUNTY, KANSAS

Prepared By:



Garber Surveying Service, P.A.

HUTCHINSON (Main Office) 2908 North Platte St. 67502 Ph. 620-665-7832 Fax 620-663-7401
McPHERSON (Branch Office) 206 South Main 67460 Ph. 620-241-4441 Fax 620-241-4458
NEWTON (Branch Office) 511 North Poplar St. 67114 Ph. 316-283-5053 Fax 316-283-5073
MANHATTAN (Branch Office) 3226 Kimball Ave Ste.#2 66503 Ph. 785-320-4810

Drawn By: KDZ	Scale: 1"=200'	Date of Field Work: October 23, 2020	Job No:
Checked By: NDS	Date: 11/12/2020	Sheet 1 of 1 Sheet(s)	G2020-808

NOTE:

Survey was made as per client request and no title work has been provided to the surveyor; therefore, the number and extent of easements and/or rights-of-way of record affecting said property has not been verified by this Survey.