

Saved 8/31/2016 3:28:51 PM by KLOUTZEN  
Plot Date & Time Thursday, September 01, 2016 6:36:08 AM Dwg Path C:\Users\mschmidt\Documents\GSS Projects\2016\431M\20160431 Auto S Ground

# U.S. 56 HIGHWAY

NE Cor. NE 1/4  
Sec. 29, T19S, R2W  
Fd. 5/8" Rebar  
Origin:MP. Co. Ref. Ties Dated 4/24/1996

N 89°18'12" E 2643.31 (M)

N 89°18'12" E 1680.31 (C)

NW Cor. NE 1/4  
Sec. 29, T19S, R2W  
Fd. 5/8" Rebar  
Origin:MP. Co. Ref. Ties Dated 7/14/1992

Exception  
(Bk. 264, Pg. 688)

N 00°02'27" W  
1253.00 (R) 1252.57 (C)

N 89°16'22" E  
944.00 (R) 945.15 (M)

Fd. 1/2" Rebar  
Fd. 1/2" Rebar w/Macon Cap  
0.15 N. of Line

Existing Parcel  
(Bk. 264, Pg. 688)

132.700 Acres

N 00°51'26" W 2638.00 (PS)(M)

N 00°51'26" W 1985.00 (M)

N 00°51'26" W 2622.54 (M)

SW Cor. NE 1/4  
Sec. 29, T19S, R2W  
(See Note 1)

SW Cor. SE 1/4  
Sec. 29, T19S, R2W  
Fd. 1/2" Rebar  
Origin:GSS Ref. Ties 4/29/2003

SE Cor. SE 1/4  
Sec. 29, T19S, R2W  
Fd. Railroad Spike  
Origin:Ref. Ties By Heller LS 1202 2/4/2008

SE Cor. NE 1/4  
Sec. 29, T19S, R2W  
(See Note 2)

S 00°45'10" E 26040.00 (GLO) 2644.77 (M)

33.00 (M)

S 89°27'02" W 2638.51 (M)

2605.51 (M)

S 89°29'18" W 2648.49 (M)

SW Cor. NW 1/4  
Sec. 29, T19S, R2W  
Fd. 5/8" Rebar  
Origin:MP. Co. Ref. Ties Dated 1986

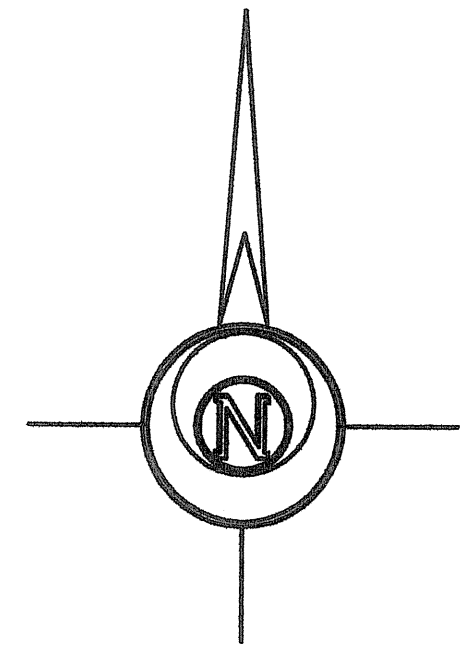

-300 0 300 600 900

BASIS OF BEARING = NAD 83 KANSAS SOUTH ZONE

## LEGEND

- △ - Sectional Monument Found
- ▲ - Section Monument Set (5/8" x 24" Iron Rebar w/G.S.S. Cap)
- - Survey Monument Found
- - 5/8" x 24" Iron Rebar Set w/G.S.S. Cap
- (C) - Calculated
- (M) - Measured
- (PS) - Previous Survey By F.R. Rankin 5/29/1975
- (GLO) - General Land Office

## DESCRIPTION OF RECORD:

The Northeast Quarter (NE1/4) of Section Twenty-Nine (29), Township Nineteen (19) South, Range Two (2) West of the Sixth Principal Meridian, except a tract of land containing 27.4 acres more or less: Beginning at the Northwest corner of said NE1/4; thence South on the 1/4 Section Line 1253 feet; thence East 944 feet; thence North 1253 feet to the North line of said NE1/4; thence West 963 feet to the place of beginning, containing 53 acres more or less, except highway right of way.

## SURVEYOR'S NOTES:

- Existing monument referenced in (PS) missing. Reset in line with hedgerow North at (PS) distance per (PS).
- No reference ties for record for corner. GLO stone monument likely destroyed by crossroad culvert at appaarent corner. Reset by physical evidence of hedge rows East/West and centerline North/South road in accordance with (PS) and the precedence set by the positions of the other section corner monuments in this section.

## SURVEYOR'S CERTIFICATE:

I hereby certify this plat to be a true, correct and complete representation of the property described hereon, as surveyed under my supervision, this 1st day of September, 2016.

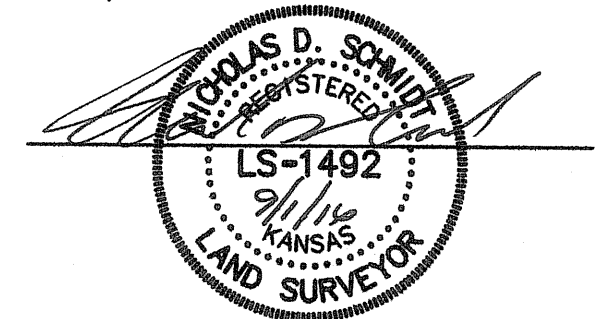

Prepared For:		Description:	
UNRUH FARMS		A PORTION OF THE NE 1/4 SECTION 29, T19S, R2W McPHERSON COUNTY, KANSAS	
Prepared By:		Garber Surveying Service, P.A.	
		HUTCHINSON (Main Office) 2908 North Plum St. 67502 Ph. 620-665-7032 Fax 620-663-7401 McPHERSON (Branch Office) 115 East Martin 67460 Ph. 620-241-4441 Fax 620-241-4458 NEWTON (Branch Office) 511 North Poplar St. 67114 Ph. 316-283-5053 Fax 316-283-5073	
Drawn By: KLL	Scale: 1"=300'	Date of Field Work: July 14, 2016	Job No:
Checked By: NDS	Date: 08/31/2016	Sheet 1 of 1 Sheet(s)	G2016-431