



A portion of the Southeast Quarter of Section 13, Township 19 South, Range 2 West of the 6th Principal Meridian, McPherson County, Kansas described as follows:

Beginning at the Southeast corner of the West Half of said Southeast Quarter; thence on a NAD 83 Kansas South Zone bearing of South 89°05'19" West on the South line of said Southeast Quarter a distance of 132.00 (Record); thence North 00°59'37" West parallel with the East line of said West Half a distance of 660.00 feet (Record); thence North 89°05'19" East parallel with said South line a distance of 132.00 feet (Record) to said East line; thence South 00°59'37" East on said East line a distance of 70.00 feet; thence South 86°28'52" East a distance of 130.21 feet; thence South 05°34'59" East a distance of 581.87 feet to the South line of said Southeast Quarter; thence South 89°05'19" West on said South line a distance of 176.37 feet to the point of beginning.

Containing 4.053 Acres and subject to a road right of way easement across the South 33.00 feet thereof, and any other easements or restrictions of record.

SURVEYOR'S CERTIFICATE:

I hereby certify this plat to be a true, correct and complete representation of the property described hereon, as surveyed under my supervision, this 12th day of June, 2020.

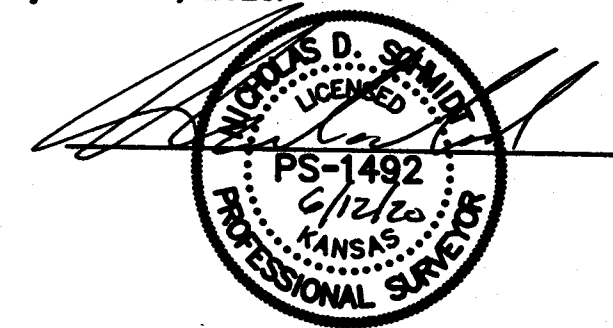
**Prepared For:**

MILLIE STUCKY

Description:

**A PORTION OF THE SE 1/4
SECTION 13, T19S, R2W
McPHERSON COUNTY, KANSAS**

Prepared By:

Garber Surveying Service, P.A.

HUTCHINSON (Main Office)	2908 North Plum St. 67502	Ph. 620-665-7032 Fax 620-663-7401
McPHERSON (Branch Office)	115 East Martin 67460	Ph. 620-241-4441 Fax 620-241-4458
NEWTON (Branch Office)	511 North Poplar St. 67114	Ph. 316-283-5053 Fax 316-283-5073
MANHATTAN (Branch Office)	3226 Kimball Ave Ste.62 66503	Ph. 785-370-4810

Drawn By: **KDZ**

Scale: 1"=60'

Date of Field Work: June 08, 2020

Job No:

Checked By: NDS

Date: 06/12/2020

Sheet 1 of 1 Sheet(s)

G2020-427