

Saved 10/4/2012 8:27:51 AM by NSCHMDT  
Plot Date & Time Thursday, October 04, 2012 9:30:24 AM Dwg Path U:\DD\GSSFILES\2012\20120557 C3d\dwg\20120557 Auto S Ground

24th AVENUE

MOHAWK ROAD

LEGEND

- △ - Sectional Monument Found
- ▲ - Section Monument Set (5/8" x 24" Iron Rebar w/G.S.S. Cap)
- - 5/8" x 24" Iron Rebar Set w/G.S.S. Cap
- (C) - Calculated
- (M) - Measured
- (PS1) - Previous Survey County Surveyor Jeff Tournay Dated 4/7/1883 (Record Survey Book A, PG. 56)
- (PS2) - Previous Survey By Ferguson Dated 1/9/1975
- (PS3) - Previous Survey By Stacy LS 86 9/16/1988
- (PS4) - Previous Survey GSS Proj. #G2010-573
- (GLO) - General Land Office
- P.O.B. - Point of Beginning
- P.O.C. - Point of Commencement

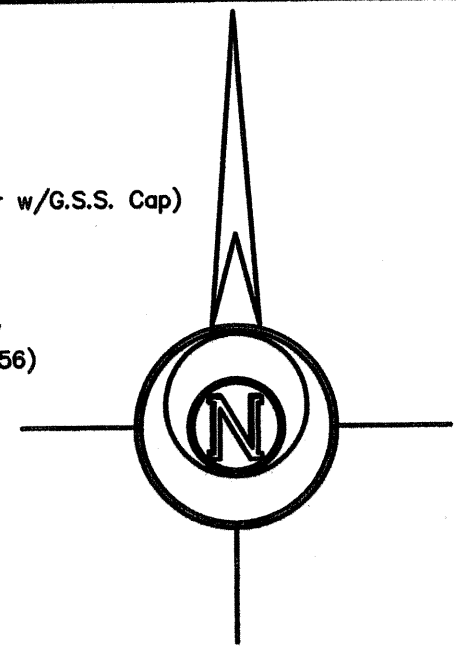

-100 0 100 200 300

BASIS OF BEARING = KANSAS STATE PLANE GRID

DESCRIPTION:

A portion of the East Half of the Southwest Quarter of Section 18, Township 19 South, Range 1 West of the 6th Principal Meridian, McPherson County, Kansas described as follows:

Commencing at the Southeast Corner of the Southwest Quarter of Section 18, Township 19 South, Range 1 West of the 6th Principal Meridian; thence on a Kansas State Plane Grid Bearing South 89°53'49" West along the South line of said Southwest Quarter 582.51 feet to the point of beginning; thence continuing South 89°53'49" West along said South line of the Southwest Quarter 716.55 feet to the Southwest corner of the East Half of said Southwest Quarter; thence North 00°59'35" West along the West line of said East Half of the Southwest Quarter 608.00 feet; thence North 89°53'49" East parallel with said South line of the Southwest Quarter 716.55 feet; thence South 00°59'35" East parallel with said West line of the East Half of the Southwest Quarter 608.00 feet to the point of beginning, containing **10.000 Acres**, subject to a road right-of-way easement across the South 33.00 feet thereof, and any other easements or restrictions of record.

SURVEYOR'S NOTES:

- Found 5/8" rebar 2.99' West and 0.04' South of accepted 1/2" rebar. The 1/2" rebar was first used by Ferguson in 1975 to set the South 1/4 corner. The 5/8" rebar later appeared and was used on the survey by Stacy in 1988, which was used to set another monument (5/8" rebar) at the South 1/4 corner (not accepted). The survey by Ferguson was far preceding to the Stacy survey therefore these monuments were accepted for this survey as well as in previous surveys by GSS (PS4).
- Found 5/8" rebar (Origin: Stacy LS 86 - 1988) 1.61' West and 0.28' North of accepted 3/4" rebar (Origin: Ferguson - 1975).
- The previous survey by Stacy LS 86 was not accepted for this survey. Stacy's survey disregarded the existing monuments previously set by Ferguson along the South line of the Southwest Quarter. Stacy's survey also used an apparent Center of Section (not monumented), which appears to be the intersection of the tree rows, for the breakdown of the Southwest Quarter, and there was no reference to the location of the North 1/4 corner and East 1/4 corner.
- Excavated and probed for stone referenced by Tournay (PS1) but did not find. Reset monument at the apparent center of the road intersection, which matches the distance by Tournay to the Northwest corner of the Section. Double proportionate measurement to the nearest section corners North and East would have placed the monument 44' East and 13' South of the apparent road intersection.
- Excavated and probed for stone referenced by Tournay (PS1) but did not find. Reset monument at the prorated distance to the survey by Tournay in line with apparent center of the road. This position is 11.19 feet South of the straight line between Northwest and Northeast Section corners. Apparent centerline was used because of similar proximity of the other found monuments around this section to the apparent centerline of road.

SURVEYOR'S CERTIFICATE:

I hereby certify this plat to be a true, correct and complete representation of the property described hereon, as surveyed under my supervision, this 4th day of October, 2012.

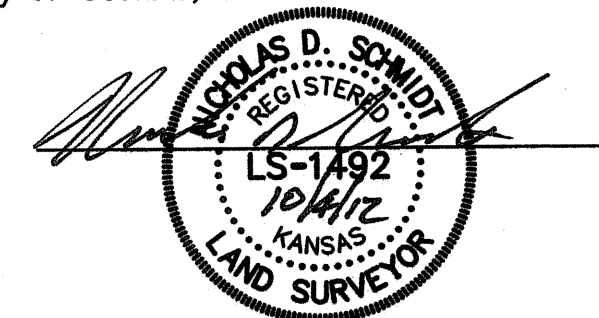

Prepared For:

DELMAR UNRUH

Description:

A PORTION OF THE E 1/2 OF THE SW 1/4 SECTION 18, T19S, R1W MCPHERSON COUNTY, KANSAS

Prepared By:

Garber Surveying Service, P.A.



HUTCHINSON (Main Office) 2908 North Plum St. 67502 Ph. 620-665-7032 Fax 620-663-7401  
MCPHERSON (Branch Office) 115 East Martin 67460 Ph. 620-241-4441 Fax 620-241-4458  
NEWTON (Branch Office) 511 North Poplar St. 67114 Ph. 316-283-5053 Fax 316-283-5073

Drawn By:

KLL

Scale: 1"=100'

Date of Field Work: September 12, 2012

Job No:

G2012-557

Checked By:

NDS

Date: 10/04/2012

Sheet 1 of 1 Sheet(s)

MOCCASIN ROAD

25th AVENUE

