

NE Cor. SW 1/4
Sec. 8, T18S, R3W
Fd. 1/2" Rebar
Origin: (PS)

A Part of the Southeast Quarter of the Southwest (SE/4 SW/4) of Section Eight (8), Township Eighteen (18) South Range Three (3) West of the Sixth Principal Meridian, described as beginning at a point on the section line 1081.3 feet West of the 1/4 section corner between Sections 8 and 17, thence North 713 feet, thence East 526 3/10 feet to the Northwest corner of Block 3, West Johnstown, thence South 247 feet to the Southwest corner of said Block 3, thence East 142 feet to the Southeast corner of said Block 3, thence South along the West side of Mary Street and along the East bank of Indian Creek to the section line, thence West on Section line 768 feet to the place of beginning.

A portion of the Southeast Quarter of the Southwest Quarter of Section 8, Township 18 South, Range 3 West of the 6th Principal Meridian, McPherson County, Kansas described as follows:

Commencing at the Southeast corner of said Southwest Quarter; thence on a NAD 83 Kansas South Zone bearing of South 88°50'03" West on the South line of the Southeast Quarter of said Southwest Quarter a distance of 548.93 feet to the point of beginning; thence continuing South 88°50'03" West on said South line a distance of 531.66 feet to a point being 1080.59 feet (1081.30 Record) West of said Southeast corner of the Southwest Quarter; North 01°09'32" West a distance of 712.38 feet (713.00 Record); thence North 88°47'27" East a distance of 301.63 feet; thence South 11°07'39" East a distance of 411.22 feet; thence South 37°32'27" East a distance of 87.13 feet; thence South 88°15'08" East a distance of 134.49 feet; thence South 05°33'24" West a distance of 232.19 feet the point of beginning.

Containing **6.740 Acres** and subject to a road right of way easement across the South 33.00 feet thereof, and any other easements or restrictions of record.

A portion of the Southeast Quarter of the Southwest Quarter of Section 8, Township 18 South, Range 3 West of the 6th Principal Meridian, McPherson County, Kansas described as follows:

Commencing at the Southeast corner of said Southwest Quarter; thence on a NAD 83 Kansas South Zone bearing of South 88°50'03" West on the South line of the Southeast Quarter of said Southwest Quarter a distance of 312.59 feet to the point of beginning; thence continuing South 88°50'03" West on said South line a distance of 236.34 feet; thence North 05°33'24" East a distance of 232.19 feet; thence North 88°15'08" West a distance of 134.49 feet; thence North 37°32'27" West a distance of 87.13 feet; thence North 11°07'39" West a distance of 411.22 feet; thence North 88°46'27" East a distance of 223.67 feet to the Northwest corner of Block 3, West Johnstown; thence South 01°10'58" East along the West line of said Block 3 a distance of 300.00 feet to the Southwest corner of said Block 3; thence North 88°49'02" East on the South line of said Block 3 a distance of 142.00 feet to the Southeast corner of said Block 3; thence South 01°10'57" East along the West side of Mary Street of said West Johnstown a distance of 208.55 feet to the East high bank of Indian Creek; thence South 26°56'50" East along said East high bank a distance of 39.36 feet; thence South 56°24'54" East along said East high bank a distance of 110.67 feet; thence South 02°55'51" West along said East high bank a distance of 106.08 feet to the point of beginning.

Containing **3.552 Acres** and subject to a road right of way easement across the South 33.00 feet thereof, and any other easements or restrictions of record.

I hereby certify this plat to be a true, correct and complete representation of the property described hereon, as surveyed under my supervision, this 9th day of August, 2016

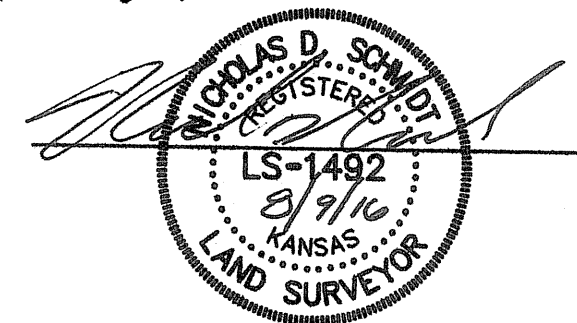

MALM FAMILY TRUST

**A PORTION OF THE SW 1/4
SECTION 8, T18S, R3W
McPHERSON COUNTY, KANSAS**

Garber Surveying Service, P.A.

FX **HUTCHINSON** (Main Office) 2908 North Plum St. 67502 Ph. 620-665-7032 Fax 620-663-7401
McPHERSON (Branch Office) 115 East Martin 67460 Ph. 620-241-4441 Fax 620-241-4458
NEWTON (Branch Office) 511 North Poplar St. 67114 Ph. 316-283-5053 Fax 316-283-5073

Drawn By: KLL	Scale: 1"=100'	Date of Field Work: July 29, 2016	Job No: G2016-446
Checked By: NDS	Date: 08/12/2016	Sheet 1 of 1 Sheet(s)	

QUIVIRA ROAD

Saved 8/12/2016 10:05:56 AM by SWILLIAMS
Plot Date & Time Friday, August 12, 2016 10:06:33 AM Dwg Path \\fs2\company\DD\GSSFILES\2016\20160446 C3d\dwg\20160446 Auto S.Gnd