

LEGEND

△	-	Sectional Monument Found
▲	-	Section Monument Set (5/8" x 24" Iron Rebar w/GSS CLS 52 Cap)
○	-	Survey Monument Found
●	-	5/8" x 24" Iron Rebar Set w/GSS CLS 52 Cap
(C)	-	Calculated
(M)	-	Measured
(R)	-	Record measurement
(PS)	-	Previous Survey by LS 1297 9/10/2010
(PS1)	-	Previous Survey GSS Project #G30-781
P.O.B.	-	Point of Beginning



DESCRIPTION:

Beginning at the Northeast corner of said Southeast Quarter; thence on a NAD 83 Kansas South Zone bearing of South 00°18'46" East a distance of 1056.02 feet to the Northeast corner of a parcel described in Book 667, Page 46106 at the McPherson County Register of Deeds Office; thence South 89°41'14" West on the North line of said parcel a distance of 1275.00 feet to the Northwest corner of said parcel; thence South 00°18'46" East on the West line of said parcel a distance of 600.00 feet to the Southwest corner of said parcel; thence North 89°41'14" East on the South line of said parcel a distance of 1275.00 feet to the East line of said Southeast Quarter; thence South 00°18'46" East on said East line the a distance of 274.98 feet; thence South 89°41'14" West perpendicular to said East line a distance of 1319.38 feet to the West line of the East Half of said Southeast Quarter; thence North 00°17'28" West on said West line a distance of 1937.38 feet to the Northwest corner of said East Half; thence North 89°57'53" East on the North line of said East Half a distance of 1318.66 feet to the point of beginning.

SURVEYOR'S CERTIFICATE:

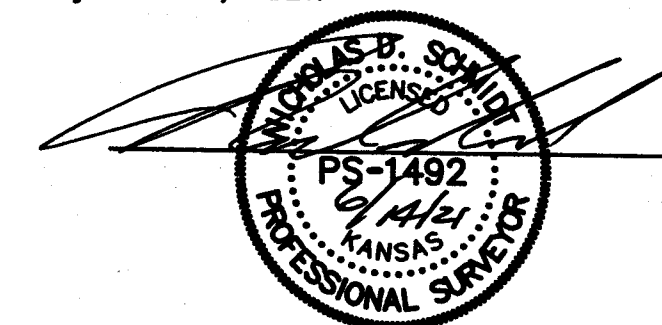

SURVEYOR'S NOTE:

Prepared For: BOBBY DECKER		Description: A PORTION OF THE SE 1/4 SECTION 31, T18S, R3W McPHERSON COUNTY, KANSAS	
Prepared By:  HUTCHINSON 2908 North Plum St. 67502 Ph. 620-665-7032 (Main Office)		Garber Surveying Service, P.A. BRANCH OFFICES: MANHATTAN Ph. 785-320-4810 MCPHERSON Ph. 620-241-4441 NEWTON Ph. 316-283-5053 SALINA Ph. 785-404-6302 WICHITA Ph. 316-260-9933	
Drawn By: KDZ	Scale: 1"=200'	Date of Field Work: May 29, 2021	Job No: G2021-463
Checked By: NDS	Date: 06/14/2021	Sheet 1 of 1 Sheet(s)	