

LEGEND

- △ - Sectional Monument Found
- ▲ - Section Monument Set (5/8" x 24" Iron Rebar w/G.S.S. Cap)
- - Survey Monument Found
- - 5/8" x 24" Iron Rebar Set w/G.S.S. Cap
- ✕ - Fence
- (C) - Calculated
- (M) - Measured
- (PS1) - Previous Survey by LS 85 Dated 6/15/84
- (PS2) - Previous Survey by LS 697 Dated 10/22/97
- (PS3) - Previous Survey by LS 1202 Dated 11/16/01
- P.O.B. - Point of Beginning
- P.O.C. - Point of Commencement

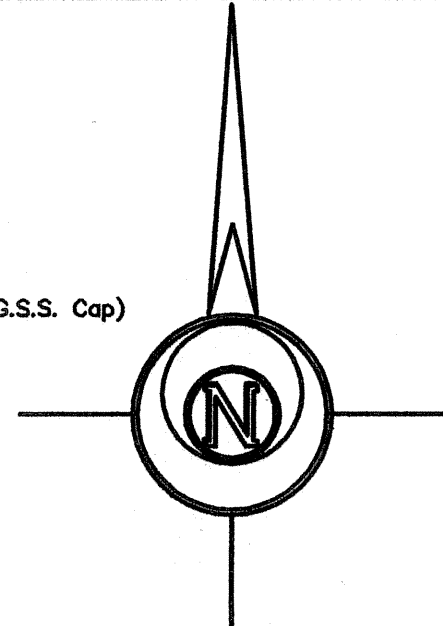

-200 0 200 400 600

BASIS OF BEARING = KANSAS STATE PLANE GRID

DESCRIPTIONS:

PARCEL 1

A portion of the Southwest Quarter of Section 10, Township 18 South, Range 3 West of the 6th Principal Meridian, McPherson County, Kansas described as follows:
Beginning at the Southwest Corner of Section 10, Township 18 South, Range 3 West of the 6th Principal Meridian; thence on a Kansas State Plane Grid Bearing North 00°21'00" West along the West line of said Southwest Quarter 1311.92 feet to the Northwest corner of the Southwest Quarter of said Southwest Quarter; thence North 00°12'44" West continuing along said West line 69.77 feet; thence South 88°58'05" East parallel with the South line of said Southwest Quarter 1238.92 feet; thence South 30°32'24" East 198.17 feet; thence South 00°27'10" West 1212.51 feet to the South line of said Southwest Quarter; thence North 88°58'05" West along said South line 1321.78 feet to the point of beginning, containing **42.023 Acres**, subject to a road right of way easement across the South and West 33.00 feet thereof and any other easements or restrictions of record.

PARCEL 2

A portion of the Southwest Quarter of Section 10, Township 18 South, Range 3 West of the 6th Principal Meridian, McPherson County, Kansas described as follows:
Commencing at the Southwest Corner of Section 10, Township 18 South, Range 3 West of the 6th Principal Meridian; thence on a Kansas State Plane Grid Bearing South 88°58'05" East along the South line of said Southwest Quarter 1321.78 feet to the point of beginning; thence North 00°27'10" East 1212.51 feet; thence North 29°53'24" East 153.16 feet; thence South 88°58'05" East parallel with the South line of said Southwest Quarter 1243.96 feet to the East line of said Southwest Quarter; thence South 00°30'36" East along said East line 1347.08 feet to the Southeast corner of said Southwest Quarter; thence North 88°58'05" West along the South line of said Southwest Quarter 1341.87 feet to the point of beginning, containing **41.016 Acres**, subject to a road right of way easement across the South 33.00 feet thereof and any other easements or restrictions of record.

PARCEL 3

A portion of the Southwest Quarter of Section 10, Township 18 South, Range 3 West of the 6th Principal Meridian, McPherson County, Kansas described as follows:
Commencing at the Southwest Corner of Section 10, Township 18 South, Range 3 West of the 6th Principal Meridian; thence on a Kansas State Plane Grid Bearing North 00°21'00" West along the West line of said Southwest Quarter 1311.92 feet to the Northwest corner of the Southwest Quarter of said Southwest Quarter; thence North 00°12'44" West continuing along said West line 69.77 feet to the point of beginning; thence continuing North 00°12'44" West along said West line 1241.99 feet to the Northwest corner of said Southwest Quarter; thence South 89°14'26" East along the North line of said Southwest Quarter 2652.86 feet to the Northeast corner of said Southwest Quarter; thence South 00°30'36" East along the East line of said Southwest Quarter 1289.48 feet; thence North 88°58'05" West parallel with the South line of said Southwest Quarter 1243.96 feet; thence South 29°53'24" West 153.16 feet; thence North 30°32'24" West 198.17 feet; thence North 88°58'05" West parallel with the South line of said Southwest Quarter 1238.92 feet to the point of beginning, containing **77.470 Acres**, subject to a road right of way easement across the West 33.00 feet thereof and any other easements or restrictions of record.

SURVEYOR'S NOTES:

1) The found monument as shown on the survey by Durr LS 697 in 1997 was not found by LS 1202 in 2001 and the position of the monument at the West 1/4 corner was ruled obliterated by Heller LS 1202 and reset. The position of monument set by Heller is 3.16 feet East of the monument location referenced by Durr and the calculated position shown by Sickmon (PS1). No reference ties were on file with KSHS or McPherson County prior (PS2). After a conversation with Heller, it was decided to accept the position of his monument for this survey.

2) Reset per (PS2) using the found monument at the S 1/4 corner and the found monument along the East line of the Southwest Quarter.

SURVEYOR'S CERTIFICATE:

I hereby certify this plat to be a true, correct and complete representation of the property described hereon, as surveyed under my supervision, this 14th day of February, 2013

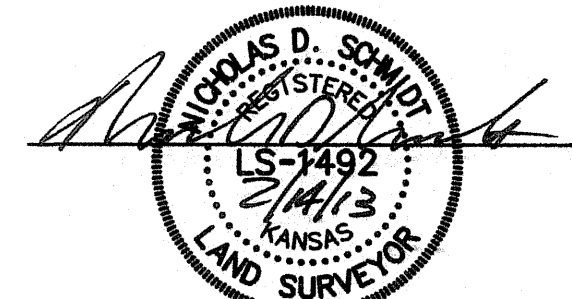

Prepared For:		Description:	
NIELS WILSON		PORTIONS OF THE SW 1/4 SECTION 10, T18S, R3W MCPHERSON COUNTY, KANSAS	
Prepared By:		Garber Surveying Service, P.A.	
GSS		HUTCHINSON (Main Office) 2908 North Plum St. 67502 Ph. 620-665-7032 Fax 620-663-7401 McPHERSON (Branch Office) 115 East Marlin 67460 Ph. 620-241-4441 Fax 620-241-4458 NEWTON (Branch Office) 511 North Poplar St. 67114 Ph. 316-283-5053 Fax 316-283-5073	
Drawn By: KLL	Scale: 1"=200'	Date of Field Work: February 5, 2013	Job No:
Checked By: NDS	Date: 2/14/2013	Sheet 1 of 1 Sheet(s)	G2013-49