

BASIS OF BEARING = NAD 83 KANSAS SOUTH ZONE

LEGEND

- △ - Sectional Monument Found
- - Survey Monument Found
- - 5/8" x 24" Iron Rebar Set w/G.S.S. Cap
- (C) - Calculated
- (M) - Measured
- (PS1) - Previous Survey By F.R. Rankin Dated 01/06/1964
- (PS1-C) - Calculated from (PS1) Dimensions
- (PS2) - Previous Survey G.S.S. Project # G90-111

DESCRIPTION OF RECORD:

The North half of the North half of the Southwest Quarter Section 26, Township 18 South, Range 2 West of the 6th Principal Meridian, McPherson County, Kansas.

BASE FLOOD ELEVATION: 1484.2 (NAVD88)

ZONE: A

MAP PANEL 20113C 0250E

NOTE: BFE is from State D FIRM

BENCHMARK 4:

5/8" Rebar w/ GSS Red Cap near Southwest property corner
Elevation=1521.62 (NAVD 88)

SURVEYOR'S NOTES:

1. Searched for the pins set by F.R. Rankin in previous survey but did not find. It appears the existing fence and leaning fence corner was placed directly on the pin set at the SE corner of the property. That fence corner matches the distance to the found stone at the Center of section to the previous survey distance and is 1.12 feet West of a straight line from South 1/4 corner to the Center. Set monument on East face of leaning fence post for a measurable position.
2. Accepted the existing fence line as the South property line as surveyed and monumented in previous survey. Intersected surveyed fence line with the West line of the Southwest Quarter to establish Southwest property corner. The existing fence corner along the East side of the road way fell 26.20' East of the Southwest property corner which was within acceptable tolerances in comparison to the previous survey distance of the 25.0 feet.
3. Calculated a line from the Southwest section corner through the calculated Southwest property corner to search for a monument at the Northwest property corner (W 1/4 corner). Found a 60d nail 1.62 feet West of the calculated location. Accepted the monument and reset with a 5/8" rebar with GSS cap. Monument falls in line with fence line running West and in apparent centerline of travel way of 22nd Avenue which is 24.53 feet East of a straight line between Northwest and Southwest section corners as referenced on (PS2). This monument appears to be the best representation of the position referenced on previous survey by F.R. Ranking (PS1).

SURVEYOR'S CERTIFICATE:

I hereby certify this plat to be a true, correct and complete representation of the property described hereon, as surveyed under my supervision, this 16th day of June, 2014

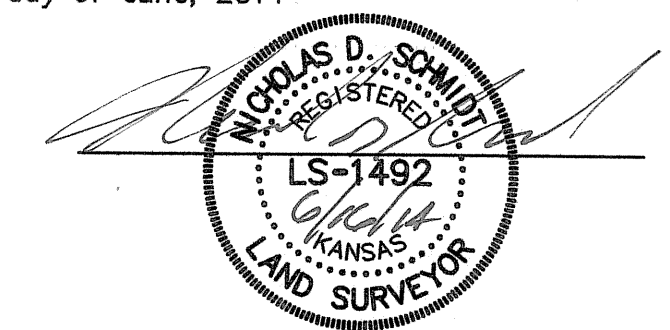

Prepared For: KELLY KOEHN		Description: THE N1/2, N 1/2, SW 1/4, SECTION 26, T18S, R2W McPHERSON COUNTY, KANSAS	
Prepared By: Garber Surveying Service, P.A.			
GSS		HUTCHINSON (Main Office) 2908 North Plum St. 67502 Ph. 620-665-7032 Fax 620-663-7401 McPHERSON (Branch Office) 115 East Marlin 67460 Ph. 620-241-4441 Fax 620-241-4458 NEWTON (Branch Office) 511 North Poplar St. 67114 Ph. 316-283-5053 Fax 316-283-5073	
Drawn By: CSS	Scale: 1"=200'	Date of Field Work: June 10, 2014	Job No:
Checked By: NDS	Date: 06/16/2014	Sheet 1 of 1 Sheet(s)	G2014-403