

- LEGEND**
- △ - Sectional Monument Found
  - ▲ - Section Monument Set (5/8" x 24" Iron Rebar w/G.S.S. Cap)
  - - 5/8" x 24" Iron Rebar Set w/G.S.S. Cap
  - (C) - Calculated
  - (M) - Measured
  - (PS) - Previous Survey By BLM (1955)
  - (R) - Record measurement
  - BLM - Bureau of Land Management
  - P.O.B. - Point of Beginning
  - P.O.C. - Point of Commencement

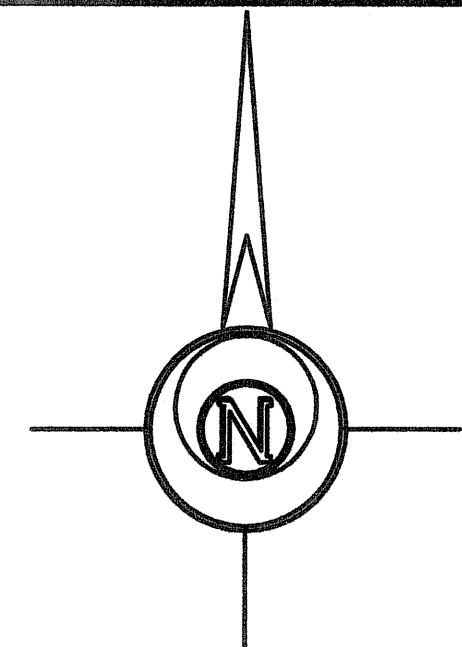

-300 0 300 600 900

BASIS OF BEARING = KANSAS STATE ZONE 1502

**DESCRIPTION;  
PARCEL 1**

A portion Southeast Quarter of Section 3, Township 17 South, Range 5 West of the 6th Principal Meridian, McPherson County, Kansas described as follows:

Beginning at the Southeast corner of the Southeast Quarter of Section 3, Township 17 South, Range 5 West of the 6th Principal Meridian; thence on a Kansas State Plane Zone 1502 bearing of South 89°34'16" West along the South line of said Southeast Quarter 150.29 feet; thence North 00°56'12" West parallel with the East line of said Southeast Quarter 853.97 feet; thence South 89°03'48" West perpendicular to said East line 280.67 feet; thence North 00°56'12" West parallel with said East line 829.31 feet; thence North 89°12'40" West 1395.64 feet; thence North 32°03'15" East 251.09 feet; thence South 89°10'15" West 542.20 feet to the East line of a parcel described in Book 172, Page 111 at the McPherson County Register of Deeds Office; thence North 17°00'40" East along the East line of said parcel 745.38 feet to the North line of said Southeast Quarter; thence North 89°49'28" East along said North line 2001.92 feet to the Northeast corner of said Southeast Quarter; thence South 00°56'12" East along said East line 2620.78 feet to the point of beginning containing **54.629 Acres**, subject to road right of way easements across the South 50.00 feet and the East 33.00 feet thereof, and any other easements or restrictions of record.

**PARCEL 2**

A portion Southeast Quarter of Section 3, Township 17 South, Range 5 West of the 6th Principal Meridian, McPherson County, Kansas described as follows:

Commencing at the Southeast corner of the Southeast Quarter of Section 3, Township 17 South, Range 5 West of the 6th Principal Meridian; thence on a Kansas State Plane Zone 1502 bearing of South 89°34'16" West along the South line of said Southeast Quarter 150.29 feet to the point of beginning; thence continuing South 89°34'16" West along said South line 2509.67 feet to the Southwest corner of said Southeast Quarter; thence North 00°19'46" East along the West line of said Southeast Quarter 807.41 feet to the Southeast corner of a parcel described in Book 172, Page 111, at the McPherson County Register of Deeds Office, said corner being 1825.00 feet (1825.00 Record) South of the Northwest corner of said Southeast Quarter; thence South 83°57'36" East along the South line of said parcel 50.25 feet; thence North 17°00'40" East along the East line of said parcel 1170.54 feet; thence North 89°10'15" East 542.20 feet; thence South 32°03'15" West 251.09 feet; thence South 89°12'40" East 1395.64 feet; thence South 00°56'12" East parallel with the East line of said Southeast Quarter 829.31 feet; thence North 89°03'48" East perpendicular to said East line 280.67 feet; thence South 00°56'12" East parallel with said East line 853.97 feet to the point of beginning containing **90.346 Acres**, subject to a road right of way easement across the South 50.00 feet thereof, and any other easements or restrictions of record.

**SURVEYOR'S CERTIFICATE:**

I hereby certify this plat to be a true, correct and complete representation of the property described hereon, as surveyed under my supervision, this 2nd day of October, 2013.

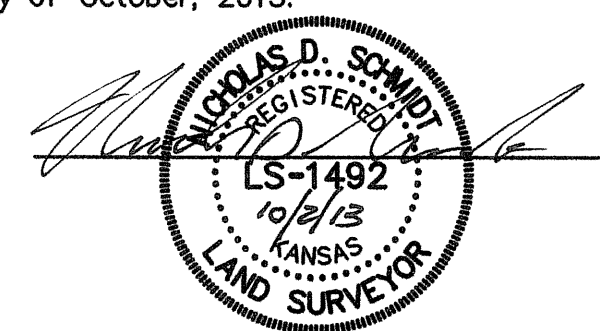

Prepared For: <b>DARRELL LODER</b>		Description: <b>PORTIONS OF THE SE 1/4 SECTION 3, T17S, R5W MCPHERSON COUNTY, KANSAS</b>	
Prepared By: <b>GSS</b>		<b>Garber Surveying Service, P.A.</b>	
HUTCHINSON (Main Office) 2908 North Plum St. 67502 Ph. 620-665-7032 Fax 620-663-7401		MCPHERSON (Branch Office) 115 East Marlin 67460 Ph. 620-241-4441 Fax 620-241-4458	
NEWTON (Branch Office) 511 North Poplar St. 67114 Ph. 316-283-5053 Fax 316-283-5073			
Drawn By: KLL	Scale: 1"=300'	Date of Field Work: September 18, 2013	Job No:
Checked By: NDS	Date: 10/02/2013	Sheet 1 of 1 Sheet(s)	<b>G2013-570</b>