

# Heller Boundary Surveys

William B. Heller, P.S. 1202 ~ Cellular: 1-620-245-8023  
863 S. 9<sup>th</sup> Street, Salina, KS 67401 ~ E-mail: [willyboskilly@yahoo.com](mailto:willyboskilly@yahoo.com)

## Certificate of Legal Description

This is to certify and acknowledge that I, William B. Heller, a registered land surveyor in the County of McPherson, State of Kansas, surveyed the following:

**0.08 acre parcel:** A 0.08 acre parcel located in The South One-half (1/2) of The Southwest One-quarter (1/4) of Section Twenty-four (24), Township Seventeen (17) South – Range Five (5) West of the Sixth Principal Meridian. More particularly described by William B. Heller, P.S.1202, October 13, 2023 as follows:

Commencing at The Northwest Corner of The Southwest Quarter (1/4) of The Southwest Quarter (1/4) of said Section Twenty-four (24), T17S-R5W; thence South 89 degrees 59 minutes 52 seconds East, along The One-sixteenth (1/16) Section line located on the north side of the Southwest Quarter (1/4) of The Southwest One Quarter (1/4) and also on the south side of Hanson's 2<sup>nd</sup> Addition to The City of Marquette, 1,231.00 feet to the southwest corner of the east one-half (1/2) of Lot Eighteen (18), Hanson's Second Addition to The City of Marquette, McPherson County, Kansas, The Point of Beginning; thence South 01 degrees 11 minutes 27 seconds East, 132.12 feet; thence South 89 degrees 52 minutes 31 seconds West, 26.65 feet; thence North 01 degrees 11 minutes 27 seconds West, 132.20 feet; thence South 89 degrees 59 minutes 52 seconds East along the said One-sixteenth Section Line, 26.65 feet to The Point of Beginning. Said parcel contains 0.08 acres. Said parcel is subject to any easements or restrictions of record.

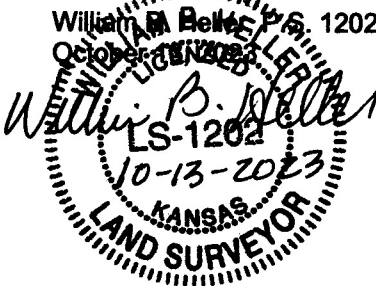

For: Troy E. Johnson  
319 W. Pack Road  
Moundridge, KS 67107

## Report for Legal Description

Research of the records at the McPherson County Public Works Department and McPherson County Court House revealed the following information:

**Roads:** 4<sup>th</sup> street is 45.00 feet wide, 22.5 feet on each side of centerline street. Ross Street is 50 feet wide, 25 feet on each side of centerline street.

**Surveys:** References found at the McPherson County Public Works Vault. A boundary survey by Victor Clough, dated March 7, 1970. Boundary survey by Garber Surveying Service, dated February 1, 2017.

**Field procedure:** I used the bearing between the southwest corner of the east one-half (1/2) of Lot 18, Hanson's Second Addition and the Northwest Corner of the Southwest Quarter (1/4) of the Southwest One-quarter (1/4) of Section 24, T17S-R5W for my assumed bearing. I set 1/2" x 24" rebars and I.D. caps at the monuments I set. I used Topcon GRE-3 RTK kinematic, G.P.S. receivers for measuring the found and set monuments for this survey.