

LEGEND

- △ - Sectional Monument Found
- - Fd. 5/8" Rebar w/GSS Cap
- (C) - Calculated
- (M) - Measured
- (PS) - Previous Survey by Forgy 11/10/2000
- P.O.B. - Point of Beginning
- P.O.C. - Point of Commencement

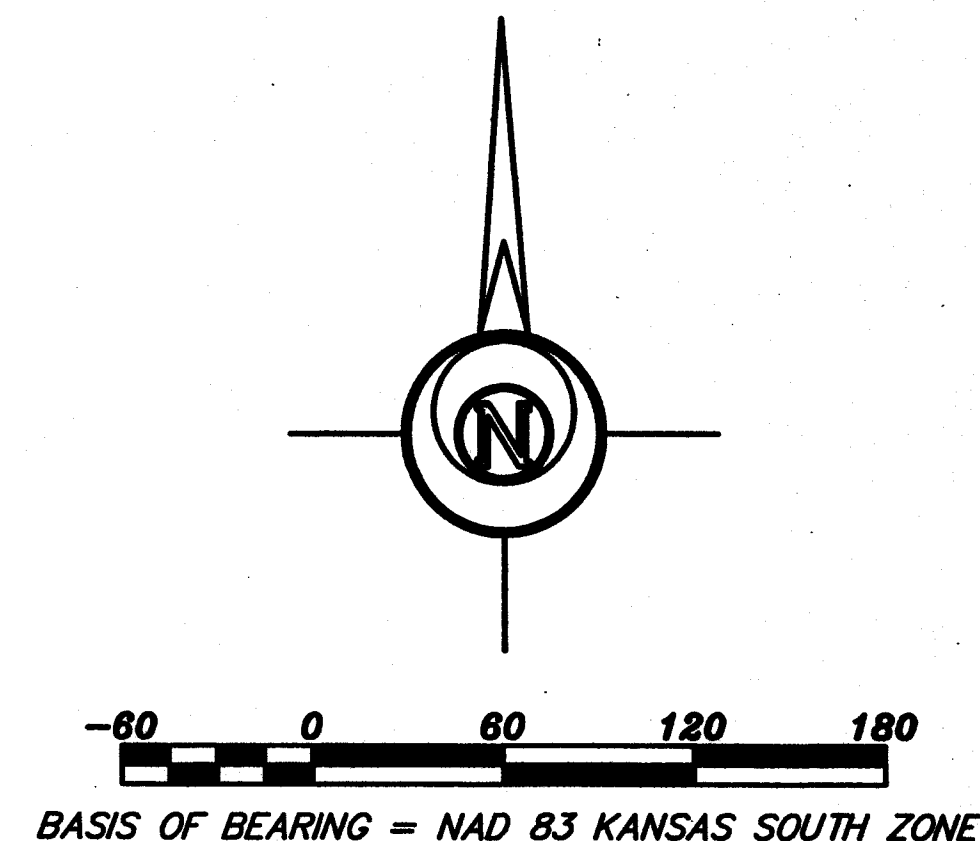

DESCRIPTION:

A portion of the Southwest Quarter of Section 24, Township 17 South, Range 3 West of the 6th Principal Meridian, McPherson County, Kansas described as follows:

Commencing at the Southwest corner of said Southwest Quarter; thence on a NAD 83 Kansas South Zone bearing of North 89°19'49" East on the South line of said Southwest Quarter a distance of 451.89 feet to the point of beginning; thence North 00°40'11" West perpendicular to said South line a distance of 450.03 feet; thence North 39°56'14" West a distance of 112.98 feet; thence North 06°03'31" West a distance of 340.63 feet; thence North 89°19'49" East parallel with said South line a distance of 273.11 feet; thence South 00°40'11" East perpendicular with said South line a distance of 313.02 feet; thence North 89°19'49" East parallel with said South line a distance of 279.58 feet; thence South 00°40'11" East perpendicular with said South line a distance of 198.11 feet; thence North 79°21'49" West a distance of 76.67 feet; thence South 81°44'07" West a distance of 55.27 feet; thence South 46°23'26" West a distance of 267.67 feet; thence South 30°46'06" West a distance of 85.10 feet; thence South 00°40'11" East perpendicular to said South line a distance of 118.27 feet to said South line; thence South 89°19'49" West on said South line a distance of 78.89 feet to the point of beginning.

Containing 5.240 Acres and subject to a road right of way easement across South 50.00 feet thereof, and any other easements or restrictions of record.

SURVEYOR'S CERTIFICATE:

I hereby certify this plat to be a true, correct and complete representation of the property described hereon, as surveyed under my supervision, this 30th day of June, 2020.

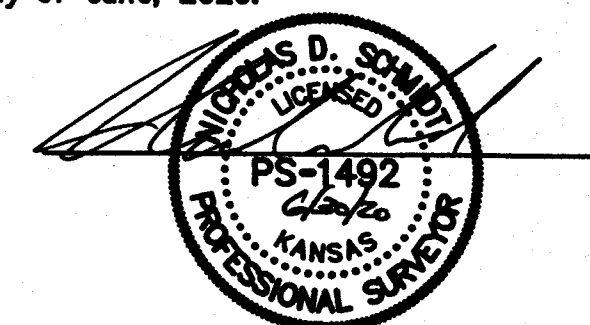

Prepared For: DOUG ALBRECHT		Description: A PORTION OF THE SW 1/4 SECTION 24, T17S, R3W McPHERSON COUNTY, KANSAS	
Prepared By: Garber Surveying Service, P.A.			
GSS HUTCHINSON (Main Office) 2908 North Plum St. 67582 Ph. 620-665-7832 Fax 620-663-7401 McPHERSON (Branch Office) 115 East Main St. 67460 Ph. 620-241-4441 Fax 620-241-4458 NEWTON (Branch Office) 511 North Poplar St. 67114 Ph. 316-283-5053 Fax 316-283-5073 MANHATTAN (Branch Office) 3226 Kimball Ave. Ste. #2 66503 Ph. 785-320-4810			
Drawn By: KDZ	Scale: 1"=60'	Date of Field Work: June 16, 2020	Job No: G2020-449
Checked By: NDS	Date: 06/30/2020	Sheet 1 of 1 Sheet(s)	