

- LEGEND**
- △ - Sectional Monument Found
  - - 5/8" x 24" Iron Rebar Set w/GSS CLS 52 Cap
  - (C) - Calculated
  - (M) - Measured
  - (PS) - Previous Survey GSS Project #G2020-880
  - P.O.B. - Point of Beginning
  - BLM - Bureau of Land Management

**DESCRIPTION:**

A portion of the Southeast Quarter of Section 2, Township 17 South, Range 3 West of the 6th Principal Meridian, McPherson County, Kansas, described as follows by Nicholas D. Schmidt, PS #1492, this 8th day of November, 2023:

Beginning at the Southeast corner of said Southeast Quarter; thence on a NAD 83 Kansas South Zone bearing of South 89°37'43" West on the South line of said Southeast Quarter a distance of 900.00 feet to the centerline of Kentucky Creek; thence on said centerline for the next 6 courses:  
North 26°47'37" East a distance of 63.36 feet;  
North 24°16'24" East a distance of 146.29 feet;  
North 14°18'45" East a distance of 41.91 feet;  
North 26°43'43" West a distance of 79.51 feet;  
North 54°14'33" West a distance of 163.15 feet;  
North 53°47'30" West a distance of 176.10 feet;  
thence North 89°41'44" East a distance of 1107.01 feet to the East line of said Southeast Quarter; thence South 00°28'38" East on said East line a distance of 500.97 feet to the point of beginning.

Containing 10.26 Acres and subject to a road right of way easement along the East line thereof, and any other easements or restrictions of record.

**SURVEYOR'S NOTES:**

- Survey was made as per client request and no title work has been provided to the surveyor; therefore, the number and extent of easements and/or rights-of-way of record affecting said property has not been verified by this Survey.
- All measurements are in US Survey Feet.

**SURVEYOR'S CERTIFICATE:**

I hereby certify this plat to be a true, correct and complete representation of the property described hereon, as surveyed under my supervision, this 8th day of November, 2023.

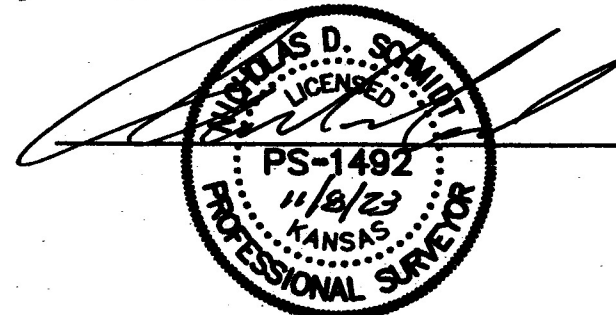

Prepared For:		Description:	
MIKE BURGER		A PORTION OF THE SE 1/4 SECTION 2, T17S, R3W McPHERSON COUNTY, KANSAS	
Prepared By:		Garber Surveying Service, P.A.	
GSS HUTCHINSON 2908 North Plum St. 67502 Ph. 620-665-7032 (Main Office)		BRANCH OFFICES: MANHATTAN Ph. 785-320-4810 MCPHERSON Ph. 620-241-4441 NEWTON Ph. 316-283-5053 SALINA Ph. 785-404-6302 WICHITA Ph. 316-260-9933	
Drawn By: KDZ	Scale: 1"=100'	Date of Field Work: September 25, 2023	Job No:
Checked By: NDS	Date: 11/08/2023	Sheet 1 of 1 Sheet(s)	G2023-770