

L1	S 00°56'23" W	79.11
L2	S 18°56'55" W	101.21
L3	S 09°12'05" W	118.68
L4	S 21°43'52" W	105.80
L5	S 23°45'09" W	189.53
L6	S 14°23'22" W	102.97
L7	S 10°20'45" W	390.41
L8	S 04°47'52" W	154.11
L9	S 00°09'05" W	126.76
L10	S 00°09'05" W	185.79
L11	S 04°09'37" W	120.80
L12	S 83°46'31" W	320.08
L13	S 80°13'48" W	251.94
L14	S 62°31'46" W	119.93
L15	S 35°23'40" W	102.32
L16	S 10°25'21" W	168.48
L17	S 10°29'43" W	131.42
L18	S 16°25'11" W	130.30
L19	S 15°37'02" W	170.21
L20	S 18°10'56" W	111.18
L21	S 23°12'50" W	269.96
L22	S 09°53'20" W	85.28
L23	S 09°53'20" W	30.95
L24	S 18°08'23" W	58.45
L25	S 51°30'26" W	80.01
L26	S 48°27'56" W	78.16
L27	S 32°34'57" W	244.42
L28	S 37°10'32" W	115.17
L29	S 27°51'58" W	116.16
L30	S 32°03'56" W	93.71
L31	S 24°20'24" W	95.65
L32	S 05°25'24" E	95.71
L33	S 26°08'22" E	168.97
L34	S 34°57'23" E	161.39
L35	S 26°47'57" E	115.16
L36	S 40°31'46" E	119.88
L37	S 33°42'35" E	168.57
L38	S 45°25'08" E	101.81
L39	S 50°03'38" E	353.96
L40	S 33°14'08" E	191.18
L41	S 27°18'51" E	97.95
L42	S 15°27'08" E	132.31
L43	S 08°16'53" W	131.60
L44	S 21°58'25" W	394.81

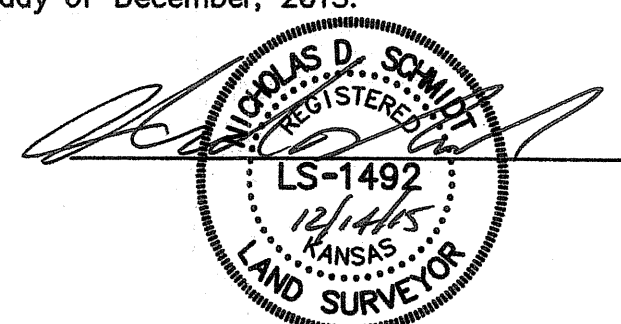

Prepared For:	Description: A PORTION OF THE E 1/2 SECTION 22, T17S, R2W McPHERSON COUNTY, KANSAS		
Prepared By:	Garber Surveying Service, P.A.		
CSS HUTCHINSON (Main Office) 2908 North Plum St. 67502 Ph. 620-665-7032 Fax 620-663-7401 McPHERSON (Branch Office) 115 East Marlin 67460 Ph. 620-241-4441 Fax 620-241-4458 NEWTON (Branch Office) 511 North Poplar St. 67114 Ph. 316-283-5053 Fax 316-283-5073			
Drawn By: KLL	Scale: 1"=300'	Date of Field Work: November 24, 2015	Job No:
Checked By: DEG	Date: 12/14/2015	Sheet 1 of 1 Sheet(s)	G2015-836