

**DESCRIPTION:  
PARCEL 1**

A portion of the Fractional Southwest Quarter of Section 19, Township 17 South, Range 2 West of the 6th Principal Meridian, McPherson County, Kansas described as follows:

Beginning at the Southwest corner of the Fractional Southwest Quarter of Section 19, Township 17 South, Range 2 West of the 6th Principal Meridian; thence on a Kansas State Plane Zone 1502 Bearing North 00°38'58\"/>

**PARCEL 2**

A portion of the Fractional Southwest Quarter of Section 19, Township 17 South, Range 2 West of the 6th Principal Meridian, McPherson County, Kansas described as follows:

Beginning at the Southeast corner of the Fractional Southwest Quarter of Section 19, Township 17 South, Range 2 West of the 6th Principal Meridian; thence on a Kansas State Plane Zone 1502 Bearing South 88°48'57\"/>

**PARCEL 3**

A portion of the Fractional Southwest Quarter of Section 19, Township 17 South, Range 2 West of the 6th Principal Meridian, McPherson County, Kansas described as follows:

Commencing at the Northwest corner of the Fractional Southwest Quarter of Section 19, Township 17 South, Range 2 West of the 6th Principal Meridian; thence on a Kansas State Plane Zone 1502 Bearing South 00°38'58\"/>

**PARCEL 4**

A portion of the Fractional Southwest Quarter of Section 19, Township 17 South, Range 2 West of the 6th Principal Meridian, McPherson County, Kansas described as follows:

Commencing at the Northwest corner of the Fractional Southwest Quarter of Section 19, Township 17 South, Range 2 West of the 6th Principal Meridian; thence on a Kansas State Plane Zone 1502 Bearing South 00°38'58\"/>

**PARCEL 5**

A portion of the Fractional Southwest Quarter of Section 19, Township 17 South, Range 2 West of the 6th Principal Meridian, McPherson County, Kansas described as follows:

Beginning at the Northwest corner of the Fractional Southwest Quarter of Section 19, Township 17 South, Range 2 West of the 6th Principal Meridian; thence on a Kansas State Plane Zone 1502 Bearing North 89°14'08\"/>

**SURVEYOR'S CERTIFICATE:**

I hereby certify this plat to be a true, correct and complete representation of the property described hereon, as surveyed under my supervision, this 19th day of November, 2013.

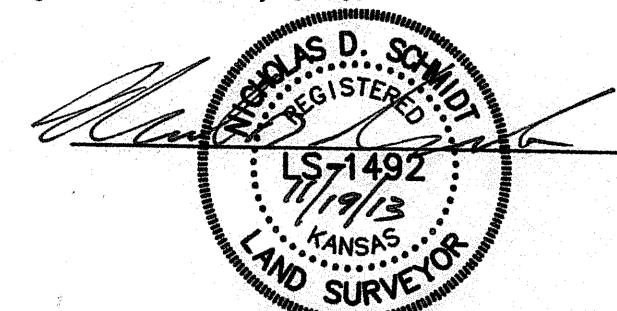

Prepared For: <b>KRISTEN CARLSON</b>		Description: <b>PORTIONS OF THE SW 1/4 SECTION 19, T17S, R2W MCPHERSON COUNTY, KANSAS</b>	
Prepared By: <b>GSS</b>		<b>Garber Surveying Service, P.A.</b>	
Drawn By: <b>CSS</b>		Scale: <b>1"=150'</b>	Date of Field Work: <b>November 7, 2013</b>
Checked By: <b>NDS</b>		Date: <b>11/19/2013</b>	Sheet <b>1 of 1</b> Sheet(s)
		Job No: <b>G2013-712</b>	