

DESCRIPTION:

A portion of the Southeast Quarter of Section 6, Township 17 South, Range 1 West of the 6th Principal Meridian, McPherson County, Kansas, described as follows by Nicholas D. Schmidt, PS #1492, this 10th day of June, 2024:

Commencing at the Southeast corner of said Southeast Quarter; thence on a NAD 83 Kansas South Zone bearing of North 00°11'05" West on the East line of said Southeast Quarter a distance of 680.82 feet to the point of beginning; thence South 87°58'11" West a distance of 345.34 feet; thence South 32°16'53" West a distance of 26.33 feet; thence South 88°04'36" West a distance of 333.54 feet; thence South 44°31'02" West a distance of 217.99 feet; thence North 79°18'05" West a distance of 471.11 feet; thence North 00°11'40" West a distance of 367.78 feet; thence North 89°31'01" East a distance of 883.29 feet; thence North 12°48'35" East a distance of 177.97 feet; thence North 88°27'09" East a distance of 66.91 feet; thence South 81°54'43" East a distance of 321.88 feet to said East line; thence South 00°11'05" East on said East line a distance of 391.63 feet to the point of beginning.

The above described tract contains 11.72 Acres and is subject to a road right of way easement along the East line thereof, and any other easements or restrictions of record.

SURVEYOR'S CERTIFICATE:

I hereby certify this plat to be a true, correct and complete representation of the property described hereon, as surveyed under my supervision, this 10th day of June, 2024.

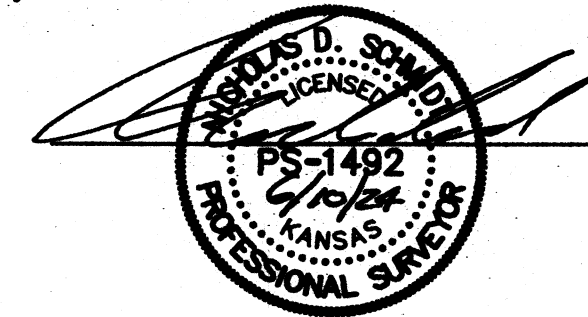

| | | | |
|---------------------------|------------------|---|-----------|
| Prepared For: | | Description: | |
| MIDWEST LAND GROUP | | A PORTION OF THE SE 1/4 SECTION 6, T17S, R1W MCPHERSON COUNTY, KANSAS | |
| Prepared By: | | Garber Surveying Service, P.A. | |
| GSS HUTCHINSON | | BRANCH OFFICES: | |
| 2908 North Plum St. 67502 | | MANHATTAN Ph. 785-320-4810 | |
| Ph. 620-665-7032 | | MCPHERSON Ph. 620-241-4441 | |
| (Main Office) | | NEWTON Ph. 316-283-5053 | |
| | | SALINA Ph. 785-484-6302 | |
| | | WICHITA Ph. 316-260-9933 | |
| Drawn By: KJC | Scale: 1"=100' | Date of Field Work: May 29, 2024 | Job No: |
| Checked By: NDS | Date: 06/10/2024 | Sheet 1 of 1 Sheet(s) | G2024-416 |