

CL CHESTNUT STREET CL

30'

30'

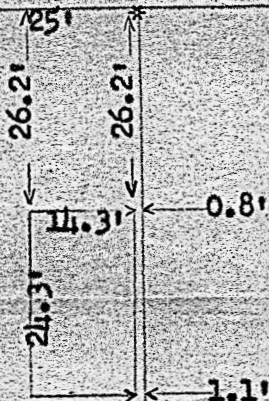

SOUTH

e of Kansas,
ty of McPherson, ss.

Francis D. Wagner, County
Recorder of McPherson County,
Kansas, do hereby certify

I did on the 3rd day of
April, 1950, survey the House
and Lot on the South Half of
Section 30, Block 2, ~~Walnut~~ WALDEN
Addition to the City of Mc-
Pherson, and that the ac-
companying plat is a true
and correct copy of said survey.

LOT 30

25'