

PROPERTY SURVEY

LOT 16, Block C, Sunbird Lake Estates II, McPherson, McPherson County, Kansas  
a.k.a. 1303 Mallard Drive

Parcel 1: Lot 16 except the east twenty-one (21) feet thereof, Block C, Sunbird Lake Estates II Addition to the City of McPherson, McPherson County, Kansas containing 12,600 sq. ft. more or less.

Parcel 2: The East 21.00 feet of Lot 16, Block C, Sunbird Lake Estates II Addition to the City of McPherson, McPherson County, Kansas containing 3,150 sq. ft. more or less.

I, MELANIE L. THROWER, REGISTERED LAND SURVEYOR IN THE STATE OF KANSAS DO HEREBY CERTIFY THAT UNDER MY DIRECT SUPERVISION A SURVEY WAS MADE OF THE ABOVE DESCRIBED PROPERTY AND THE PROPERTY IS A TRUE EXHIBIT OF SAID SURVEY AS FAR AS IT IS KNOWN TO ME.

SIGNED THIS 1 DAY NOVEMBER, 1999.

*Melanie L. Thrower*  
MELANIE L. THROWER RLS

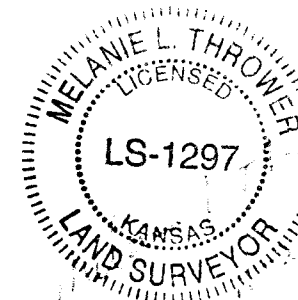

LOT SPLIT SURVEY

Melanie L. Thrower, P.E., L.S.  
P.O. Box 662  
McPherson, Kansas  
316-241-0950 FAX 316-241-5086