

SURVEYOR'S NOTES:

- Survey was made as per client request and no title work has been provided to the surveyor; therefore, the number and extent of easements and/or rights-of-way of record affecting said property has not been verified by this Survey.
- All measurements are in US Survey Feet.
- Origin of found monuments uncertain unless noted.

- LEGEND**
- - Survey Monument Found
 - - 5/8" x 24" Iron Rebar Set w/GSS CLS 52 Cap
 - ✕ - Set "X" Cut in Concrete
 - (M) - Measured
 - (PL) - Platted
 - P.O.B. - Point of Beginning

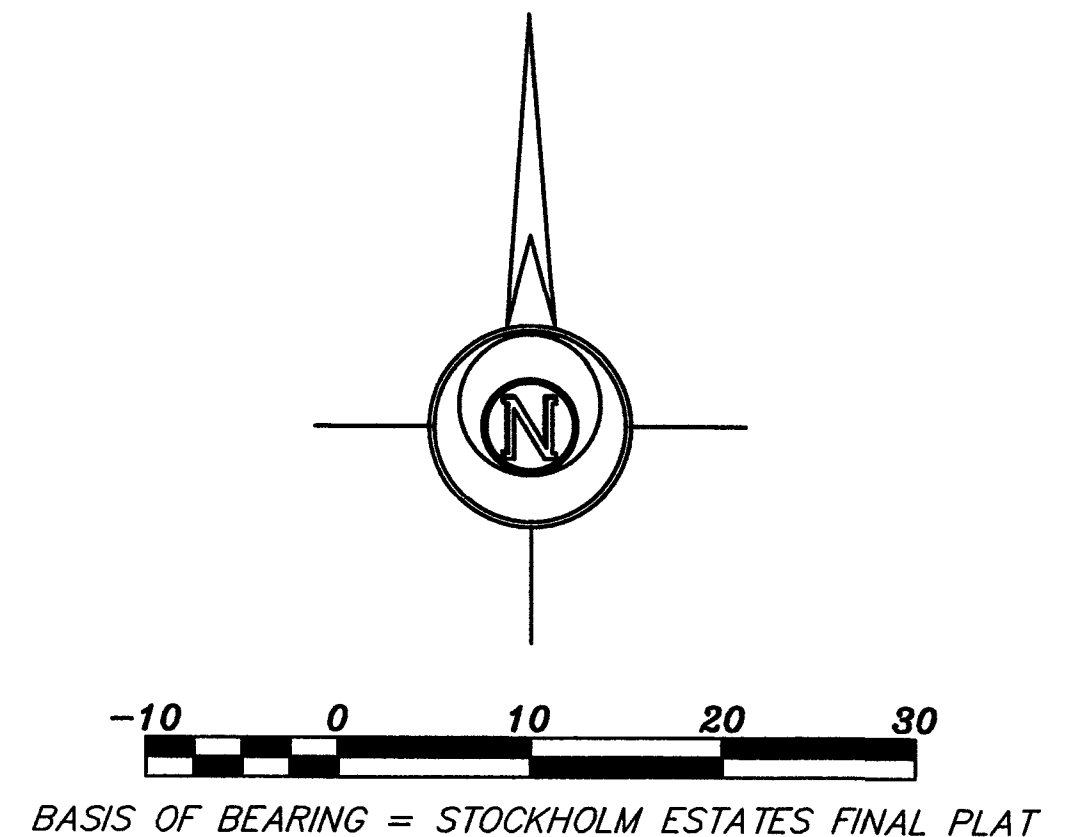

DESCRIPTIONS:

TRACT 1

A portion Lot 10, Block 1, Stockholm Estates, City of Lindsborg, McPherson County, Kansas, described as follows by Nicholas D. Schmidt, PS #1492, this 25th day of January, 2024:

Beginning at the Southwest corner of said Lot 10; thence on a Stockholm Estates Final Plat bearing of North 00°55'33" West on the West line of said Lot 10 a distance of 110.00 feet to the Northwest corner of said Lot 10; thence South 89°55'57" East on the North line of said Lot 10 a distance of 32.95 feet to the intersection with the extension of the centerline alignment of the duplex party wall; South 00°04'03" West on said centerline a distance of 109.98 feet to the South line of said Lot 10; thence North 89°55'57" West on said South line a distance of 31.05 feet to the point of beginning.

Containing **3,520 Square Feet** and subject to any easements or restrictions of record.

TRACT 2

A portion Lot 10, Block 1, Stockholm Estates, City of Lindsborg, McPherson County, Kansas, described as follows by Nicholas D. Schmidt, PS #1492, this 25th day of January, 2024:

Beginning at the Southeast corner of said Lot 10; thence on a Stockholm Estates Final Plat bearing of North 89°55'57" West on the South line of said Lot 10 a distance of 32.95 feet to the intersection with the extension of the centerline alignment of the duplex party wall; thence North 00°04'03" East on said centerline a distance of 109.98 feet to the North line of said Lot 10; thence South 89°55'57" East on said North line a distance of 31.05 feet to the Northeast corner of said Lot 10; thence South 00°55'33" East on the East line of said Lot 10 a distance of 110.00 feet to the point of beginning.

Containing **3,520 Square Feet** and subject to any easements or restrictions of record.

SURVEYOR'S CERTIFICATE:

I hereby certify this plat to be a true, correct and complete representation of the property described hereon, as surveyed under my supervision, this 25th day of January, 2024.

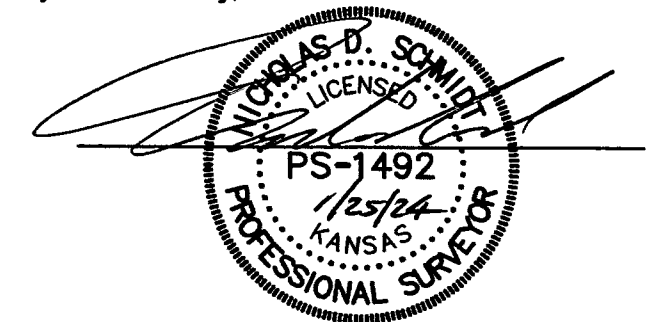

Prepared For: COLDWELL BANKER		Description: LOT 10, BLOCK 1 STOCKHOLM ESTATES LINDSBORG, KANSAS	
Prepared By: GSS HUTCHINSON 2908 North Plum St. 67502 Ph. 620-665-7032 (Main Office)		Garber Surveying Service, P.A. BRANCH OFFICES: MCPHERSON Ph. 620-241-4441 SALINA Ph. 785-404-6302 MANHATTAN Ph. 785-320-4810 NEWTON Ph. 316-283-5053 WICHITA Ph. 316-260-9933	
Drawn By: KDZ	Scale: 1"=10'	Date of Field Work: January 15, 2024	Job No: G2024-33
Checked By: NDS	Date: 01/25/2024	Sheet 1 of 1 Sheet(s)	