

A SURVEY OF LOT 3, AND THE W 1/2 OF LOT 2,
ROSTINE'S ADDITION, MC PHERSON, KANSAS

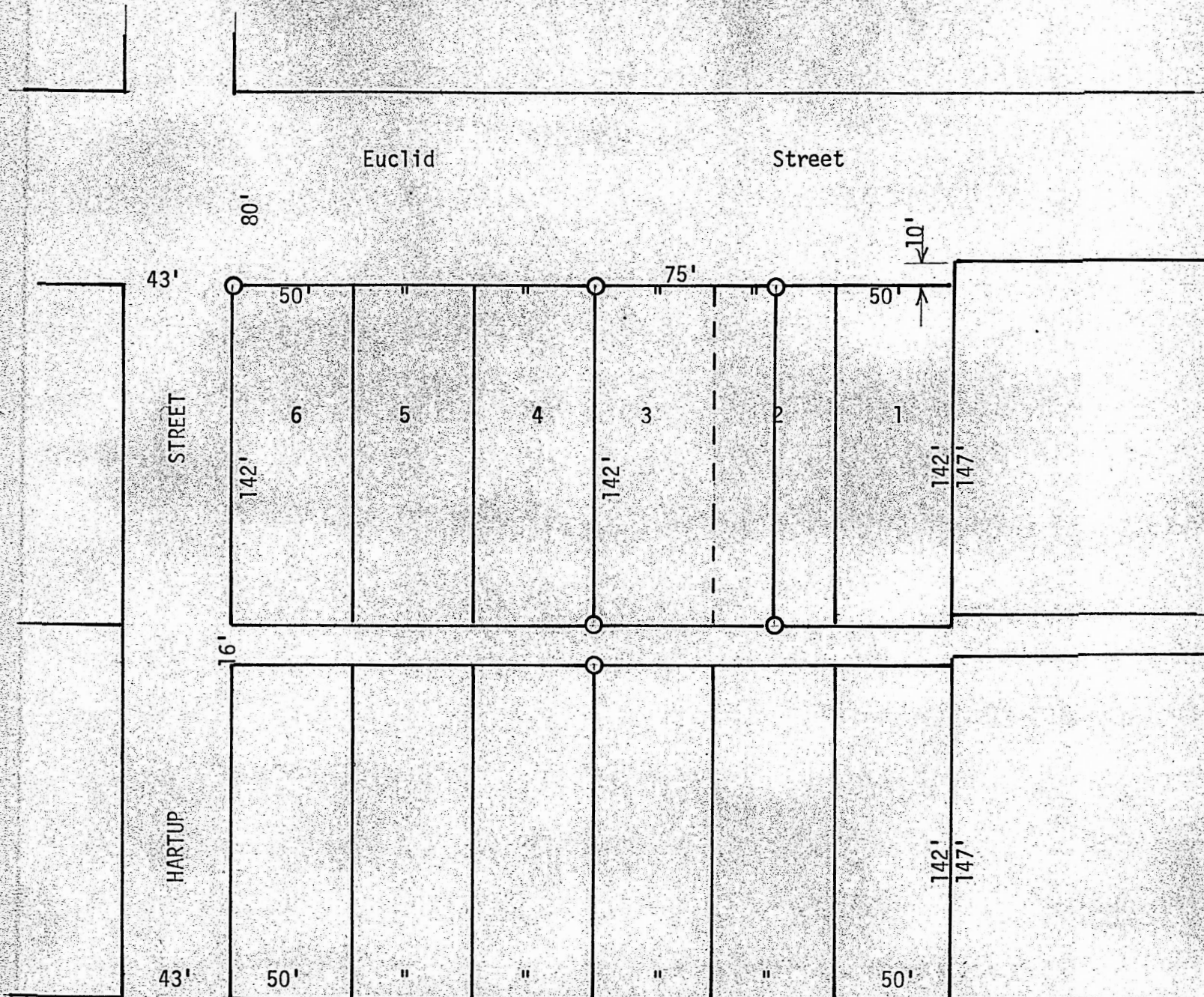

⊙ Pins Found or Set This Survey

State of Kansas)
County of McPherson) SS

I, F. R. Rankin, County Engineer of McPherson County, Kansas, do hereby certify that under my supervision a survey was made of Lot 3, and the West Half of Lot 2, Rostine's Addition to the City of McPherson, Kansas. The above plat is a true exhibit of said survey as far as it is known to me.

Survey called for by Dean Nelson
Signed this 7 day of March, 1972

F. R. Rankin

F. R. Rankin, P. E.
County Engineer
McPherson, Kansas

