

Lot 5, Washington Street, Pearson's Addition, Lindsborg, Kansas.

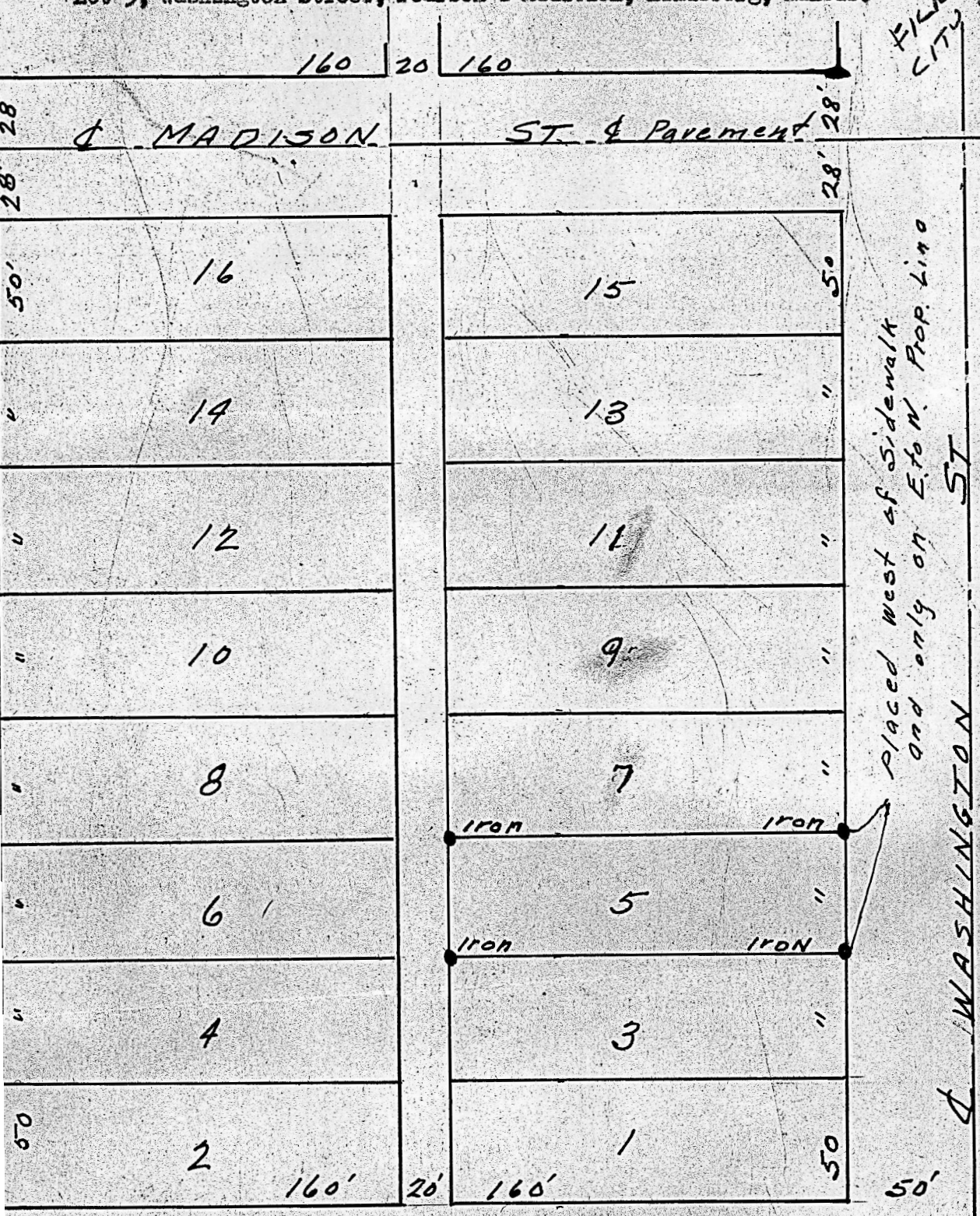

State of Kansas, County of McPherson, ss.

I, G.D. Johnson, Licensed Civil Engineer of the State of Kansas, do hereby certify that I did on the 1st. Day of November, 1954 survey Lot 5, Washibgton Street, Pearson's Addition to the City of Linsborg, Kansas and that accompanying plat is a true exhibit of said survey.

*G.D. Johnson*

MICROFILM